



CELEBRATING 180 YEARS
SHELDON BOSLEY KNIGHT
FOR SALE
01386 277277

find us first on
wearethemarket.co.uk

Evesham Road, Upper Moor, WR10 2JR

SHELDON BOSLEY KNIGHT
LAND AND PROPERTY PROFESSIONALS

Property Description

Pensham Place is one of two brand new detached family homes offering spacious accommodation built to a high specification by local developer Juliff Homes, situated in Upper Moor midway between Lower Moor and Wyre Piddle. The location provides easy access to Pershore (approximately 2 miles) & Evesham (approximately 6 miles), national road and rail networks.

The accommodation in brief comprises:

- Reception Hall
- Living Room
- Dining Room
- Kitchen Breakfast Room (with Shaker Style Kitchens & Bosch Appliances)
- Utility Room
- Cloakroom
- Four Bedrooms, Two Ensuite
- Family Bathroom

Outside, the property will have lawned gardens to the front & rear & aspects, the rear enjoying a high degree of privacy and a southerly aspect. In addition, there is a large (2 1/2 times width) detached Double Garage with storage room over, power & light).

Services: All mains services are connected Gas Central Heating, Double Glazing & Solar Panels are installed.

Agents Note: Internal layouts may vary during construction.





Key Features

- Built by local developer Juliff Homes
- 10 year LABC Guarantee
- Spacious, high specification family home
- Private gardens with southerly rear aspect
- Large detached Double Garage
- Popular & sought after hamlet location
- Viewing highly recommended

**Offers Over
£575,000**

EPC Rating - A

Tenure - Freehold

Council Tax Band - F

Local Authority -

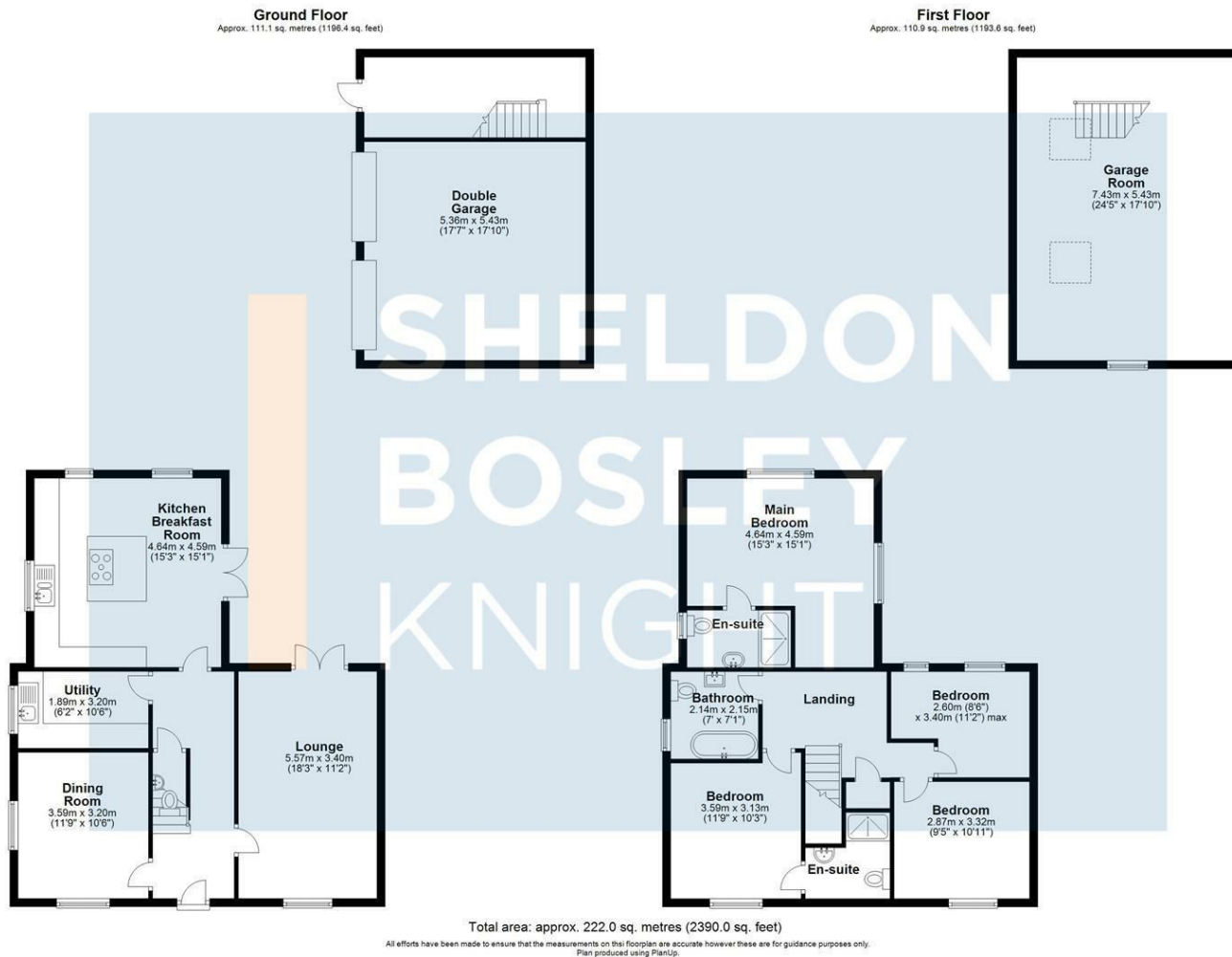

We routinely refer clients to both our recommended Legal Firm and a panel of Financial Services Providers. It is your decision whether you choose to deal with these companies. In making that decision, you should know that we receive a referral fee