



Lansdowne Street, Worcester, WR1 1QD

**SHELDON
BOSLEY
KNIGHT** LAND AND
PROPERTY
PROFESSIONALS

Property Description

*** AVAILABLE NOW **** An impeccably renovated, 2 bedroom period terraced house set within the fringe of Worcester City Centre. Providing easy access to the city centre, local amenities and rail links.

This immaculately presented property offers a well proportioned living space, good size garden and a bright, airy finish throughout.

The accommodation in brief comprises;

Front door into living room, through to brand new modern fitted kitchen with cooker/hob, downstairs bathroom with bath, shower over bath, WC and basin, door leading to low maintenance rear garden, predominately laid to lawn with shrub borders and small patio area.

Stairs elevating to the first floor where you will find two generous size double bedrooms, bedroom one further benefitting from built in storage cupboard.

On street parking is offered on a permit basis, to be organised through Worcester City Council. Charges for this are not included in the rental amount, and full details can be obtained through the local council.

The property has been completely transformed, including new décor, flooring, kitchen, bathroom and front door. A fantastic opportunity, not too be missed!

The basement offered with the property is to be used at the tenants own risk, we do not advise storing valuable/sentimental items.

The property is offered Unfurnished
Initial 12 Month Tenancy
Council Tax Band B
EPC D

****PLEASE NOTE, VIDEO IS FOR VISUALISATION PURPOSES AND IS NOT TO REPLACE AN IN-PERSON VIEWING****





Key Features

- AVAILABLE NOW
- Worcester
- 2 Bedrooms
- Terraced House
- Renovated Property
- On Street Parking
- Rear Garden
- Energy Rating D
- Council Tax Band B
- Initial 12 Month Tenancy

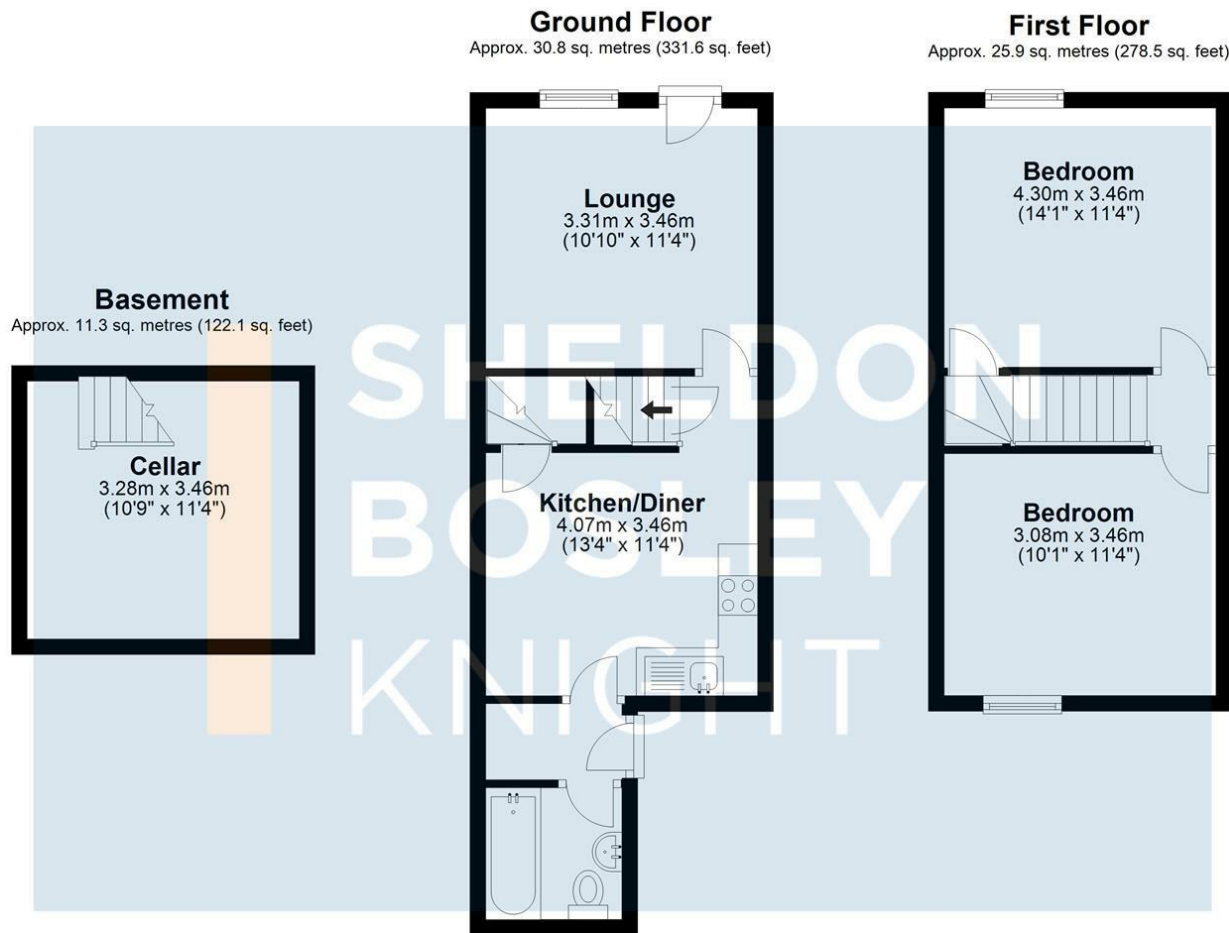

Total area: approx. 68.0 sq. metres (732.3 sq. feet)

All efforts have been made to ensure that the measurements on this floor plan are accurate however these are for guidance purposes only.
Plan produced using PlanUp.

£980 PCM