



Evesham Road, Upper Moor, WR10 2JR

**SHELDON
BOSLEY
KNIGHT** LAND AND
PROPERTY
PROFESSIONALS

Property Description

*** AVAILABLE NOW, BRAND NEW 'A' RATED DETACHED HOUSE ***

Introducing the impeccably finished PENSHAM PLACE, an executive 4 bedroom, 3 bathroom detached house, nestled in the small village of Upper Moor, near Pershore. Boasting graceful open field views and comfortable living space.

This not to be missed accommodation comprises of;

Front fore lawn, door leading into entrance hall, downstairs cloakroom WC, good size dining room, light, airy living room with patio doors leading to the rear garden, a striking kitchen complete with integrated fridge/freezer & shaker style units - further benefitting from a generous island housing the hob with additional cooking space. Double patio doors leading into the well proportioned lawned rear garden, with a southerly aspect. From the kitchen there is a utility room with space for washing machine, tumble drier and ample unit/worktop space.

On the first floor there are 4 bedrooms, 2 double bedrooms with the added luxury of ensuite shower rooms to both, a further 2 single bedrooms and a modern family bathroom finished to a spectacular standard.

If that wasn't enough, the property also comes with a DOUBLE detached garage to the rear of the property, with electric roller doors and stairs leading to an storage/office space above, with power and light. Outside there is also an EV charging point.

The property is offered unfurnished - fridge/freezer & dishwasher included
Council Tax Band - Awaiting Banding
Energy Rating A
Initial 12 Month Tenancy





Key Features

- AVAILABLE NOW - BRAND NEW
- Upper Moor, Pershore
- 4 Bedrooms (2 En-Suite)
- Detached
- Unfurnished
- Generous Rear Garden
- Double Detached Garage With power & Storage Space
- Energy Rating A
- Council Tax Band - Awaiting Band, New Build
- Initial 12 Month Tenancy

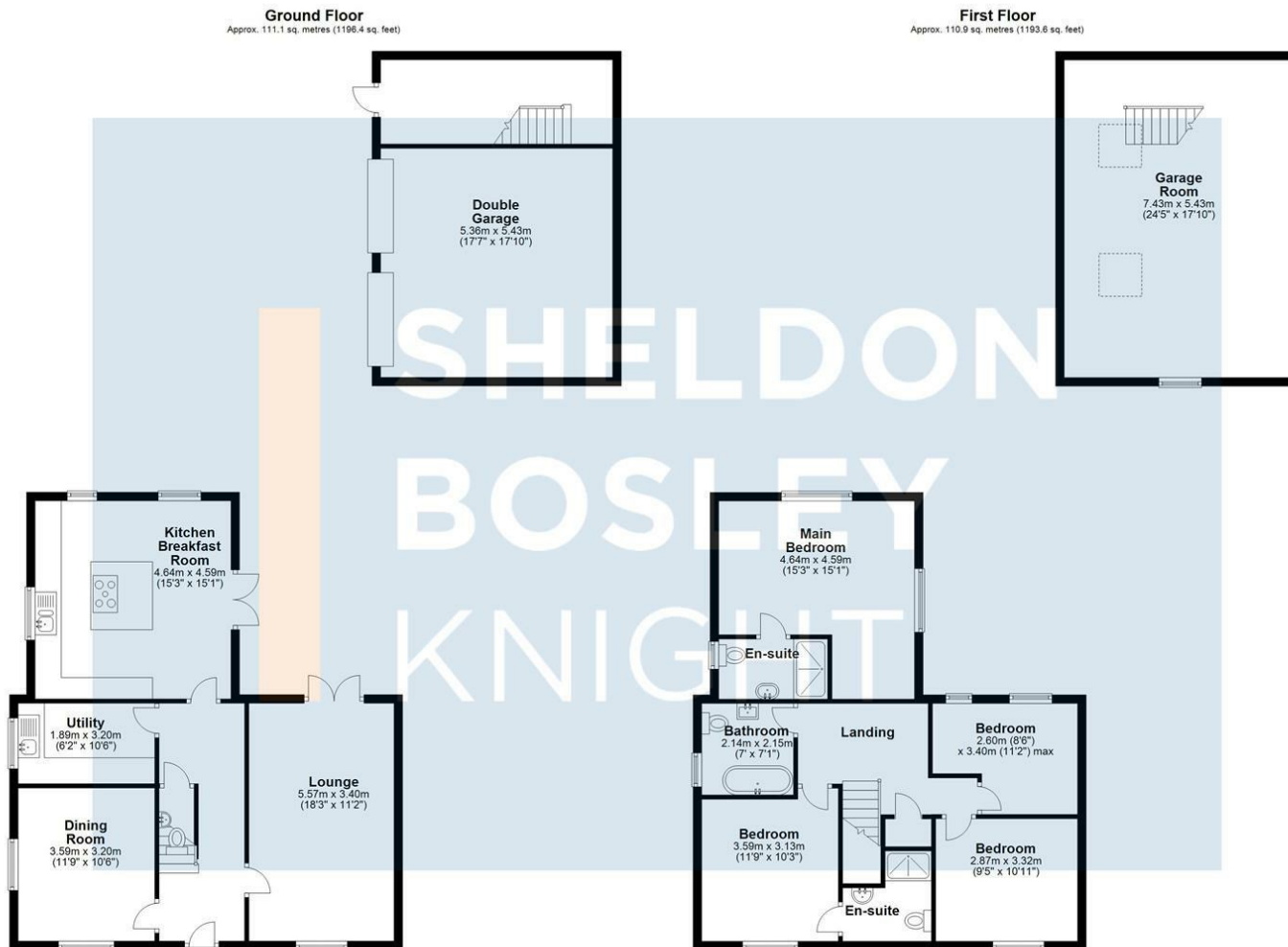

Total area: approx. 222.0 sq. metres (2390.0 sq. feet)

All efforts have been made to ensure that the measurements on this floorplan are accurate however these are for guidance purposes only.
Plan produced using PlanUp.

£2,500 PCM