



• E<sup>th</sup>. 2019 •  
**MUSTARD  
WHARF**  

---

**LEEDS**

---



## HELLO LEEDS!

---

Mustard Wharf brings a happier and easier way to rent to this amazing city. 1, 2 and 3 bedroom boutique apartments and a whole range of exceptional amenities are just the start. This is a dynamic new community just minutes' walk from the station - and you're invited to be part of it.



[INTRODUCTION](#)

[SITE PLAN](#)

[GALLERY](#)



# MUSTARD WHARF

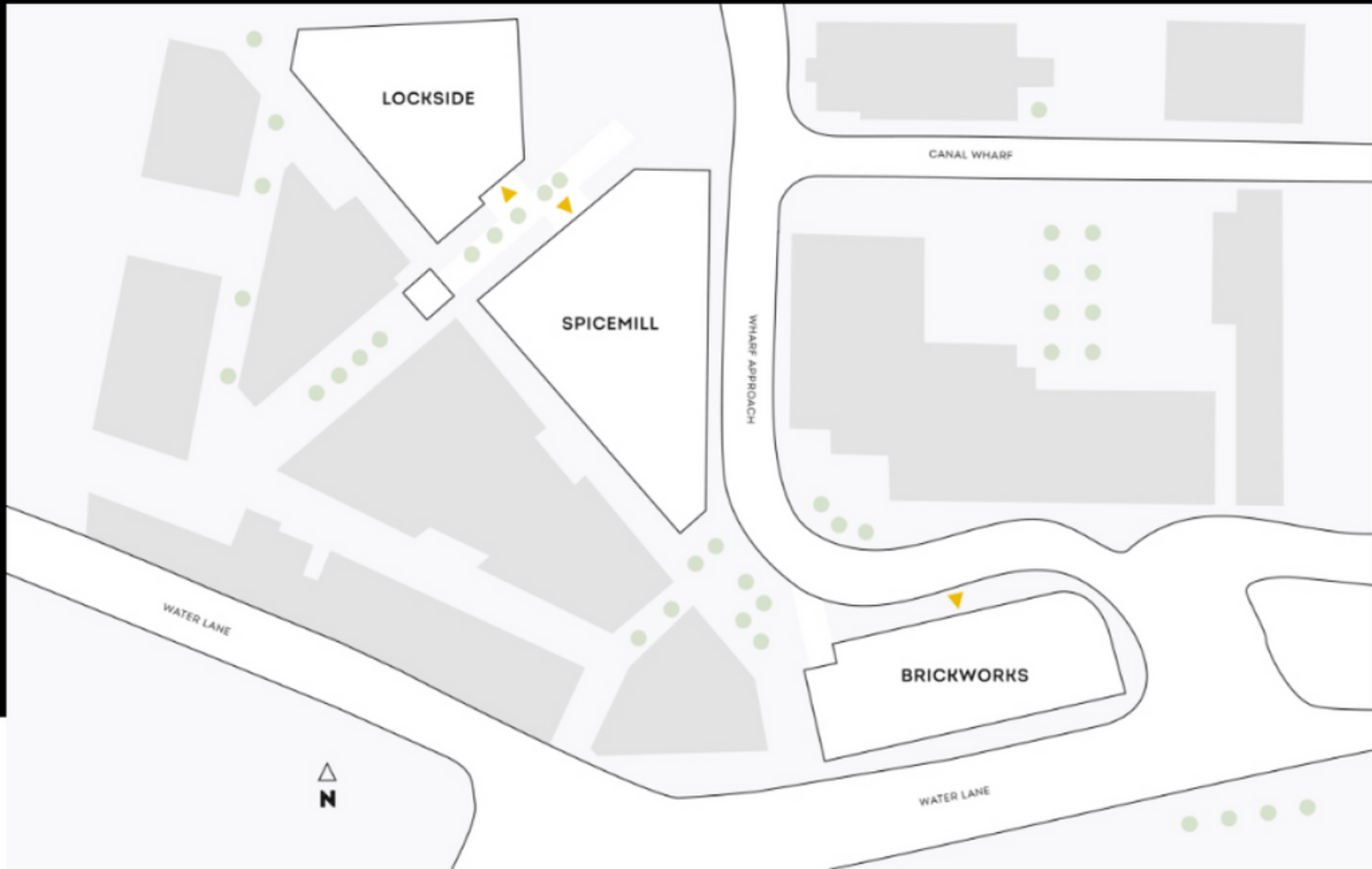

INTRODUCTION

**SITE PLAN**

GALLERY



# MUSTARD WHARF



Canal-side view



INTRODUCTION

SITE PLAN

GALLERY





The Piazza



The Clubhouse

## THE APARTMENTS

---

Our beautifully crafted and styled 1, 2 and 3 bedroom apartments for rent have a modern-industrial yet cosy feel. They feature high-quality appliances, fine finishes and exposed concrete detailing. Some even boast balconies overlooking the canal.



OUR HOMES

1 BED

2 BED

3 BED



# 1 BED

## 1 BEDROOM APARTMENTS SUMMARY SHEET

Size	Avg. 469 sq ft
Rent	From £990 pcm
Deposit	One month's rent
Tenancy Length	6 months - 5 years
Floors	1, 2, 3, 4, 5 & 6



### WHAT'S INCLUDED IN YOUR RENT



WORK AREA



ON-SITE TEAM



SUPER FAST  
BROADBAND



PET FRIENDLY  
APARTMENTS\*



HI-TECH GYM\*\*



ROOF TERRACES  
& COURTYARDS



CLUBHOUSE  
& LOUNGE



PRIVATE DINING  
ROOMS

### TYPICAL 1 BEDROOM FLOOR PLAN









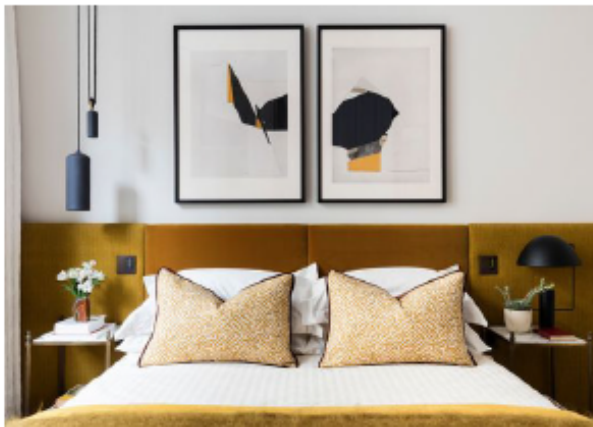

# 2 BED

## 2 BEDROOM APARTMENTS SUMMARY SHEET

Size	From XXX-XXXX sq ft
Rent	From £1,615 pcm
Deposit	One month's rent
Tenancy Length	6 months - 5 years
Floors	G, 1, 2, 3, 4, 8
Building	Spicemills



### WHAT'S INCLUDED IN YOUR RENT

- |   |   |   |   |
|---|---|---|---|
|   |   |   |   |
| FREEDOM TO DECORATE   | ON-SITE TEAM  | SUPER FAST BROADBAND  | PET FRIENDLY APARTMENTS*  |
|  |  |  |  |
| HI-TECH GYM   | ROOF TERRACES & COURTYARDS  | CLUBHOUSE & LOUNGE  | PRIVATE DINING ROOMS  |

### TYPICAL 2 BEDROOM FLOOR PLAN



\*Some additional fees apply

# 3 BED

## 3 BEDROOM APARTMENTS SUMMARY SHEET

Size	Avg. 969 sq ft
Rent	From £1,945 pcm
Deposit	One month's rent
Tenancy Length	6 months - 5 years
Floors	4, 5 & 6



### WHAT'S INCLUDED IN YOUR RENT



WORK AREA



ON-SITE TEAM



SUPER FAST  
BROADBAND



PET FRIENDLY  
APARTMENTS\*



HI-TECH GYM\*\*



ROOF TERRACES  
& COURTYARDS



CLUBHOUSE  
& LOUNGE



PRIVATE DINING  
ROOMS

### TYPICAL 3 BEDROOM FLOOR PLAN



## PERKS & PLEASURES

---

It's the thoughtfully crafted social spaces, extraordinary service and helpful extras that make Mustard Wharf more than just a home. All complimentary, of course.



## PERKS & PLEASURES

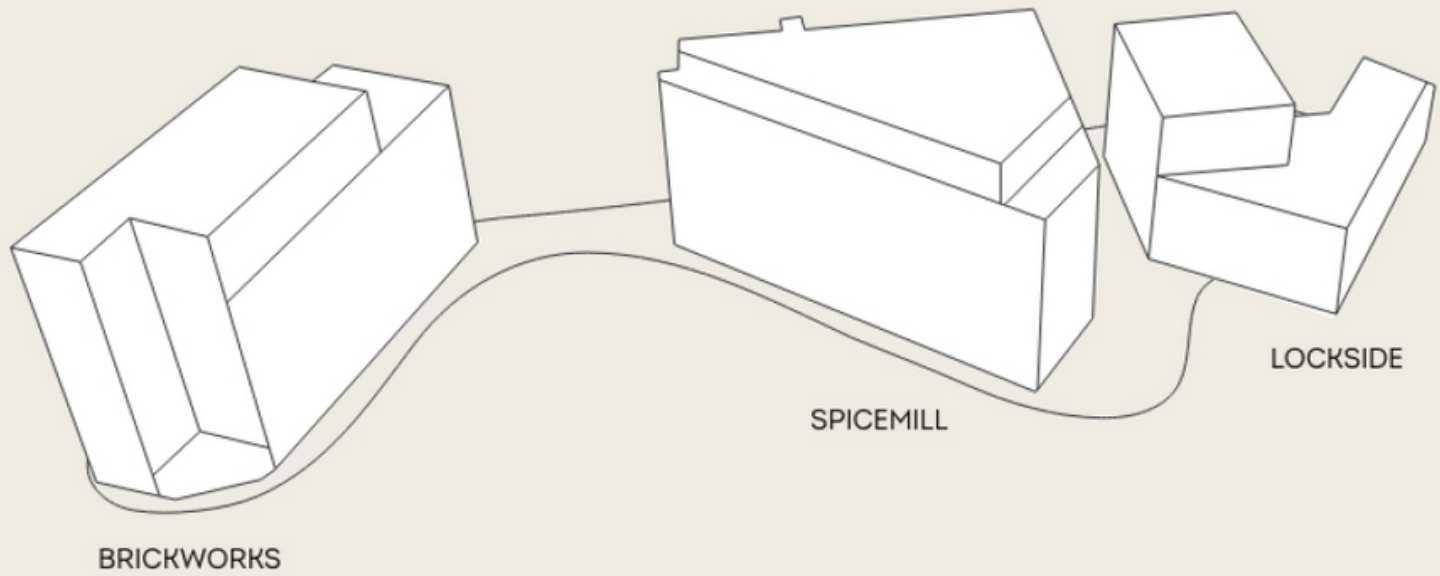

## PERKS & PLEASURES

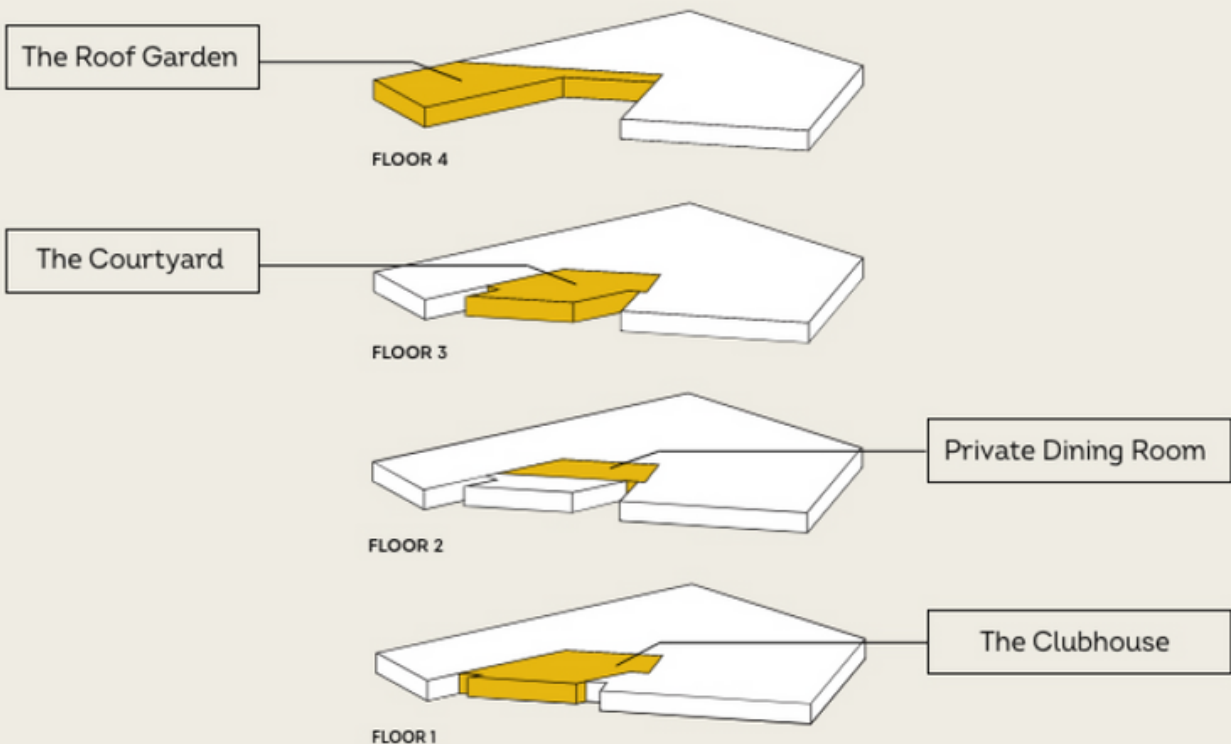

← BACK

LOCKSIDE

## The Roof Garden

---

Soak up the striking canal views (and hopefully sunshine). Our green roof-top gardens feature plenty of outside spaces to socialise - or lounge with a good book.



PERKS & PLEASURES

YOUR LANDLORD



## Private dining room

---

Throw a grand dinner party in contemporary surroundings. Our fully equipped kitchens and generous dining tables make entertaining friends a delight.

[BACK TO MAP](#) 



[PERKS & PLEASURES](#)

[YOUR LANDLORD](#)



## The Clubhouse

A stylish space with soaring ceilings and cosy corners for meeting friends - and making new ones. Chat, drink, revel or pop in your headphones and get down to some work.



[BACK TO MAP](#)



[PERKS & PLEASURES](#)

[YOUR LANDLORD](#)





## PERKS & PLEASURES

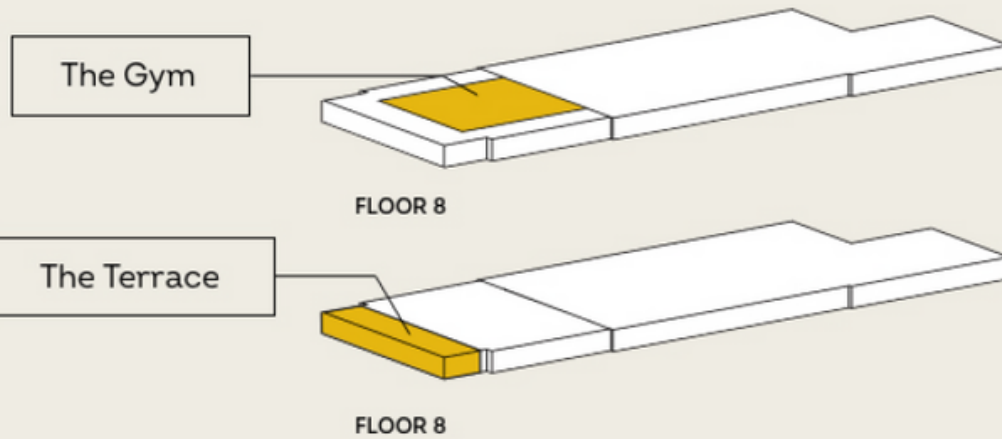

← BACK

BRICKWORKS

## The Gym

---

Roll out of bed and revitalise. Our state-of-the-art gym combines innovative equipment with a relaxed vibe to make yoga lovers, heavy lifters, gym bunnies - and everyone in between - happy.



[BACK TO MAP](#)



## The Terrace

---

Soak up the striking canal views (and hopefully sunshine). Our green roof-top gardens feature plenty of outside spaces to socialise - or lounge with a good book.

[BACK TO MAP](#)[PERKS & PLEASURES](#)[YOUR LANDLORD](#)



## SUPERIOR RENTING

Rent with the respect and freedom you deserve in your own home. Expect flexible contracts- from 6 months to 5 years - and the satisfaction of not paying a penny in letting fees.



## PETS ALLOWED

It's a little out of the ordinary but we're pet friendly. So you're more than welcome to bring your pets. A home isn't always a home without them by your side.



## ON-SITE TEAM & CONCIERGE

Relax knowing our onsite team will help you at every step. From taking in parcels and coordinating maintenance and repairs, to recommending new places and organising social events.



## FREEDOM TO DECORATE

We can't stress enough that this is your home. So enjoy the freedom to paint the walls, put up pictures and make it your own. Its style should be as unique as you.



## SUPER-FAST BROADBAND

Not just free broadband - but free high-speed broadband, all set up and ready to go in every room and social area. Because few things in life are more frustrating than a slow connection.

## YOUR LANDLORD

---

Mustard Wharf is the creation of Legal & General - one of an exciting collection of destinations across the UK build specifically for rent. It's our mission to make renting fairer, easier and infinitely more pleasurable.



## LOCAL AREA

---

South Bank is one of Europe's most ambitious regeneration projects. It has become a distinctive destination in itself, just 10 minutes from the station – and the best is yet to come.



# MUSTARD WHARF



## HEALTH AND FITNESS

- 1 **Mustard North**  
Marshall Court, Marshall St, Leeds LS1 9YP
- 2 **Anytime Fitness**  
Bridgwater Place, 1 Water Ln, Leeds LS1 5QS
- 3 **Farm**  
Leeds Ct, Leeds LS1 5JJ
- 4 **Pure Gym City Centre South**  
Clash Hall St, Opposite Corn Exchange, Leeds LS1 2HD

## RETAIL

- 1 **Leeds Trinity**  
27 Albion St, Leeds LS1 5AT
- 2 **Victoria Quarter**  
44 Victoria Gate, George Street, Leeds, LS2 7AU
- 3 **Marrion Centre**  
Marrion Way, Leeds LS2 8NG
- 4 **Leeds Market**  
Vicar Lane, Leeds City Centre LS2 7HY

## FUTURE

- 1 **Climate innovation district phase 5**  
5 Clarence Rd, Leeds LS10 1EE  
New low carbon family homes, North Bank of the River Aire
- 2 **Visitor city park**  
Largest brown-field site in Leeds city centre poised for the biggest regeneration opportunities in any UK city centre.

## PUB AND BARS

- 1 **The Midnight Bell**  
101 Water Ln, Leeds LS1 5QN
- 2 **The Cree Keys**  
107 Water Ln, Leeds LS1 5WD
- 3 **Foundry Wine Bar**  
15a Mill St, Leeds LS1 5WH
- 4 **Northern Monk Brewery**  
Marshall's Mill, The Old Flax Store, Marshall St, Leeds LS1 9D
- 5 **The Grove Inn**  
Back Row, Leeds LS1 5PL

## FOOD MARKETS

- 1 **Leeds Kirkgate Market**  
Vicar Lane, Leeds City Centre LS2 7HY

- 2 **Tesco Express**  
Bridgwater Place, 2a Water Ln, Leeds LS1 5RU
- 3 **Sainsbury's Local**  
City Station, New Station St, Leeds LS1 4DT
- 4 **The Co-operative Food**  
Unit 3 Sovereign St, Svington, Leeds LS1 4AG

## RESTAURANTS AND CAFES

- 1 **David Street Cafi**  
109 Water Ln, Leeds LS1 5WD
- 2 **Out of the Woods**  
113 Water Ln, Leeds LS1 5WD
- 3 **Taste**  
Butcher St, Yard, Leeds LS1 5WH
- 4 **Water Lane Boat House**  
Canal Wharf, Leeds LS1 5PS
- 5 **Candle Bar**  
Candle House, Leeds LS1 4GJ
- 6 **Seaside Folk**  
10 Wellington Pl, Leeds LS1 4JP
- 7 **Grainery Wharf**  
Grainery Wharf, Leeds LS1 4GL

## CULTURE

- 1 **Holbeck Underground Ballroom**  
Working Men's Club, The Holbeck, Leeds LS1 9QX
- 2 **The Tally**  
Harrier Rd, Leeds LS10 5JQ
- 3 **Round Foundry (Architectural significance)**  
Foundry St, Leeds LS1 5QP
- 4 **Texas Works**  
2 Ginkle Rd, Leeds LS1 5SQ
- 5 **Candle House**  
1 Wharf Approach, Leeds LS1 4GJ
- 6 **Watermann Place**  
3 Wharf Approach, Leeds LS1 4GN
- 7 **Station South entrance**  
New Station St, Leeds LS1 4DY
- 8 **Marshall's Mill**  
The Old Flax Store, Marshall St, Leeds LS1 9D
- 9 **Temple Works**  
17 Marshall St, Leeds LS1 9EH
- 10 **The Royal Armouries**  
Armouries Dr, Leeds LS10 1LT
- 11 **Leeds Discovery Centre**  
Cerulea Rd, Leeds LS10 1LB



LOCAL AREA

MAP

GALLERY



# MUSTARD WHARF



LOCAL AREA

MAP

GALLERY





GET IN TOUCH

Call us 01235 567890

---

Email [sales.mustardwharf.co.uk](mailto:sales.mustardwharf.co.uk)

---

Follow us @mustard.wharf  

---

Find us Mustard Wharf, Leeds, XXX XXX

---

Search for [www.mustardwharf.com](http://www.mustardwharf.com)

---

