



PLUMP HILL

Guide price **£450,000**



ARCHER & Co

MUTLERS ROW

Plump Hill, Mitcheldean, Gloucestershire GL17 0EY



Character detached three-bedroom home
In need of updating with great potential
Peaceful setting with local amenities nearby

Set in the tranquil heart of Gloucestershire, this detached home on Mutlers Row is full of character and potential. While the property would benefit from internal renovation, it offers a solid foundation and a scenic backdrop that makes it a truly promising opportunity. The house features three bright bedrooms, two bathrooms, and a spacious living area that captures natural light beautifully. The kitchen is functional and equipped with essential fixtures, while the bathrooms are practical in layout.

Outside, a wooden deck or patio opens to a well-established garden surrounded by lush greenery perfect for outdoor enjoyment and entertaining. The views of the surrounding hills and countryside enhance the peaceful charm of the home, making it ideal for those seeking a project in a quiet yet accessible location.

The property offers a well-proportioned and versatile interior layout, with plenty of scope for personalisation. While the home is in need of updating, it provides a solid foundation with generous living spaces throughout. The main living area is bright and welcoming, enhanced by large windows that allow natural light to fill the room.

There are three good-sized bedrooms, each offering pleasant views and flexible use, whether for family living, guests, or a home office. The kitchen includes fitted cabinetry and a stove, with a layout that could easily be adapted to suit modern needs.

The bathrooms are functional in design and offer potential for reconfiguration or enhancement. Additional built-in shelving in some rooms adds to the practicality of the space.

Altogether, the home presents a fantastic opportunity to create a comfortable and stylish living environment in a beautiful rural setting.

Guide price
£450,000



KEY FEATURES

- Three-bedroom detached house
- Spacious and light-filled interiors with flexible living accommodation
- In need of updating, offering excellent potential
- Practical kitchen layout with garden views
- Generous outdoor space with a wooden deck/patio



STEP OUTSIDE

The outdoor space is a standout feature, amounting to just over half an acre including a meadow directly opposite the property. The gardens offer a wooden deck or patio that flows into a private, green garden. Landscaped touches blend naturally with the environment, and the setting is perfect for alfresco dining, entertaining, or simply enjoying the peaceful surroundings.

With rolling hills and mature trees in view, the outdoor area brings a strong sense of connection to nature. Multiple seating spots offer flexibility for relaxation, making the garden a year-round asset. Whether you're a gardening enthusiast or simply value your own slice of the countryside, this space complements the home beautifully and adds to its lasting appeal.

Agents note: Access to the property is via a track owned by the Forestry Commission.



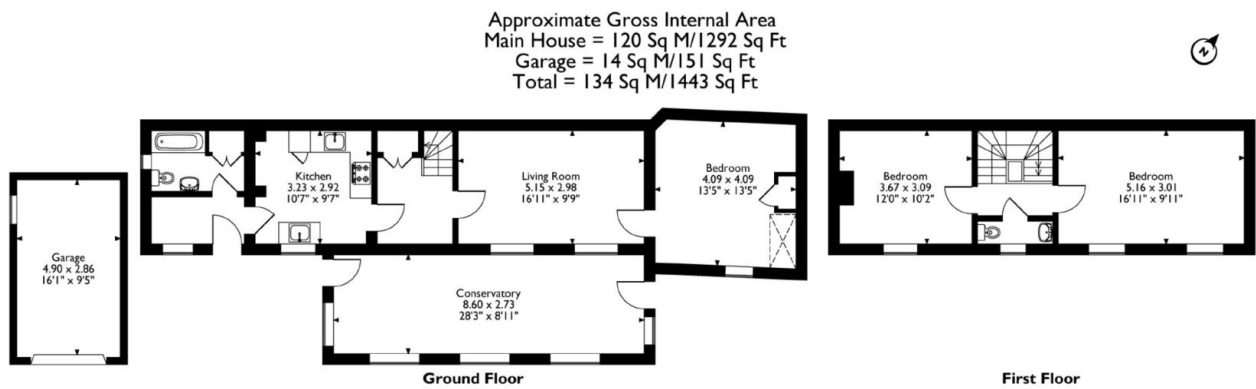

Please note that the location of doors, windows and other items are approximate and this floorplan is to be used for illustrative purposes only. Unauthorized reproduction is prohibited.

DIRECTIONS

///overnight.ambient.villager



INFORMATION

Postcode: GL17 0EY
Tenure: Freehold
Tax Band: C
Heating: Oil
Drainage: Private
EPC: D

Energy Efficiency Rating		Current	Potential
Very energy efficient - lower running costs			
A (92-100)			96
B (81-91)			
C (69-80)			
D (55-68)		59	
E (39-54)			
F (21-38)			
G (1-10)			
Not energy efficient - higher running costs			
England & Wales		EU Directive 2002/91/EC	

52 Broad Street, Ross-on-Wye, HR9 7DY
01594 715888
forest@archerandco.com
www.archerandco.com



All measurements are approximate and quoted in imperial with metric equivalents and for general guidance only and whilst every attempt has been made to ensure accuracy, they must not be relied on. The fixtures, fittings and appliances referred to have not been tested and therefore no guarantee can be given that they are in working order. Floorplans and photographs are reproduced for general information and it must not be inferred that any item shown is included with the property.