



PUTTERILLS

est. 1992

**£1,250 Per  
Calendar Month**

Hitchin, SG5 2SY



## PROPERTY SUMMARY

Located in Milestone Road in Hitchin, this delightful first floor apartment offers a perfect blend of comfort and convenience. With two well-proportioned bedrooms, this residence is ideal for individuals and couples.

The apartment features a spacious reception room. Natural light floods the area from the balcony, creating a warm and airy atmosphere that enhances the overall appeal of the home. The layout is thoughtfully designed, ensuring that every corner is utilised effectively.

The property features a modern bathroom and a generously sized kitchen, offering practicality and scope for culinary creativity.

Located in Hitchin, residents will enjoy easy access to local shops, cafes, and parks, making it a wonderful place to live. The area is well-connected, with transport links that facilitate travel to nearby towns and cities, ensuring that you are never far from the action.

2



1



1













## Ground Floor

Approx. 73.3 sq. metres (788.6 sq. feet)

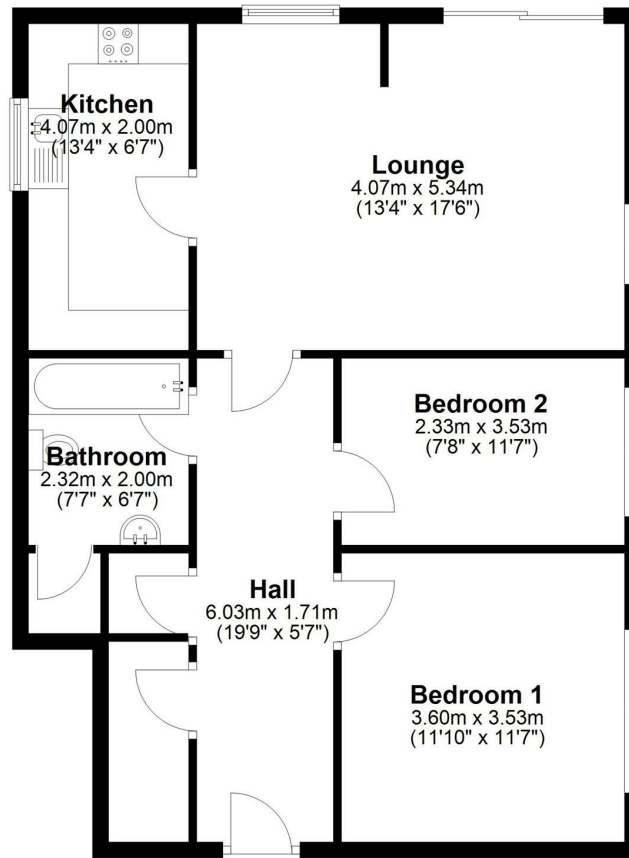

Total area: approx. 73.3 sq. metres (788.6 sq. feet)

## LOCAL AUTHORITY

## TENURE

## COUNCIL TAX BAND

B

## VIEWINGS

By prior appointment only

Energy Efficiency Rating		
	Current	Potential
Very energy efficient - lower running costs		
(92 plus) A		
(81-91) B	81	81
(69-80) C		
(55-68) D		
(39-54) E		
(21-38) F		
(1-20) G		
Not energy efficient - higher running costs		
England & Wales	EU Directive 2002/91/EC	

Agents Note: Whilst every care has been taken to prepare these particulars, they are for guidance purposes only. All measurements are approximate and are for general guidance purposes only and whilst every care has been taken to ensure their accuracy, they should not be relied upon and potential buyers/tenants are advised to recheck the measurements



## OFFICE ADDRESS

Hill House 1 St Albans Road  
Codicote  
SG4 8UT

## OFFICE DETAILS

01462 419333  
lettings@putterills.co.uk  
www.putterills.co.uk