



Stewart Place, Ware SG12 9UN

Offers in excess of £270,000



2



1

Taylor Phelps

Estate Agency

Taylor Phelps

Estate Agency

Taylor Phelps are pleased to offer this modern top floor apartment positioned within this popular development close to Ware high street and station which serves both Hertford East and London Liverpool Street! This well-presented apartment has two bedrooms, a spacious open plan living room, modern kitchen and bathroom and secure undercover parking.





Taylor Phelps



Taylor Phelps
Estate Agency



Taylor Phelps
Estate Agency



Taylor Phelps
Estate Agency



Taylor Phelps
Estate Agency



Taylor Phelps
Estate Agency



Taylor Phelps
Estate Agency



Taylor Phelps
Estate Agency

Floor Plan

STEWART PLACE
529 sq.ft. (49.1 sq.m.) approx.

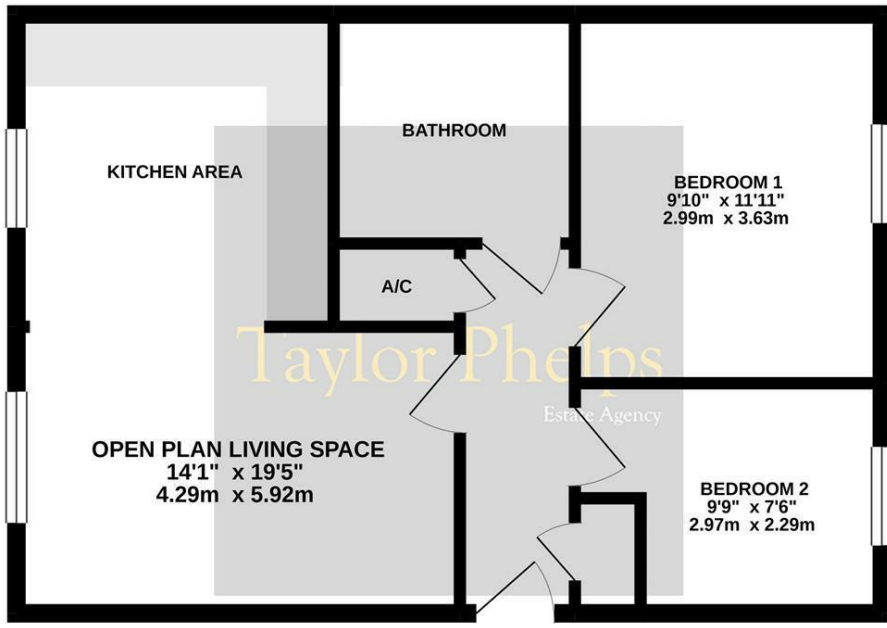

TOTAL FLOOR AREA: 529 sq.ft. (49.1 sq.m.) approx.
Whilst every attempt has been made to ensure the accuracy of the floorplan contained here, measurements of doors, windows, rooms and any other items are approximate and no responsibility is taken for any error, omission or mis-statement. This plan is for illustrative purposes only and should be used as such by any prospective purchaser. The services, systems and appliances shown have not been tested and no guarantee as to their operability or efficiency can be given.
Made with Metropix ©2023

Area Map

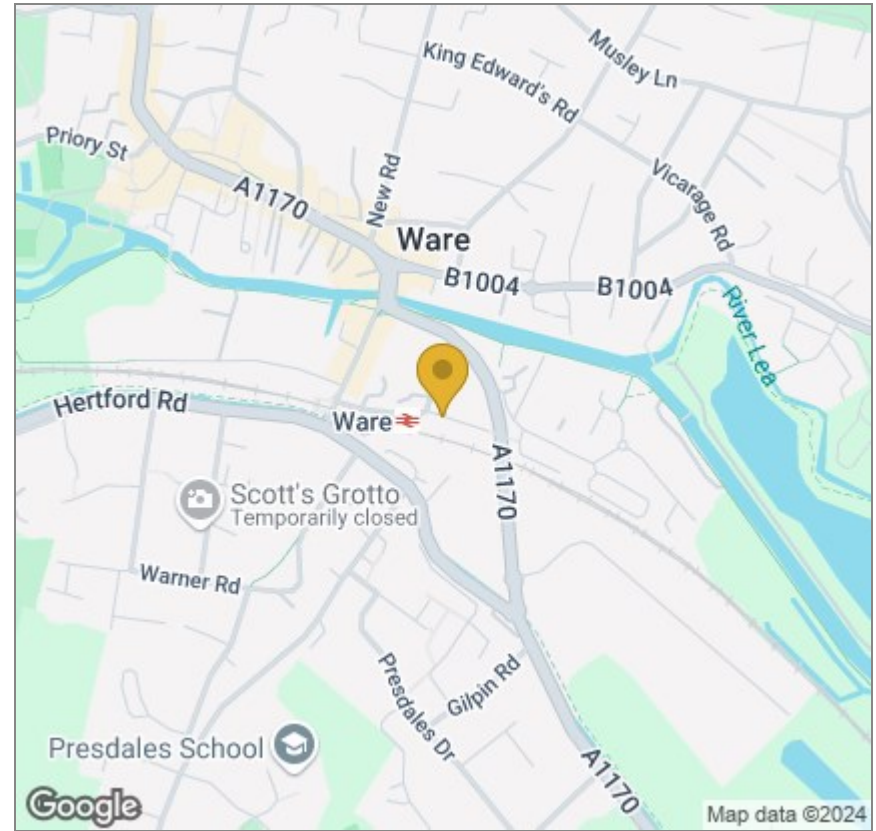

Energy Efficiency Graph

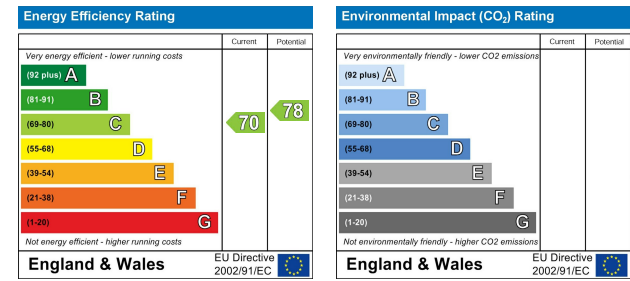

These particulars, whilst believed to be accurate are set out as a general outline only for guidance and do not constitute any part of an offer or contract. Intending purchasers should not rely on them as statements of representation of fact, but must satisfy themselves by inspection or otherwise as to their accuracy. No person in this firm's employment has the authority to make or give any representation or warranty in respect of the property.

01920 459000
hello@taylorhelps.co.uk

5 Frenchs Yard, Amwell End, Ware, Hertfordshire, SG12 9HP

www.taylorhelps.co.uk

