



Church Row, Ware SG12 9ER

£225,000



2



1

Taylor Phelps

Estate Agency



*Taylor Phelps are pleased to offer this investment opportunity in Ware Town Centre. This property consists of a two bedroom split level house with its own Garage close to the high street and train station which serves both Hertford East and London Liverpool Street. The property has approx. 50 years remaining on the lease - of which the cost to extend to 125 years we understand to be approx. £34,000.*







Taylor Phelps



Floor Plan

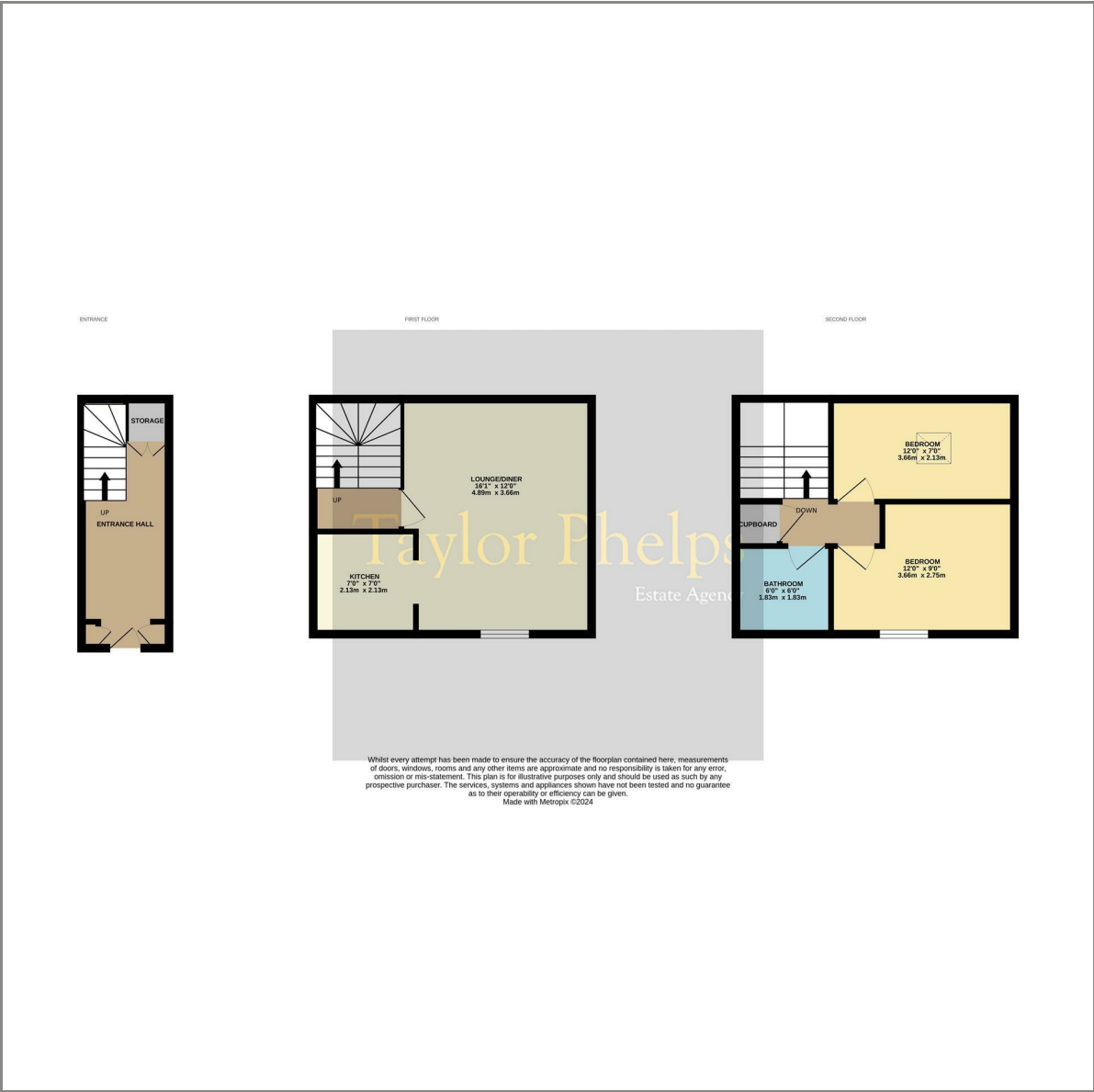

Area Map

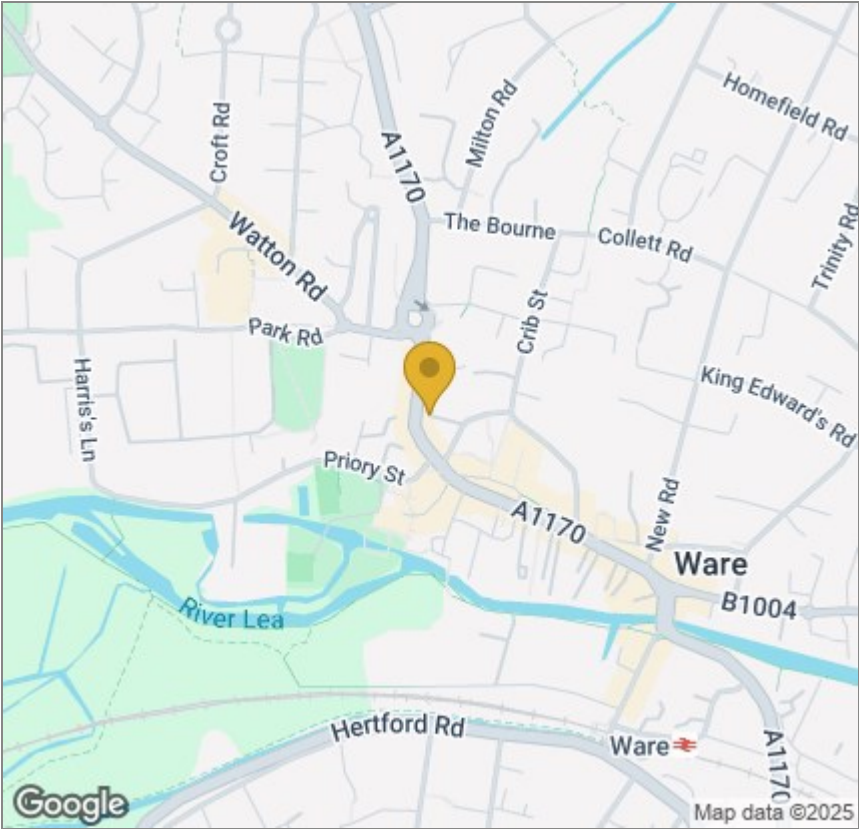

Energy Efficiency Graph

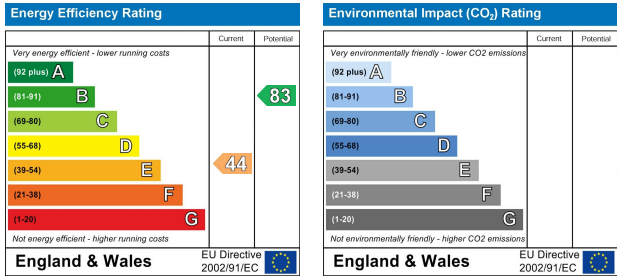

These particulars, whilst believed to be accurate are set out as a general outline only for guidance and do not constitute any part of an offer or contract. Intending purchasers should not rely on them as statements of representation of fact, but must satisfy themselves by inspection or otherwise as to their accuracy. No person in this firms employment has the authority to make or give any representation or warranty in respect of the property.