



Kilby Road, Stevenage SG1 2LU

£220,000



2



2

Taylor Phelps

Estate Agency

Taylor Phelps

Floor Plan

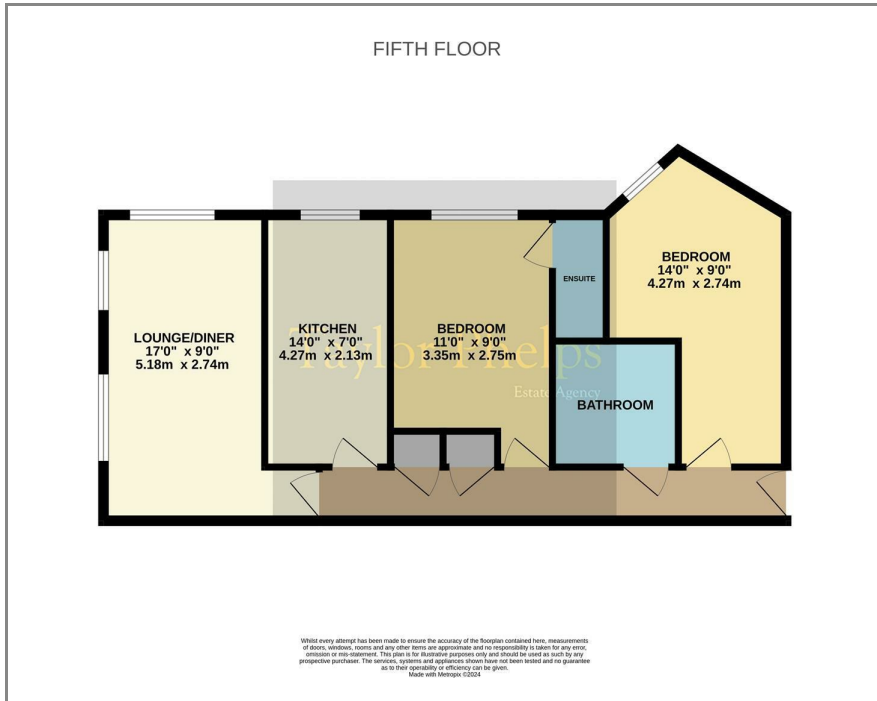

Taylor Phelps are pleased to offer an opportunity to acquire this spacious two bedroom two bathroom apartment located centrally and close to the town centre and train station. Available Chain Free



Area Map

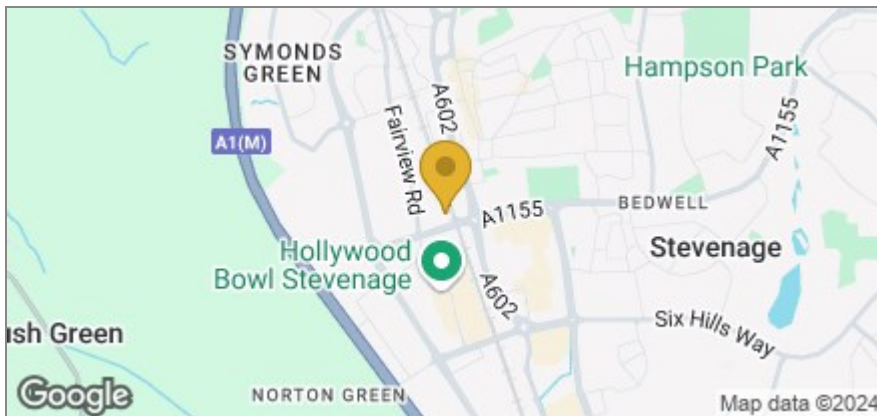

Energy Efficiency Graph

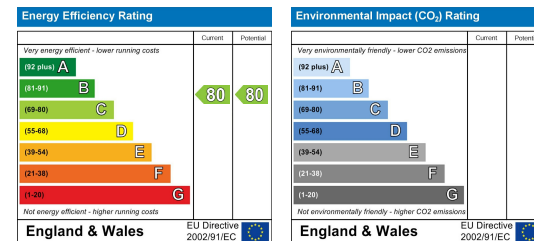

These particulars, whilst believed to be accurate are set out as a general outline only for guidance and do not constitute any part of an offer or contract. Intending purchasers should not rely on them as statements of representation of fact, but must satisfy themselves by inspection or otherwise as to their accuracy. No person in this firm's employment has the authority to make or give any representation or warranty in respect of the property.

01920 459000

hello@taylorphelps.co.uk

5 Frenchs Yard, Amwell End, Ware, Hertfordshire, SG12 9HP

www.taylorphelps.co.uk

