



Fanhams Hall Road, Ware SG12 7PU

Guide price £250,000



1



1

Taylor Phelps

Estate Agency

Estate Agency

Floor Plan

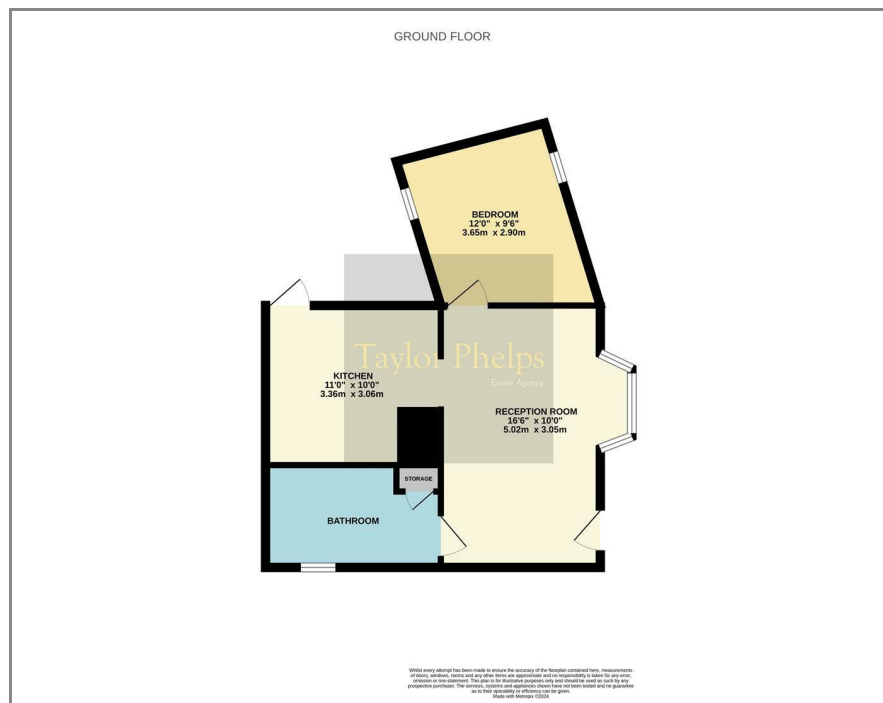

Taylor Phelps are pleased to offer this highly individual cottage forming part of this stable conversion on the outskirts of Ware. The balanced accommodation includes an entrance hall, open plan living space including the kitchen, a double bedroom and large bathroom. The property also benefits from parking and a private garden. Available Chain Free!



Area Map

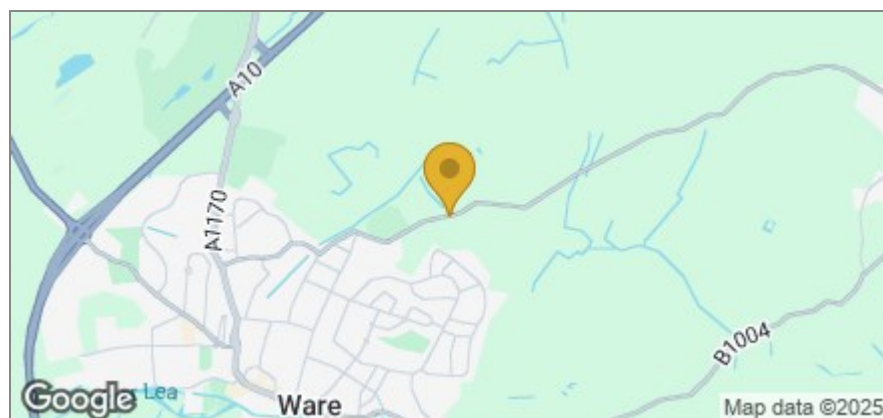

These particulars, whilst believed to be accurate are set out as a general outline only for guidance and do not constitute any part of an offer or contract. Intending purchasers should not rely on them as statements of representation of fact, but must satisfy themselves by inspection or otherwise as to their accuracy. No person in this firm's employment has the authority to make or give any representation or warranty in respect of the property.

01920 459000

hello@taylorphelps.co.uk

5 Frenchs Yard, Amwell End, Ware, Hertfordshire, SG12 9HP

www.taylorphelps.co.uk

