



Rumsley, West Cheshunt EN7 6BW

Guide price £465,000



3



1

Taylor Phelps

Estate Agency

Taylor Phelps

Estate Agency

Taylor Phelps are pleased to offer this three bedroom family home positioned in West Cheshunt. This house benefits from a modern family kitchen with dining area, spacious living room and downstairs w/c. Upstairs offers the three bedrooms and a brand new family bathroom. Externally there is a well kept south facing rear garden and ample driveway to the front providing off street parking. This house has been freshly redecorated throughout and is conveniently placed for good school catchment areas.



Taylor Phelps



Taylor Phelps  
Estate Agency



Taylor Phelps



Taylor Phelps  
Estate Agency



Taylor Phelps  
Estate Agency



Taylor Phelps  
Estate Agency



Taylor Phelps  
Estate Agency



Taylor Phelps  
Estate Agency



Taylor Phelps  
Estate Agency







# Floor Plan

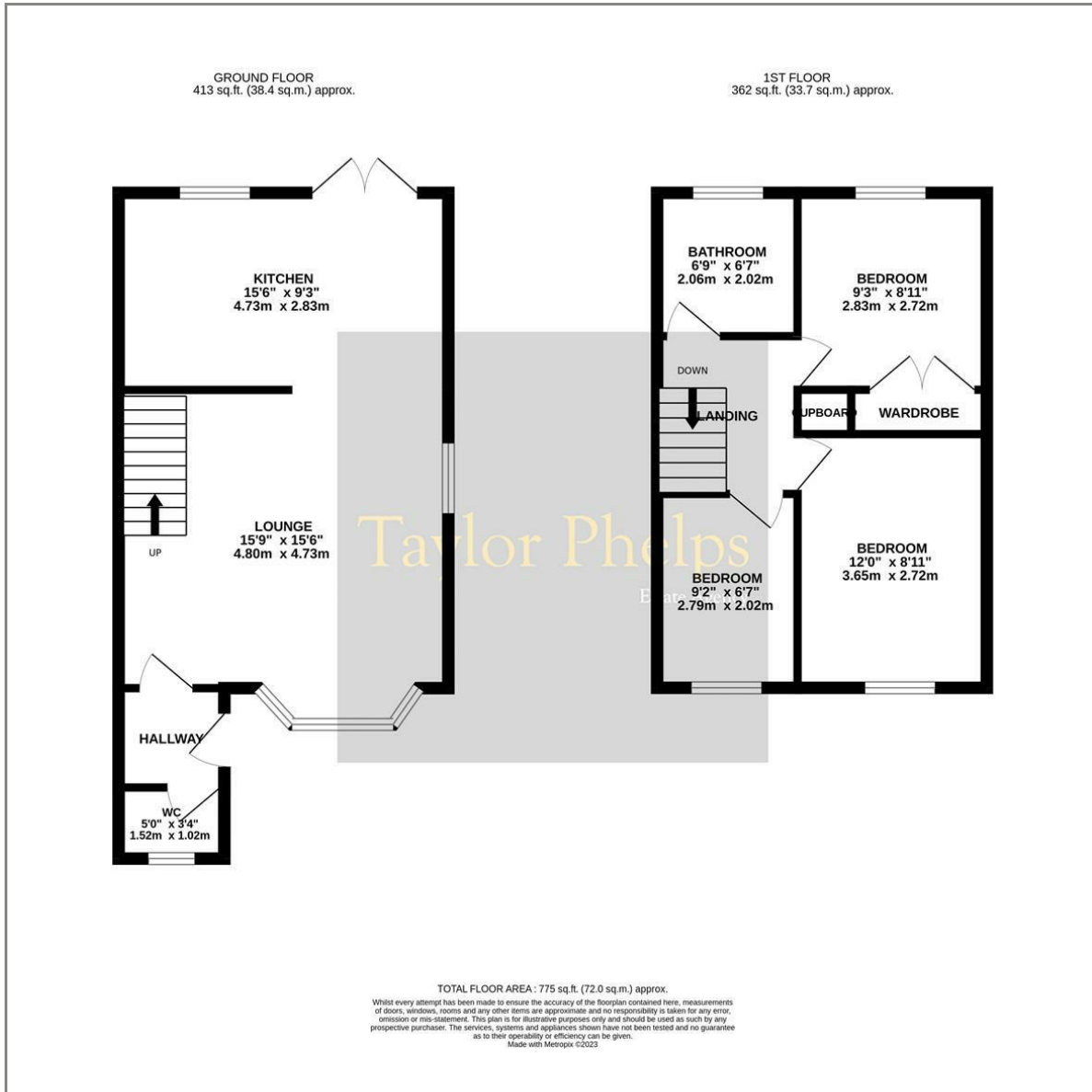

# Area Map



# Energy Efficiency Graph

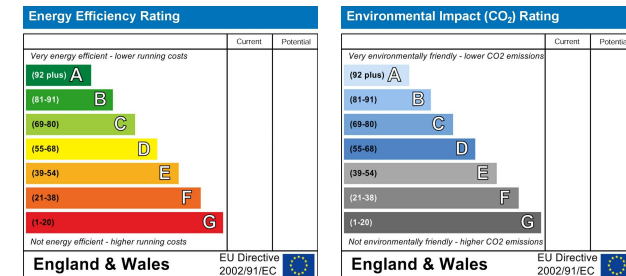

These particulars, whilst believed to be accurate are set out as a general outline only for guidance and do not constitute any part of an offer or contract. Intending purchasers should not rely on them as statements of representation of fact, but must satisfy themselves by inspection or otherwise as to their accuracy. No person in this firm's employment has the authority to make or give any representation or warranty in respect of the property.

01920 459000

hello@taylorphelps.co.uk

5 Frenchs Yard, Amwell End, Ware, Hertfordshire, SG12 9HP

www.taylorphelps.co.uk

