



Dark Lane, West Cheshunt EN7 5ED
Guide price £615,000



3



2

Taylor Phelps

Estate Agency

Estate Agency

Taylor Phelps are delighted to offer this brand new high spec family home positioned in West Cheshunt within the catchment area of the highly regarded Goffs School. This exceptional property boasts a stunning family kitchen which must be viewed to be fully appreciated. The ground floor further consists a separate utility room and downstairs w/c, moving upstairs are the bedrooms and luxury bathrooms. Externally there is a landscaped rear garden and driveway to the front providing ample off street parking. 10 Year NHBC certificate.









Taylor Phelps



Taylor Phelps



Taylor Phelps



Taylor Phelps





Floor Plan

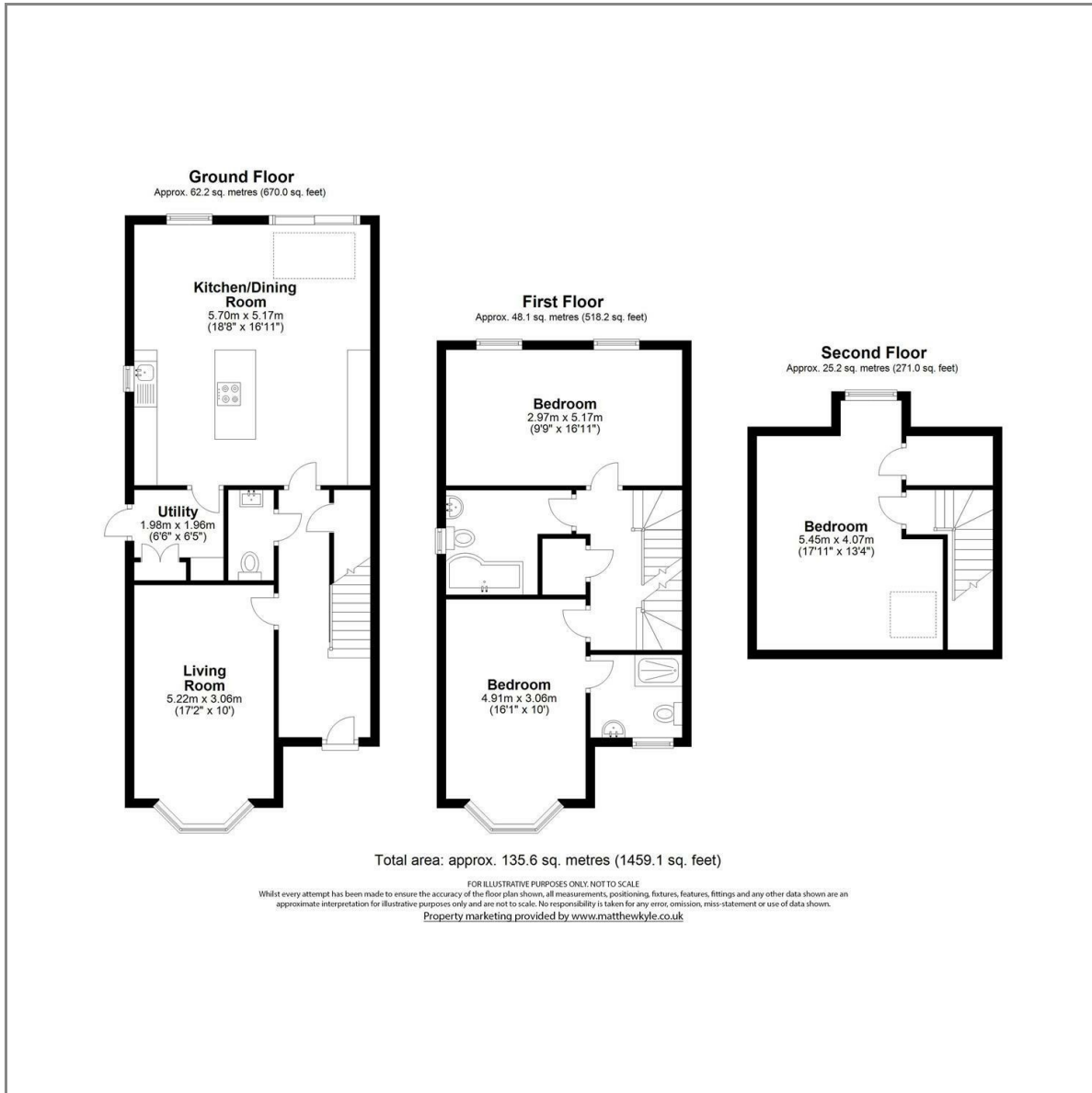

Area Map

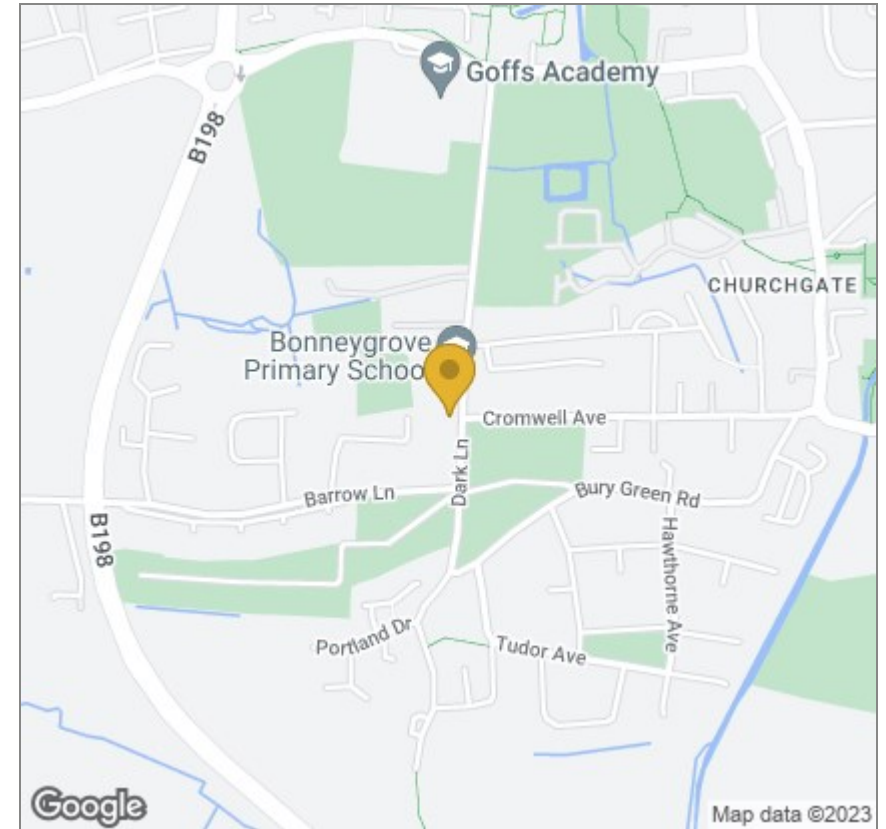

Energy Efficiency Graph

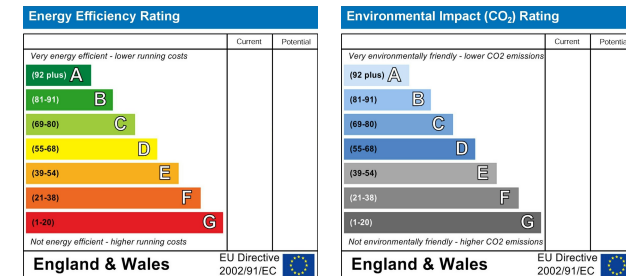

These particulars, whilst believed to be accurate are set out as a general outline only for guidance and do not constitute any part of an offer or contract. Intending purchasers should not rely on them as statements of representation of fact, but must satisfy themselves by inspection or otherwise as to their accuracy. No person in this firm's employment has the authority to make or give any representation or warranty in respect of the property.

01920 459000

hello@taylorhelps.co.uk

5 Frenchs Yard, Amwell End, Ware, Hertfordshire, SG12 9HP

www.taylorhelps.co.uk

