



Redwood Drive, Brandesburton, Driffield
£299,950



2



2



2



Exempt



**** STUNNING GROUND FLOOR PROPERTY IN A SPECTACULAR GRADE II LISTED HISTORIC BUILDING****

Brandesburton Hall sits in grounds that span approximately 4.5 acres and include manicured lawns and mature planting and even includes the tallest Redwood tree in Yorkshire! The Hall has been lovingly converted into a selection of beautiful homes and Our House are delighted to bring this ground floor apartment to the market for you to view!

The property comes with 4 parking spaces and its own private garden to the front. Through the entrance door you are greeted with a traditional property that has all the period features you would expect such as high ceilings, towering windows and decorative tiling married together perfectly with modern decoration, fixtures and fittings!

The current vendors have decorated this property to a very high standard throughout and it offers a large living room, kitchen with dining/living room off, two double bedrooms with fitted wardrobes, laundry room, bathroom and shower room.

This property must be viewed to appreciate all there is to offer!

EPC - Exempt
Council Tax - D
Tenure - Leasehold with share of Freehold





Front Garden

A beautifully presented private terrace garden, the area is mostly paved and has fenced boundaries, some mature planting and a small artificial lawned area.

Entrance Porch

Entrance door with decorative stained glass pannel above, traditionally decorated with half tiled walls, high ceilings, coving and tiled floor.

Hallway

An internal door from the porch leads to the long central hallway from which the other rooms flow, this has been newly decorated there is decorative tiled flooring, two chandeliers and radiator. Off the hallway there is also a large storage cupboard.

Lounge

25'1" x 21'1"

A large and beautifully decorated living room with 2 large windows providing lots of light into the room, each window has wooden shutters and made to measure Roman blinds and pelmets. There is an ornate fireplace with an electric fire and marble hearth, there are also

3 radiators to heat the room. The high ceilings are framed by coving and the neutral carpet is edged with tall skirting boards as would be expected from such a grand property. Further lighting is provided by the ceiling spotlights and mood lighting can be created by the wall lights. This room also has a large alcove that is currently used as an office.

Kitchen

19'7" x 8'10"

The kitchen at the property has been created in a way to marry the traditional style of this property with a modern twist. There are fitted wall and base units providing ample storage, the doors are finished in a traditional shaker style with modern brushed steel handles and complemented by the granite worktop and tiled splashback. There is a traditional Belfast sink with a modern spray tap, space for a range cooker and American fridge freezer. This room is again lit by a large sash window fitted with wooden shutters and spotlights, there is coving to the ceiling, tiled flooring and a radiator.

Living/Dining room

19'6" x 12'0"

Leading down from the kitchen there is another space that is currently used as a dining room/living room, the room has lovely oak wood flooring, coving to the ceiling, a large window with wooden shutter and two radiators.

Laundry room

9'0" x 4'0"

A nice additional space for keeping your laundry out of the way, there is space and plumbing for a washing machine and dryer, wooden clothes pulley, built in work surface and shelving, tiled walls and flooring and extractor fan.

Master bedroom

22'4" x 9'5"

The master bedroom again benefits from the high ceilings, coving and large window fitted with wooden shutters, Roman blinds and matching pelmet. This room is fitted with two spectacular modern ceiling lights There are built in wardrobes to one wall providing lots of storage, neutral carpet and radiator.

Bedroom 2

17'1" x 9'8"

Similarly to the master bedroom, bedroom 2 also has built in wardrobes, large window with fitted wooden blinds, made to measure Roman blinds and matching pelmet, coving to ceiling, neutral carpet and radiator.

Shower room

9'4" x 5'0"

The shower room has been finished to a very high standard and in a very modern style. Vanity unit housing hand wash basin and W.C, large walk in shower with waterfall shower, decorative wall cladding, extractor fan and heated towel rail.

Bathroom

9'5" x 7'2"

The bathroom likewise with the shower room has been finished to a high and modern standard, with pedestal hand wash basin, W.C, roll top style bath with waterfall shower over and heated towel rail. This room has fully tiled walls and is finished with Italian tiled flooring.

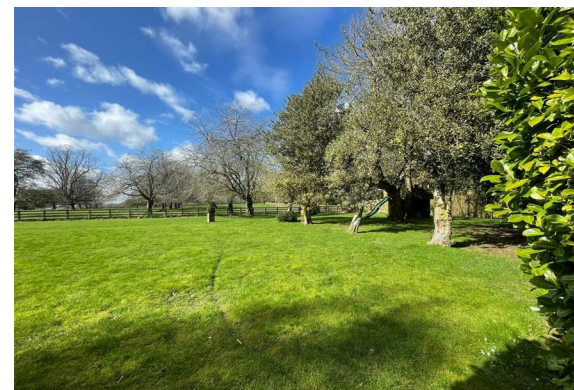

Approx Gross Internal Area
154 sq m / 1661 sq ft

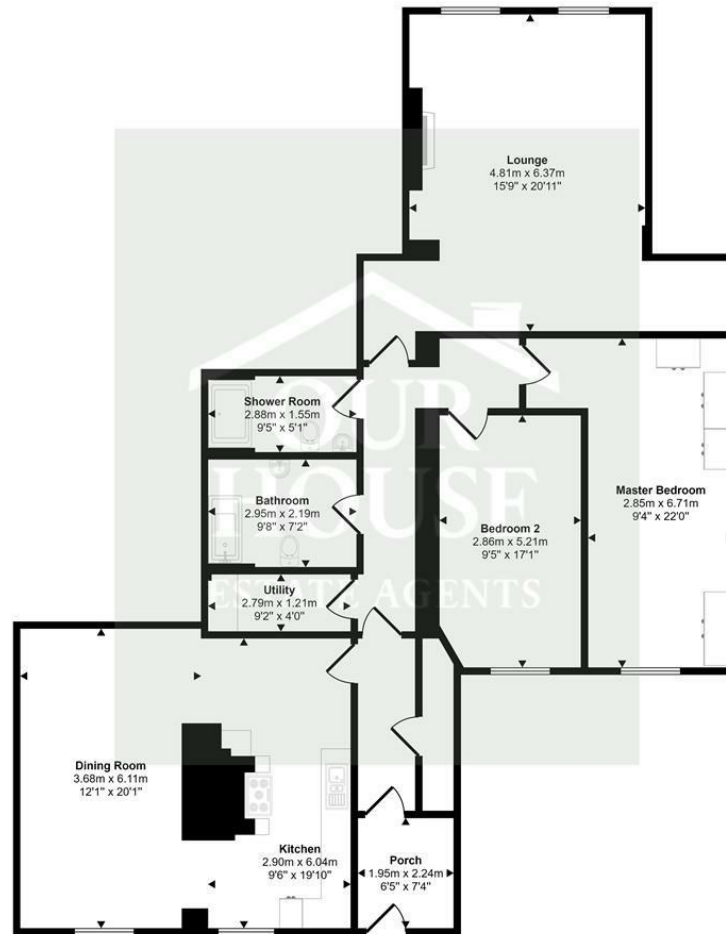

Floorplan

This floorplan is only for illustrative purposes and is not to scale. Measurements of rooms, doors, windows, and any items are approximate and no responsibility is taken for any error, omission or mis-statement. Icons of items such as bathroom suites are representations only and may not look like the real items. Made with Made Snappy 360.

These particulars, whilst believed to be accurate are set out as a general outline only for guidance and do not constitute any part of an offer or contract. Intending purchasers should not rely on them as statements of representation of fact, but must satisfy themselves by inspection or otherwise as to their accuracy. No person in this firm's employment has the authority to make or give any representation or warranty in respect of the property.

Our House Estate Agents

20 Newbegin Hornsea, East Yorkshire, HU18 1AL

T. 01964 532121 | E. office@ourhouseestateagents.co.uk

