



## Princess Way

Salisbury, SP4 7GH

Guide price £410,000

**SR.Estate**  
Estate & Property Services





## Guide price **£410,000**

Positioned on the ever popular Kings Gate Estate developed by Bloor Homes, this beautifully presented detached home offers a fantastic amount of space set over two floors. The accommodation comprises four bedrooms, en-suite shower room and built in wardrobes to the principal bedroom, family bathroom, living room, kitchen/dining room, well proportioned private rear garden, driveway parking and garage.

Energy Efficiency Rating		
	Current	Potential
<i>Very energy efficient - lower running costs</i>		
(92 plus) <b>A</b>		<b>95</b>
(81-91) <b>B</b>	<b>86</b>	
(69-80) <b>C</b>		
(55-68) <b>D</b>		
(39-54) <b>E</b>		
(21-38) <b>F</b>		
(1-20) <b>G</b>		
<i>Not energy efficient - higher running costs</i>		
<b>England &amp; Wales</b>	EU Directive 2002/91/EC	

Environmental Impact (CO <sub>2</sub> ) Rating		
	Current	Potential
<i>Very environmentally friendly - lower CO<sub>2</sub> emissions</i>		
(92 plus) <b>A</b>		
(81-91) <b>B</b>		
(69-80) <b>C</b>		
(55-68) <b>D</b>		
(39-54) <b>E</b>		
(21-38) <b>F</b>		
(1-20) <b>G</b>		
<i>Not environmentally friendly - higher CO<sub>2</sub> emissions</i>		
<b>England &amp; Wales</b>	EU Directive 2002/91/EC	

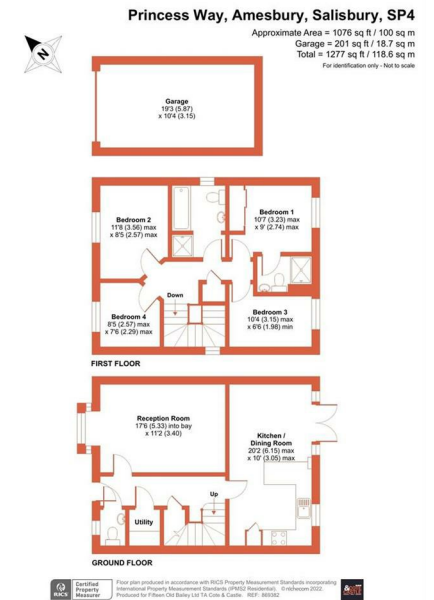

**Energy Efficiency Graph**

**Area Map**

**Floor Plan**



26-28  
Hammersmith Grove  
London, W6 7BA



[estate@steelerose.co.uk](mailto:estate@steelerose.co.uk)



[steelerose.co.uk](http://steelerose.co.uk)



01722 548312

Salisbury



01264 318599

Andover



01962 589725

Winchester