



Higham Estate Agents



114 Manchester Road

Astley, Tyldesley, M29 7EJ

£275,000

HIGHAM ESTATE AGENTS are delighted to bring to the market this spacious, two bedroom detached bungalow in Astley. Situated conveniently within easy access to local amenities, public houses, stunning open walks near the Bridgewater canal and within easy access to Leigh and transport links this spacious home also offers a great size driveway to the front and a low maintenance garden to the rear.

In brief this home consists a welcoming entrance hallway, with doors leading to all the internal accommodation. Sitting at the front of the property is the modern kitchen dining room, boasting a range of wall and base units with complimentary work surfaces, space for appliances, good size dining area and door leading to the rear garden. To the rear, a well proportioned sitting room with patio doors over looking the rear garden. Further accommodation includes two good size bedrooms and a modern four piece family bathroom with shower cubicle. Externally the property is welcomed by a good size driveway providing off road parking for numerous vehicles. To the rear the property offers a stunning garden with lawned and paved areas along with decorative shrubs and borders.

Viewing

Please contact us on 01942 889080 if you wish to arrange a viewing appointment for this property or require further information.

- Two Bedroom
- Detached Bungalow
- Large Driveway to Front
- Attached Garage
- Private Rear Garden
- Council Tax Band B

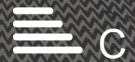

Floor Plan

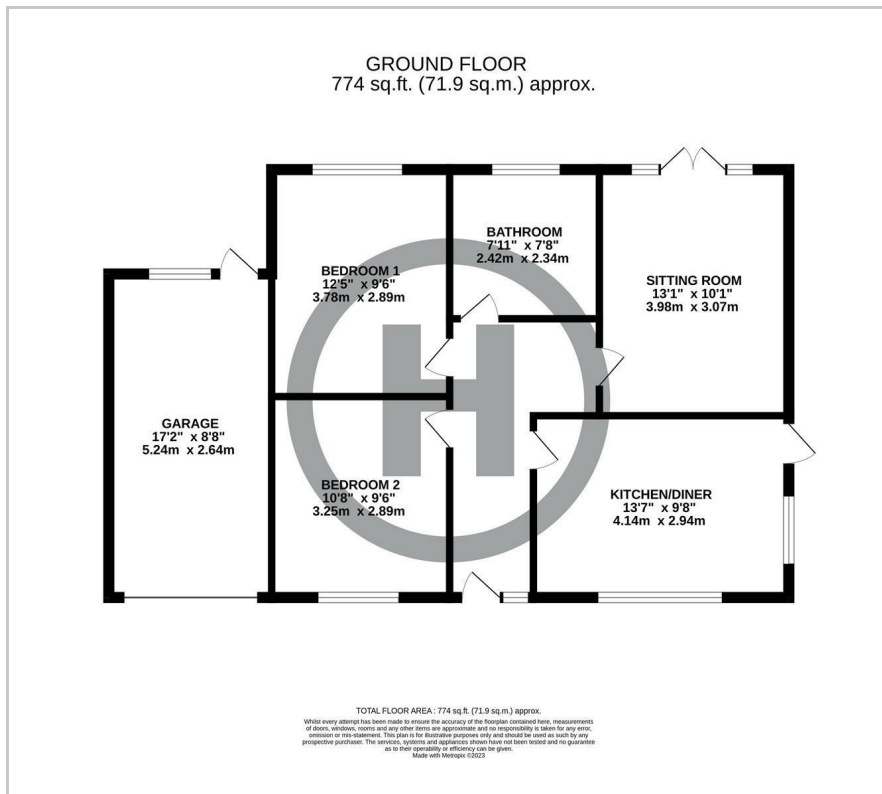

Area Map



Energy Efficiency Graph

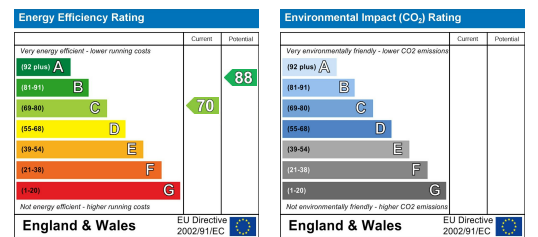

These particulars, whilst believed to be accurate are set out as a general outline only for guidance and do not constitute any part of an offer or contract. Intending purchasers should not rely on them as statements of representation of fact, but must satisfy themselves by inspection or otherwise as to their accuracy. No person in this firm's employment has the authority to make or give any representation or warranty in respect of the property.