



7 Crown Walk, Wembley, HA9 8HU

A SPACIOUS TWO DOUBLE BEDROOM FLAT WITH PARKING & A GARAGE We are delighted to bring to the market this extremely spacious first floor flat located just a short walk from Wembley Park Metropolitan & Jubilee line tube station which offers excellent links throughout London & the surrounding areas.

This chain free property briefly comprises of a large entrance hall with built in storage, a fitted kitchen, a large lounge with a Juliet balcony, two double bedrooms and a family bathroom. Further benefits include a long lease with a share of the Freehold, allocated parking and a garage within a small block.

- TWO DOUBLE BEDROOMS
- FIRST FLOOR FLAT
- LONG LEASE WITH SHARE OF FREEHOLD
- GARAGE IN A BLOCK
- GATED PARKING TO THE REAR
- EXTREMELY SPACIOUS PROPERTY
- WALKING DISTANCE TO WEMBLEY PARK TUBE
- CHAIN FREE SALE

£369,950

Floor Plan

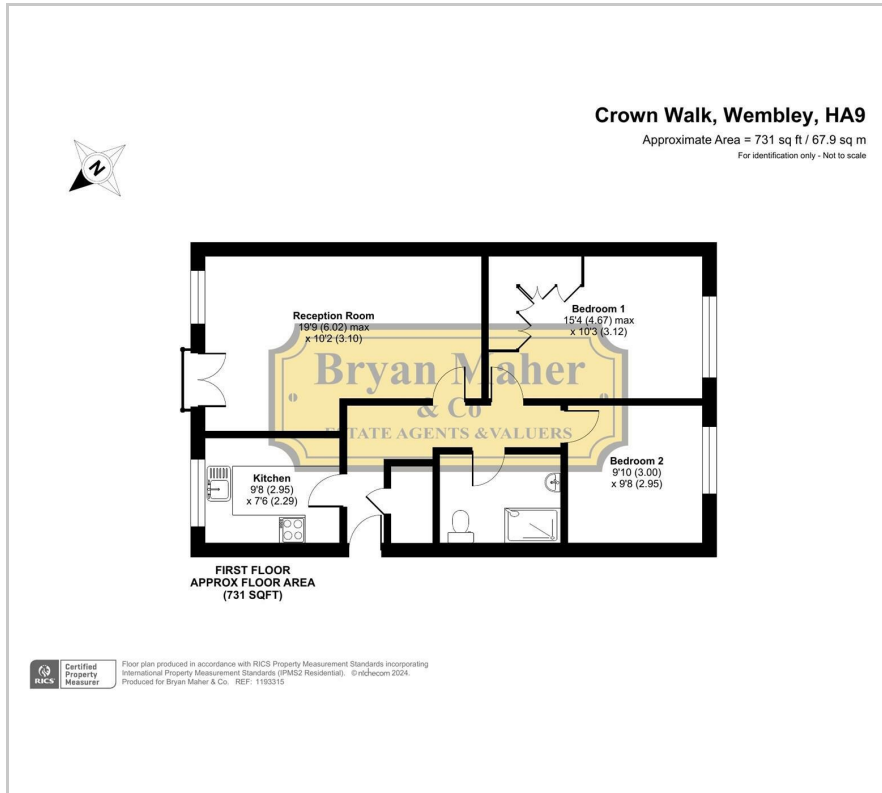

Area Map

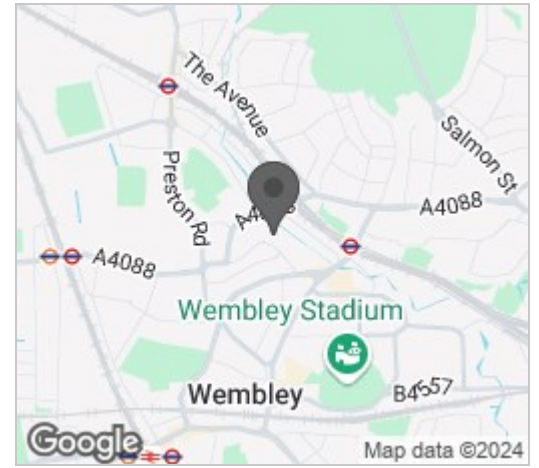

Energy Efficiency Graph

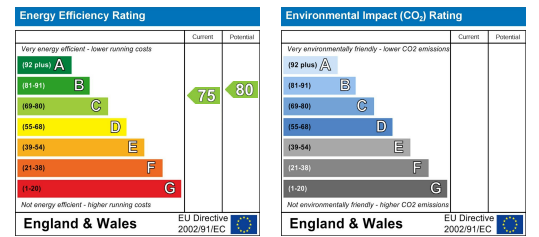

These particulars, whilst believed to be accurate are set out as a general outline only for guidance and do not constitute any part of an offer or contract. Intending purchasers should not rely on them as statements of representation of fact, but must satisfy themselves by inspection or otherwise as to their accuracy. No person in this firm's employment has the authority to make or give any representation or warranty in respect of the property.