



## 2 Bulmer Gardens, HARROW, Middlesex, HA3 0PA

**\*A BEAUTIFUL THREE DOUBLE BEDROOM SEMI DETACHED FAMILY HOME\*** We are absolutely delighted to have been favoured with instructions to bring to the market this amazing three double bedroom semi detached family home located on this highly sought after cul-de-sac in the heart of the Mount Stewart catchment area. The property has been extended to the rear and now briefly comprises of a welcoming entrance hall, a downstairs W/C, a large modern kitchen/breakfast room, an interconnecting through lounge, three bedrooms and a modern family bathroom.

Externally the front driveway provides off street parking and leads to a garage with additional space to the side. To the rear of the property you will find a wonderful wrap around garden.

An early viewing is strongly advised in order to avoid disappointment for this superb chain free property.

- THREE DOUBLE BEDROOMS
- WIDE CORNER PLOT
- MODERN KITCHEN/BREAKFAST ROOM
- GROUND FLOOR W/C
- LARGE THROUGH LOUNGE
- OFF STREET PARKING LEADING TO A SIDE GARAGE
- WONDERFUL WRAP AROUND GARDEN
- MOUNT STEWART CATCHMENT AREA
- QUIET CUL-DE-SAC
- CHAIN FREE SALE

**£799,950**



Floor Plan

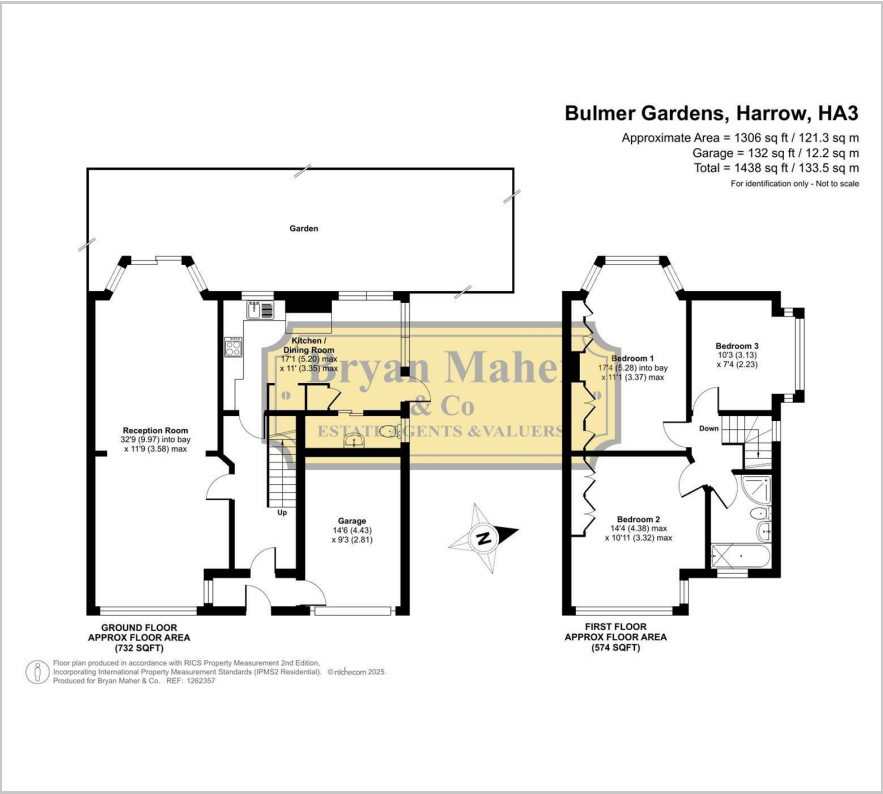

Area Map



Energy Efficiency Graph

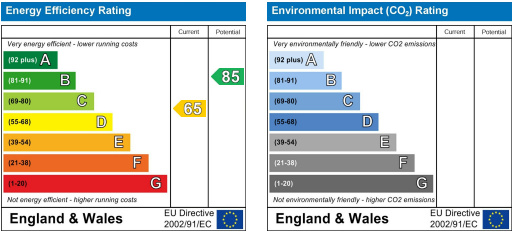

These particulars, whilst believed to be accurate are set out as a general outline only for guidance and do not constitute any part of an offer or contract. Intending purchasers should not rely on them as statements of representation of fact, but must satisfy themselves by inspection or otherwise as to their accuracy. No person in this firms employment has the authority to make or give any representation or warranty in respect of the property.