



102 West Hill, WEMBLEY, Middlesex, HA9 9RR

A UNIQUE SEMI DETACHED PROPERTY OFFERING A WIDER THAN AVERAGE SIDE PLOT We are delighted to bring to the market this superb three bedroom family home set on this prime position at the peak of the Barn Hill Estate, directly opposite Fryent Country Park which provides open spaces for children to play, along with quiet tranquil woodland walks and stunning panoramic views. This property boasts a far wider than average plot to the side, making this the perfect opportunity for a purchaser hoping to significantly extend and add tremendous value to their next home (stpp).

Internally, the property briefly comprises of a welcoming entrance hall, a fitted kitchen measuring circa 16ft, two spacious reception rooms, three first floor bedrooms and a large family bathroom.

Externally, to the front of the property, you will find a well stocked garden, off street parking, a wider than average detached garage and a convenient pathway which leads you through to a good size garden backing onto green open space.

We anticipate huge demand for this absolute gem, so an early viewing is strongly advised.

- THREE BEDROOM SEMI DETACHED FAMILY HOME
- EXTREMELY WIDE PLOT TO THE SIDE
- ENORMOUS EXTENSION POTENTIAL STPP
- OVERLOOKING FRYENT COUNTRY PARK
- PRIME POSITION ON THE BARN HILL ESTATE
- TWO SPACIOUS RECEPTION ROOMS
- GAS CENTRAL HEATING & DOUBLE GLAZING
- LARGE REAR GARDEN
- WEMBLEY PARK & PRESTON ROAD TUBE STATIONS
- CHAIN FREE SALE

£674,950

Floor Plan

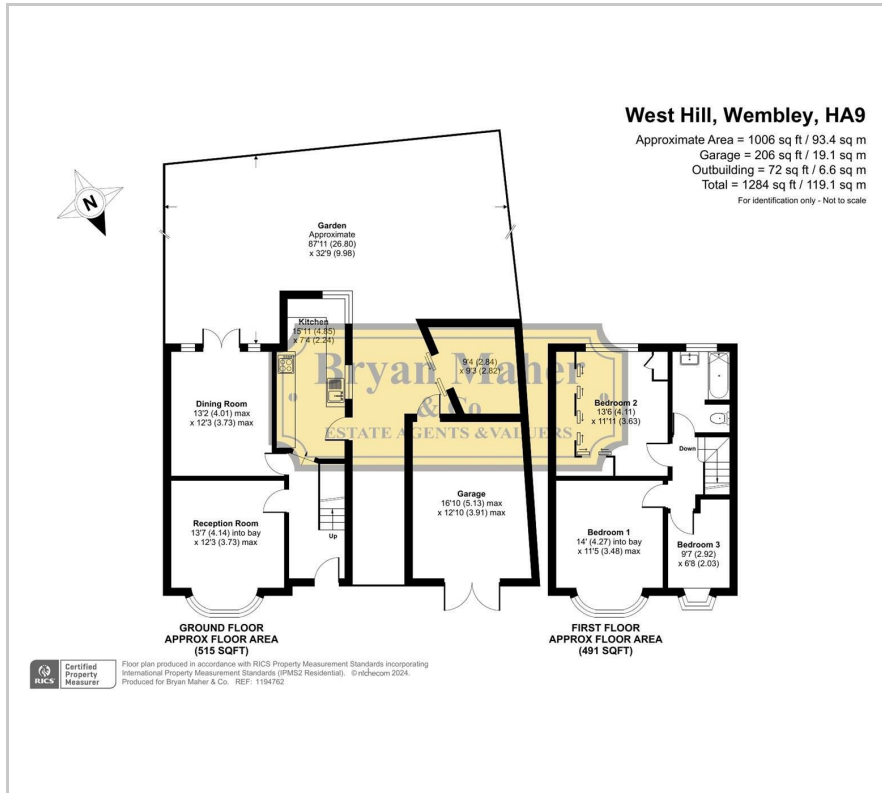

Area Map



Energy Efficiency Graph

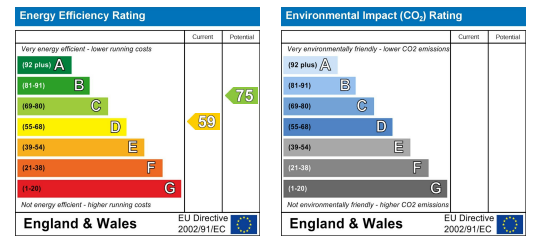

These particulars, whilst believed to be accurate are set out as a general outline only for guidance and do not constitute any part of an offer or contract. Intending purchasers should not rely on them as statements of representation of fact, but must satisfy themselves by inspection or otherwise as to their accuracy. No person in this firm's employment has the authority to make or give any representation or warranty in respect of the property.