



8 Oldfield Road
 , London, NW10 9UE
£535,000

DEVELOPMENT OPPURTUNITY TO CONVERT THIS PROPERTY INTO TWO FLATS. We are delighted to have been favoured with instructions to bring to the market this large two bedroom mid terrace home in the heart of NW10. Please see the attached proposed drawings in the floorplan tab showing the layout which includes a large studio flat on the ground floor and a duplex two bedroom flat on the second floor all subject to usual planning consent. We strongly advise an early inspection of this great opportunity.

Viewing

Please contact our Bryan Maher & Co Office on 020 8904 8904 if you wish to arrange a viewing appointment for this property or require further information.



Floor Plan

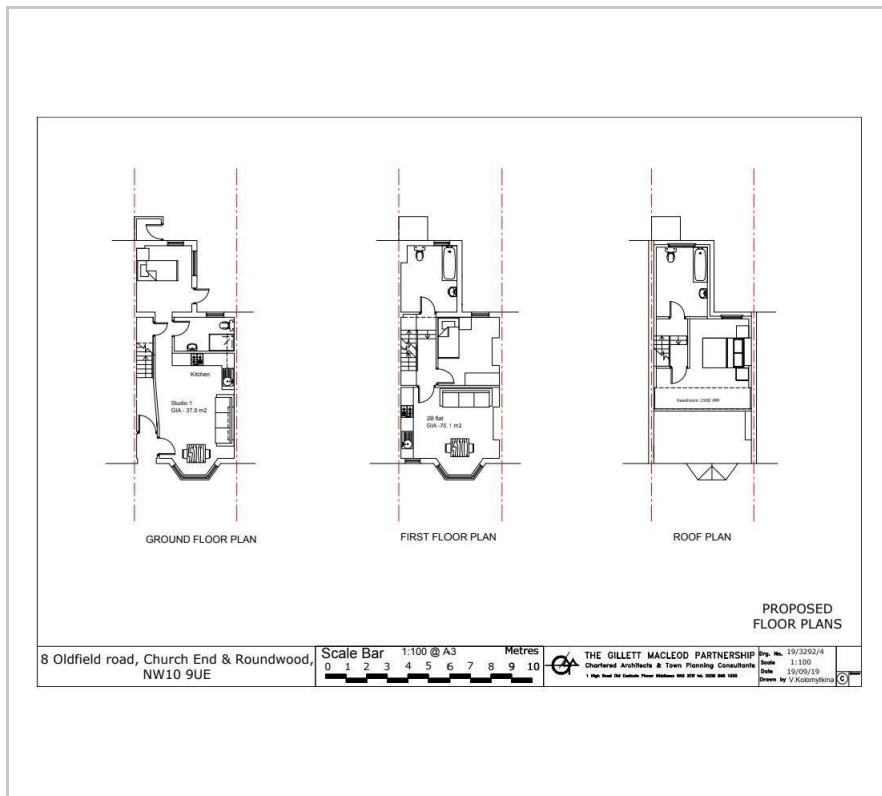

Area Map



Energy Efficiency Graph

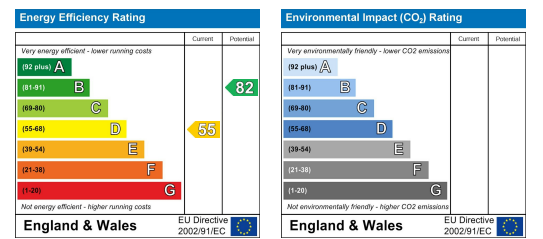

These particulars, whilst believed to be accurate are set out as a general outline only for guidance and do not constitute any part of an offer or contract. Intending purchasers should not rely on them as statements of representation of fact, but must satisfy themselves by inspection or otherwise as to their accuracy. No person in this firm's employment has the authority to make or give any representation or warranty in respect of the property.

