



24 Gore Court, Fryent Way, London, NW9 9SN

A SPACIOUS TWO DOUBLE BEDROOM FLAT CLOSE TO KINGSBURY HIGH ROAD We are delighted to have been favoured with instructions to bring to the market this large purpose built flat located within walking distance to Kingsbury Jubilee line tube station along with all of the other amenities Kingsbury High Road has to offer.

The property briefly comprises of a welcoming entrance hall, a fitted kitchen with an additional storage area, a 16'10" lounge, two double bedrooms and a family bathroom. Further benefits include two balconies and a storage facility on the ground floor.

We strongly feel this large chain free property would suit first time buyers and also the buy to let market, offering a discerning investor the opportunity to capitalise on the excellent rental figures being achieved within this area.

- TWO DOUBLE BEDROOMS
- PURPOSE BUILT FLAT
- TOP FLOOR
- DOUBLE GLAZING
- ADDITIONAL STORAGE AREAS
- PERFECT FIRST TIME PURCHASE OR INVESTMENT
- TWO LARGE BALCONIES
- OFF STREET PARKING SPACES
- WALKING DISTANCE TO THE JUBILEE LINE TUBE
- CHAIN FREE SALE

£284,950

Floor Plan

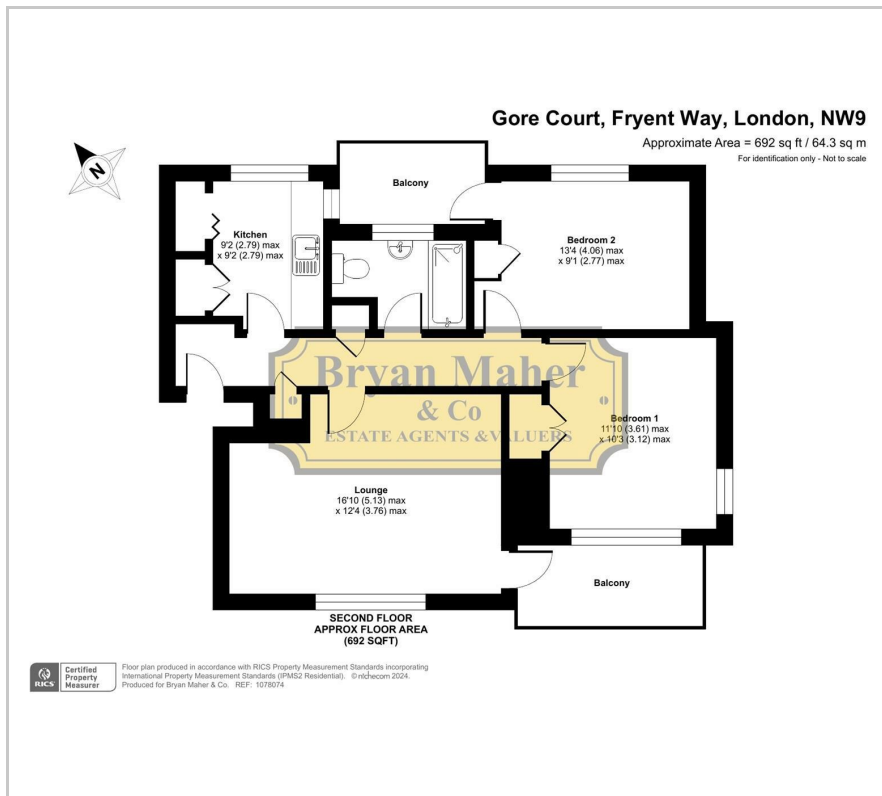

Area Map

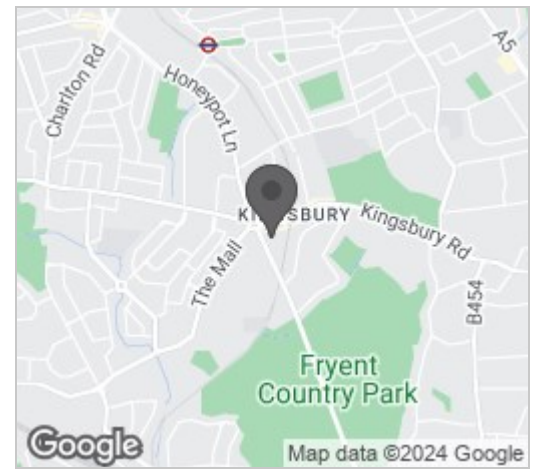

Energy Efficiency Graph

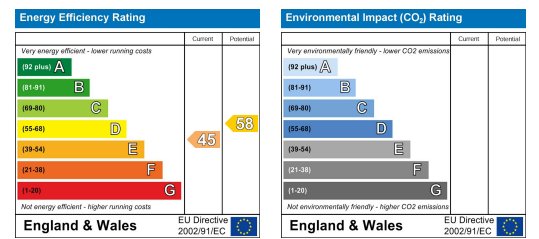

These particulars, whilst believed to be accurate are set out as a general outline only for guidance and do not constitute any part of an offer or contract. Intending purchasers should not rely on them as statements of representation of fact, but must satisfy themselves by inspection or otherwise as to their accuracy. No person in this firm's employment has the authority to make or give any representation or warranty in respect of the property.

