



## 74 Thirlmere Gardens, Wembley, Middlesex, HA9 8RE

\*A WELL PRESENTED THREE BEDROOM SEMI DETACHED FAMILY HOME\* We are delighted to bring to the market this charming three bedroom property located on this highly sought after road within close proximity to Preston Road Metropolitan line & South Kenton Bakerloo line tube stations. The property is also within walking distance to coveted local schools & open parkland making this a perfect choice for families with younger children.

Internally the property briefly comprises of a welcoming entrance hallway, a fitted kitchen, two reception rooms, three first floor bedrooms, a family bathroom and a separate W/C. Externally you will find a paved front garden, a garage approached via a shared driveway and a large well maintained garden to the rear, perfect for entertaining.

- THREE BEDROOMS
- SEMI DETACHED FAMILY HOME
- FITTED KITCHEN
- TWO RECEPTION ROOMS
- LARGE REAR GARDEN
- GARAGE VIA SHARED DRIVEWAY
- HIGHLY SOUGHT AFTER ROAD
- CLOSE TO MET' & BAKERLOO LINE

**Price Guide £584,950**



# Floor Plan

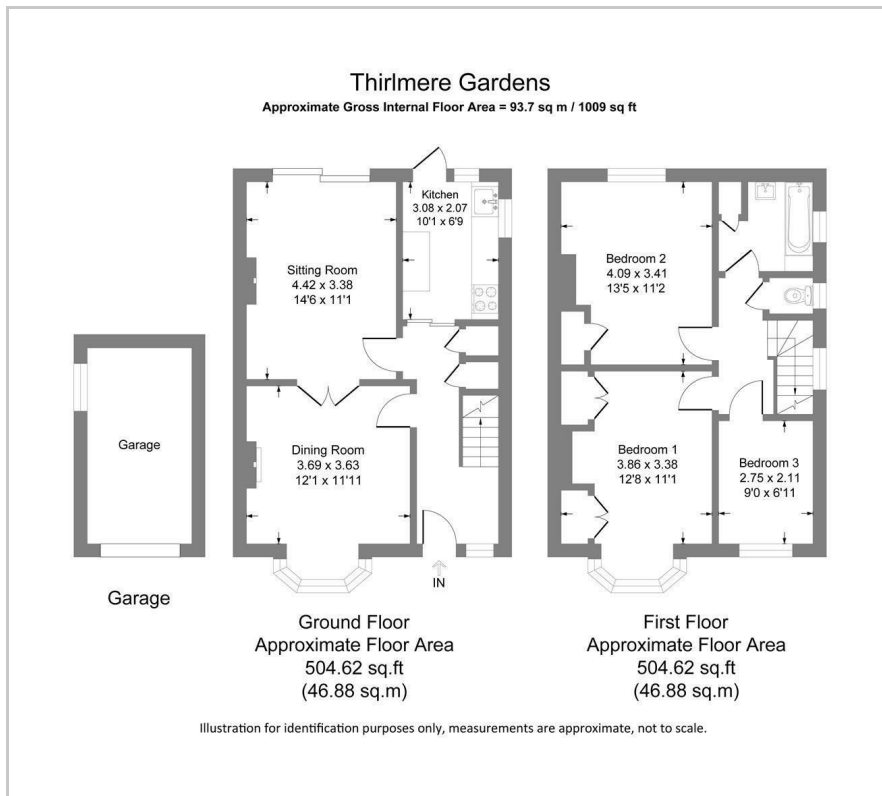

# Area Map

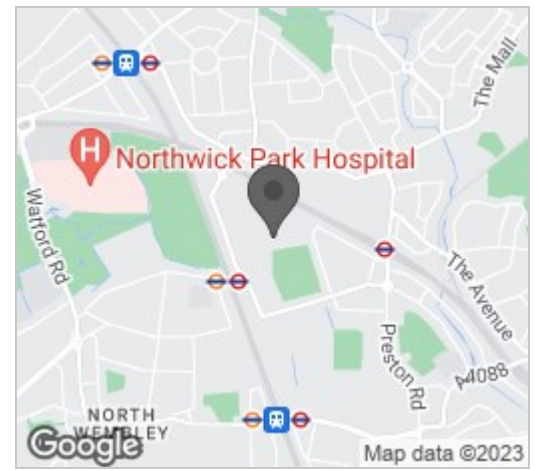

# Energy Efficiency Graph

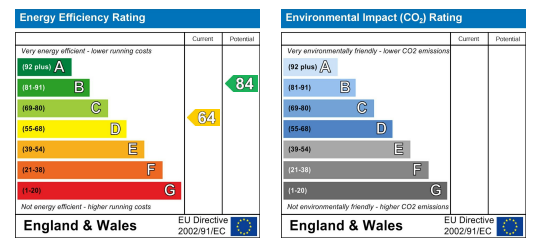

These particulars, whilst believed to be accurate are set out as a general outline only for guidance and do not constitute any part of an offer or contract. Intending purchasers should not rely on them as statements of representation of fact, but must satisfy themselves by inspection or otherwise as to their accuracy. No person in this firm's employment has the authority to make or give any representation or warranty in respect of the property.

