



See More Online

# KFB: Key Facts For Buyers

A Guide to This Property & the Local Area

**Monday 15<sup>th</sup> July 2024**

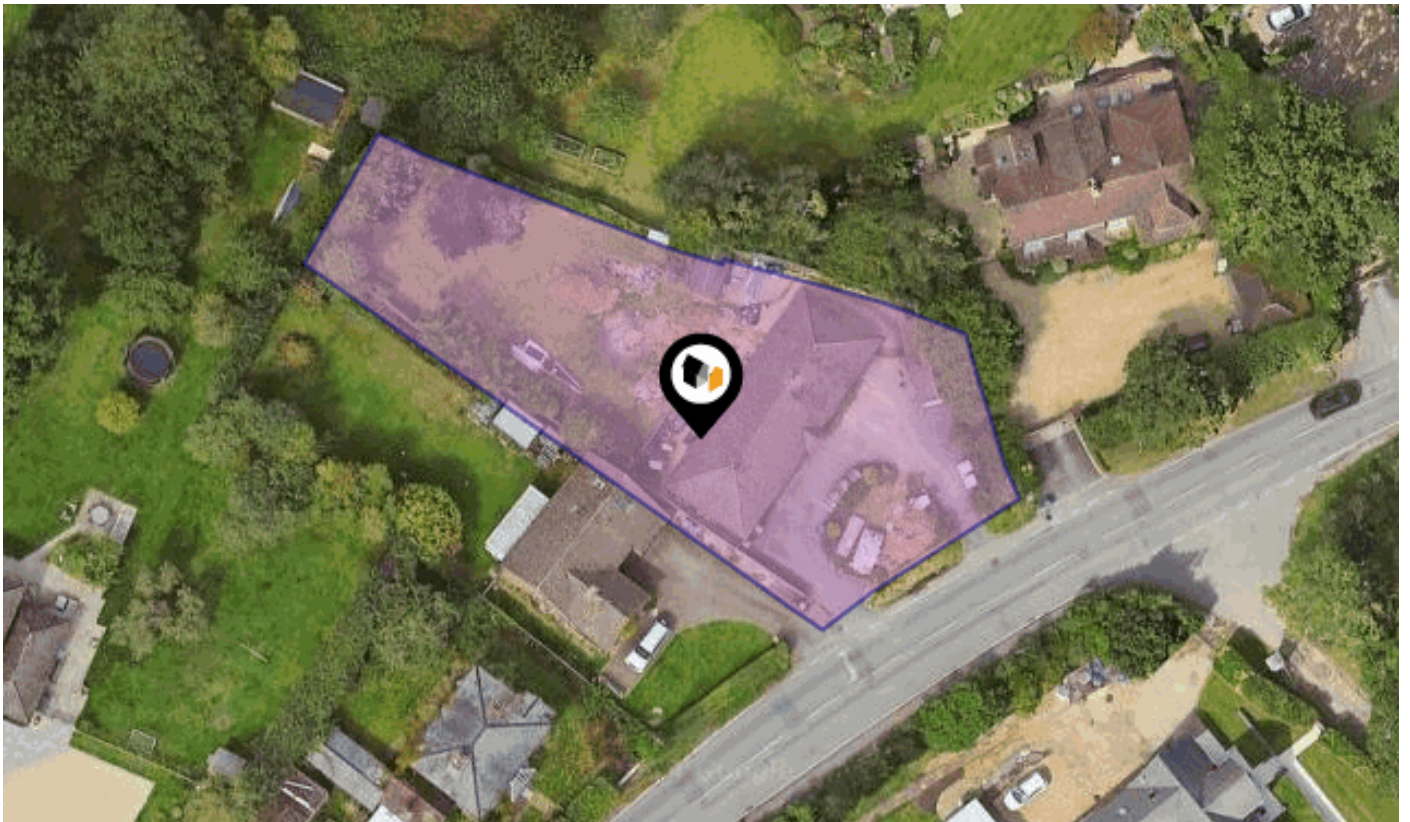

**EL MINA, TERRACE ROAD NORTH, BINFIELD, BRACKNELL,  
RG42 5PG**

**Avocado Property**

07519 024 359

[matt.m@avocadopropertyagents.co.uk](mailto:matt.m@avocadopropertyagents.co.uk)

[www.avocadopropertyagents.co.uk](http://www.avocadopropertyagents.co.uk)



Powered by  
**aprift**  
Know any property instantly

# Property Overview

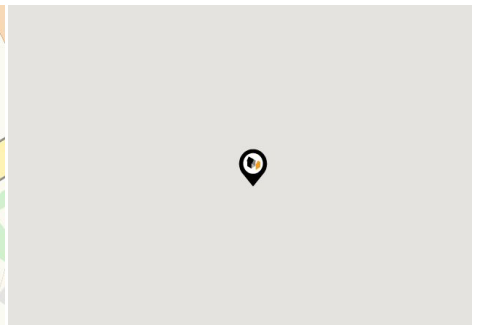

## Property

<b>Type:</b>	Detached	<b>Last Sold Date:</b>	22/05/2023
<b>Bedrooms:</b>	4	<b>Last Sold Price:</b>	£691,500
<b>Floor Area:</b>	1,442 ft <sup>2</sup> / 134 m <sup>2</sup>	<b>Last Sold £/ft<sup>2</sup>:</b>	£479
<b>Plot Area:</b>	0.29 acres	<b>Tenure:</b>	Freehold
<b>Year Built :</b>	1997		
<b>Council Tax :</b>	Band E		
<b>Annual Estimate:</b>	£2,507		
<b>Title Number:</b>	BK64416		
<b>UPRN:</b>	100081015853		

## Local Area

<b>Local Authority:</b>	Bracknell forest
<b>Conservation Area:</b>	No
<b>Flood Risk:</b>	
• Rivers & Seas	No Risk
• Surface Water	Low

### Estimated Broadband Speeds (Standard - Superfast - Ultrafast)

<b>4</b> mb/s	<b>170</b> mb/s	<b>1000</b> mb/s

### Mobile Coverage: (based on calls indoors)



### Satellite/Fibre TV Availability:



# Gallery Photos



# Gallery Photos



## EL MINA, TERRACE ROAD NORTH, BINFIELD, BRACKNELL, RG42 5PG

### El Mina, Terrace Road North, Binfield, Bracknell, RG42

Approximate Area = 1705 sq ft / 158.3 sq m (includes garage)

Outbuilding = 80 sq ft / 7.4 sq m

Total = 1785 sq ft / 165.8 sq m

For identification only - Not to scale

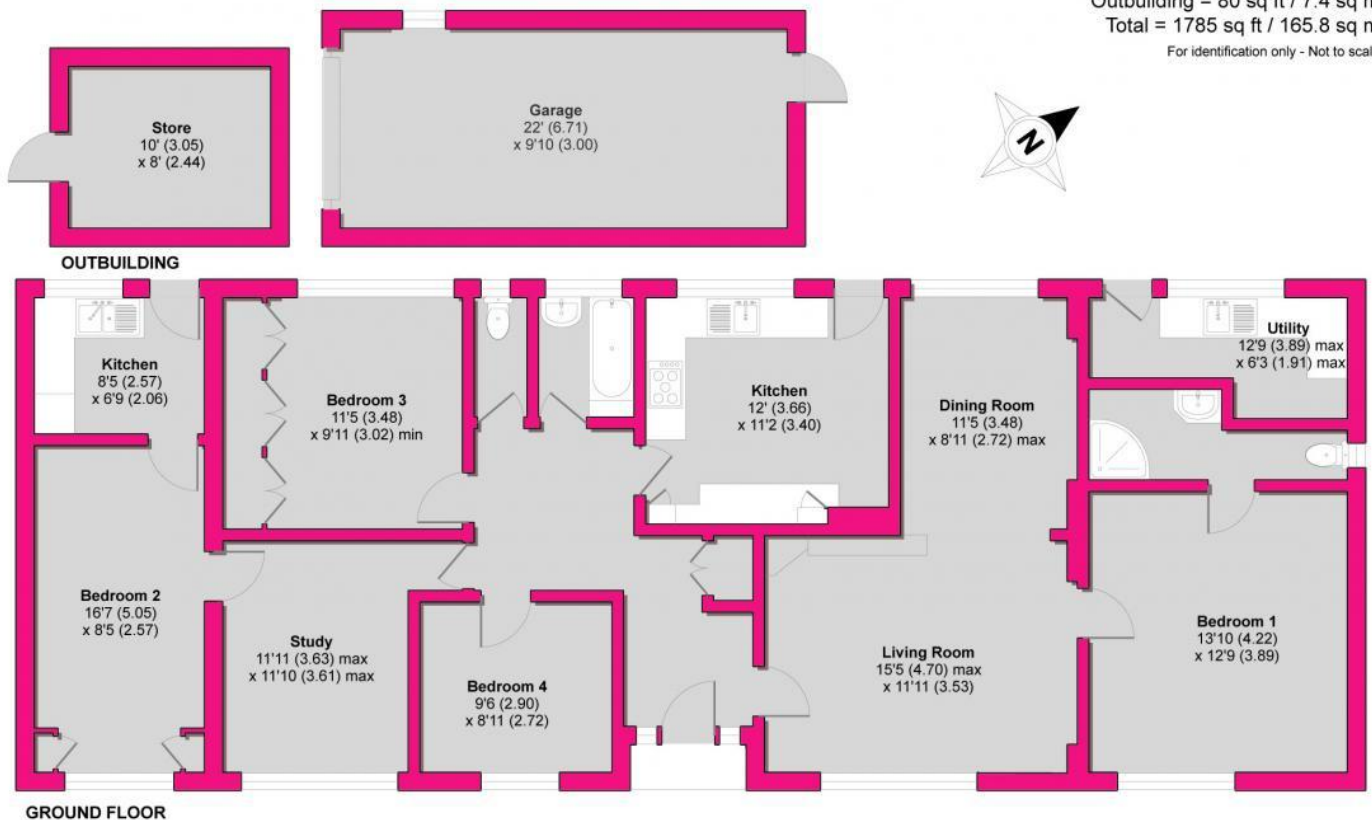

GROUND FLOOR



Floor plan produced in accordance with RICS Property Measurement Standards incorporating International Property Measurement Standards (IPMS2 Residential). © nichecom 2022. Produced for David Cliff. REF: 833331

# Property EPC - Certificate



El Mina, Terrace Road North, Binfield, BRACKNELL,  
RG42 5PG

Energy rating  
**D**

Valid until 11.04.2032

Certificate number  
4732-6324-1100-0229-5296

Score	Energy rating	Current	Potential
92+	A		
81-91	B		83   B
69-80	C		
55-68	D	64   D	
39-54	E		
21-38	F		
1-20	G		

# Area Schools

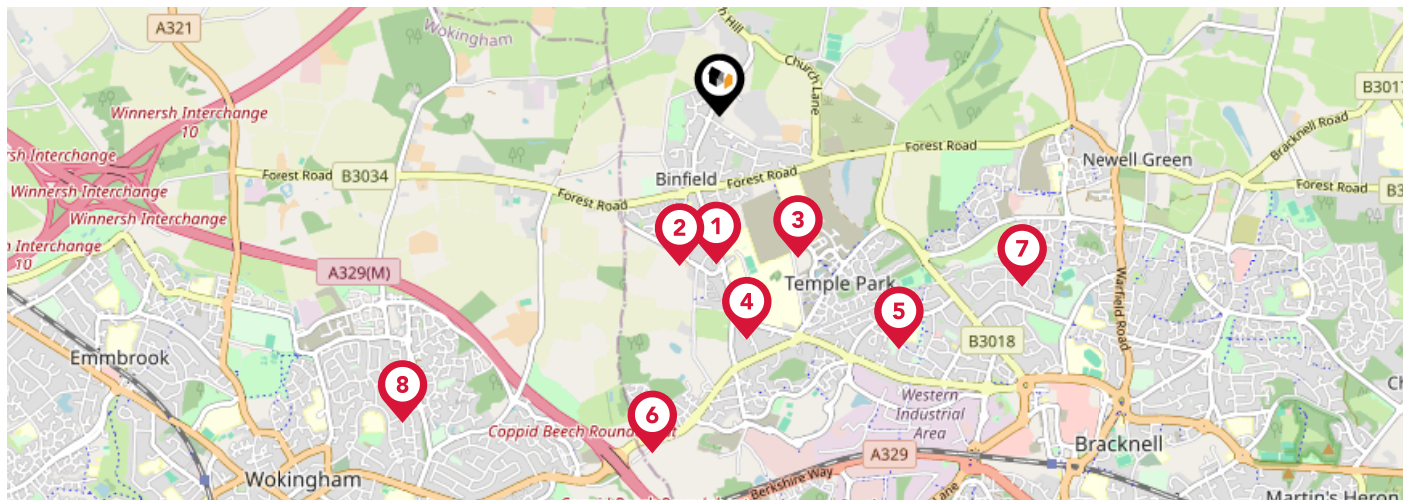

	Nursery	Primary	Secondary	College	Private
<p><b>1</b> <b>Cressex Lodge (SWAAY)</b> Ofsted Rating: Good   Pupils: 18   Distance:0.68</p>	<input type="checkbox"/>	<input type="checkbox"/>	<input checked="" type="checkbox"/>	<input type="checkbox"/>	<input type="checkbox"/>
<p><b>2</b> <b>Binfield Church of England Primary School</b> Ofsted Rating: Good   Pupils: 407   Distance:0.71</p>	<input type="checkbox"/>	<input checked="" type="checkbox"/>	<input type="checkbox"/>	<input type="checkbox"/>	<input type="checkbox"/>
<p><b>3</b> <b>King's Academy Binfield</b> Ofsted Rating: Not Rated   Pupils: 322   Distance:0.75</p>	<input type="checkbox"/>	<input checked="" type="checkbox"/>	<input checked="" type="checkbox"/>	<input type="checkbox"/>	<input type="checkbox"/>
<p><b>4</b> <b>Newbold</b> Ofsted Rating: Good   Pupils: 67   Distance:1.04</p>	<input type="checkbox"/>	<input checked="" type="checkbox"/>	<input type="checkbox"/>	<input type="checkbox"/>	<input type="checkbox"/>
<p><b>5</b> <b>Meadow Vale Primary School</b> Ofsted Rating: Good   Pupils: 647   Distance:1.36</p>	<input type="checkbox"/>	<input checked="" type="checkbox"/>	<input type="checkbox"/>	<input type="checkbox"/>	<input type="checkbox"/>
<p><b>6</b> <b>King's Academy Oakwood</b> Ofsted Rating: Not Rated   Pupils: 50   Distance:1.59</p>	<input type="checkbox"/>	<input checked="" type="checkbox"/>	<input type="checkbox"/>	<input type="checkbox"/>	<input type="checkbox"/>
<p><b>7</b> <b>Kennel Lane School</b> Ofsted Rating: Good   Pupils: 195   Distance:1.6</p>	<input type="checkbox"/>	<input type="checkbox"/>	<input checked="" type="checkbox"/>	<input type="checkbox"/>	<input type="checkbox"/>
<p><b>8</b> <b>Foundry College</b> Ofsted Rating: Good   Pupils: 23   Distance:2.04</p>	<input type="checkbox"/>	<input type="checkbox"/>	<input checked="" type="checkbox"/>	<input type="checkbox"/>	<input type="checkbox"/>

# Area Schools

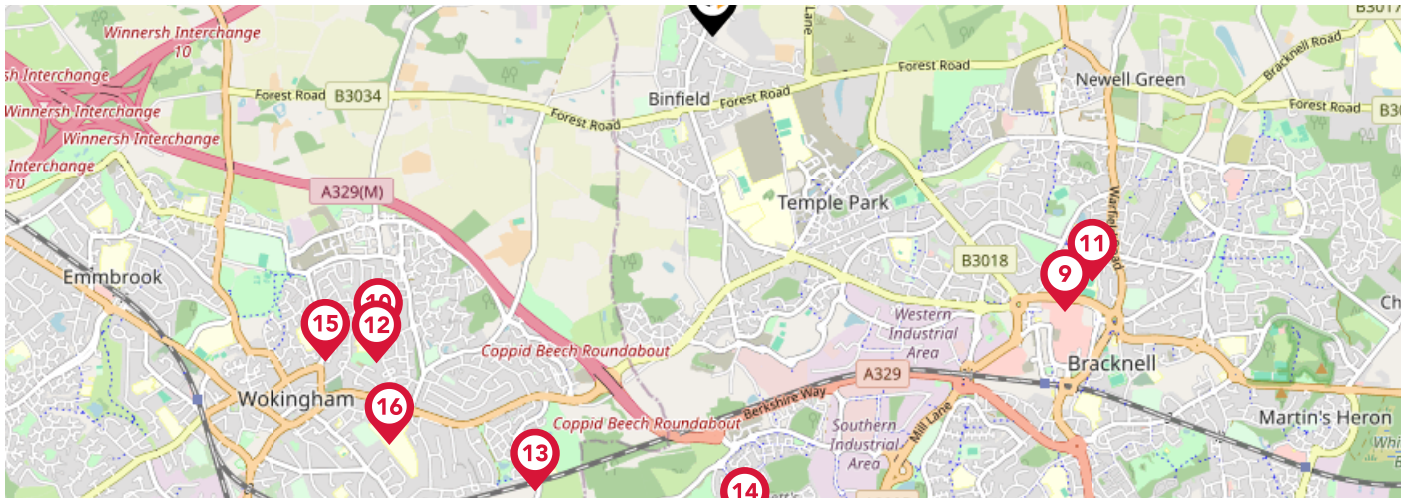

	Nursery	Primary	Secondary	College	Private
<p><b>9</b> <b>Garth Hill College</b></p> <p>Ofsted Rating: Good   Pupils: 1528   Distance:2.07</p>	<input type="checkbox"/>	<input type="checkbox"/>	<input checked="" type="checkbox"/>	<input type="checkbox"/>	<input type="checkbox"/>
<p><b>10</b> <b>Keep Hatch Primary School</b></p> <p>Ofsted Rating: Good   Pupils:0   Distance:2.09</p>	<input type="checkbox"/>	<input checked="" type="checkbox"/>	<input type="checkbox"/>	<input type="checkbox"/>	<input type="checkbox"/>
<p><b>11</b> <b>Sandy Lane Primary School</b></p> <p>Ofsted Rating: Good   Pupils: 501   Distance:2.09</p>	<input type="checkbox"/>	<input checked="" type="checkbox"/>	<input type="checkbox"/>	<input type="checkbox"/>	<input type="checkbox"/>
<p><b>12</b> <b>All Saints CofE (Aided) Primary School</b></p> <p>Ofsted Rating: Good   Pupils: 305   Distance:2.17</p>	<input type="checkbox"/>	<input checked="" type="checkbox"/>	<input type="checkbox"/>	<input type="checkbox"/>	<input type="checkbox"/>
<p><b>13</b> <b>Floreat Montague Park Primary School</b></p> <p>Ofsted Rating: Requires Improvement   Pupils: 238   Distance:2.26</p>	<input type="checkbox"/>	<input checked="" type="checkbox"/>	<input type="checkbox"/>	<input type="checkbox"/>	<input type="checkbox"/>
<p><b>14</b> <b>Jennett's Park CofE Primary School</b></p> <p>Ofsted Rating: Good   Pupils: 441   Distance:2.29</p>	<input type="checkbox"/>	<input checked="" type="checkbox"/>	<input type="checkbox"/>	<input type="checkbox"/>	<input type="checkbox"/>
<p><b>15</b> <b>High Close School</b></p> <p>Ofsted Rating: Good   Pupils: 79   Distance:2.34</p>	<input type="checkbox"/>	<input type="checkbox"/>	<input checked="" type="checkbox"/>	<input type="checkbox"/>	<input type="checkbox"/>
<p><b>16</b> <b>St Crispin's School</b></p> <p>Ofsted Rating: Good   Pupils: 1181   Distance:2.41</p>	<input type="checkbox"/>	<input type="checkbox"/>	<input checked="" type="checkbox"/>	<input type="checkbox"/>	<input type="checkbox"/>



# Area Transport (National)

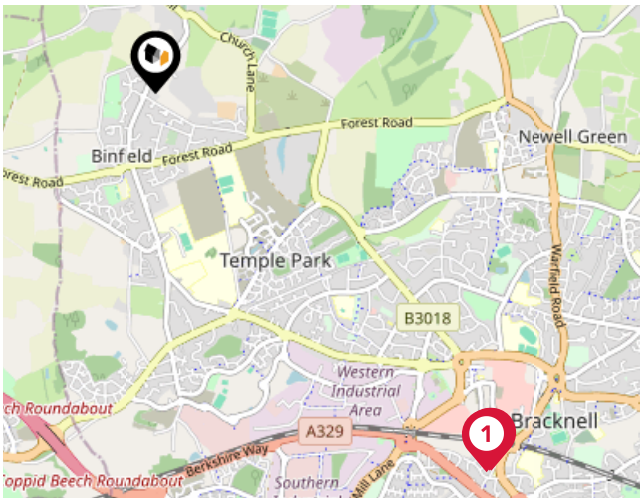

## National Rail Stations

Pin	Name	Distance
1	Bracknell Rail Station	2.33 miles
2	Bracknell Rail Station	2.33 miles
3	Bracknell Rail Station	2.34 miles

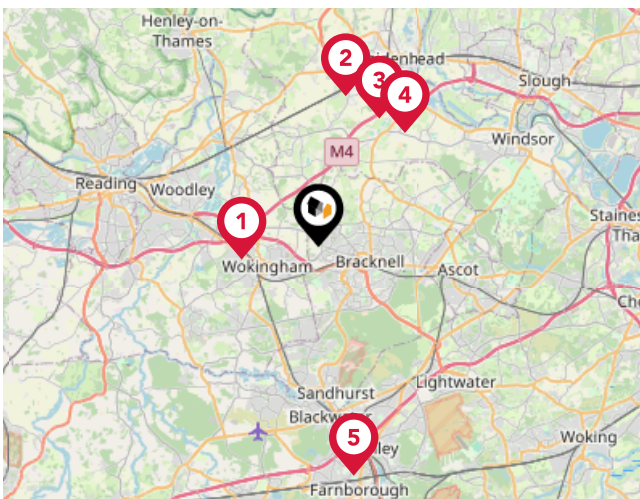

## Trunk Roads/Motorways

Pin	Name	Distance
1	M4 J10	2.91 miles
2	A404(M) J9	5.66 miles
3	A404(M) J9A	5.27 miles
4	M4 J8	5.28 miles
5	M3 J4	8.56 miles

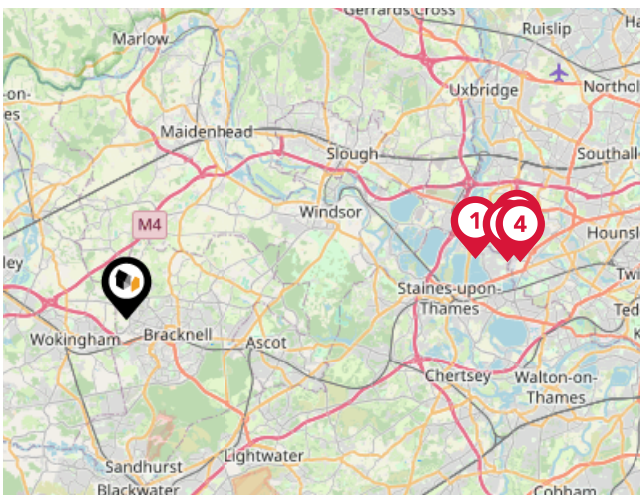

## Airports/Helipads

Pin	Name	Distance
1	London Heathrow Airport Terminal 5	13.11 miles
2	London Heathrow Airport Terminal 3	14.23 miles
3	London Heathrow Airport	14.65 miles
4	London Heathrow Airport Terminal 2	14.68 miles

# Area

## Transport (Local)

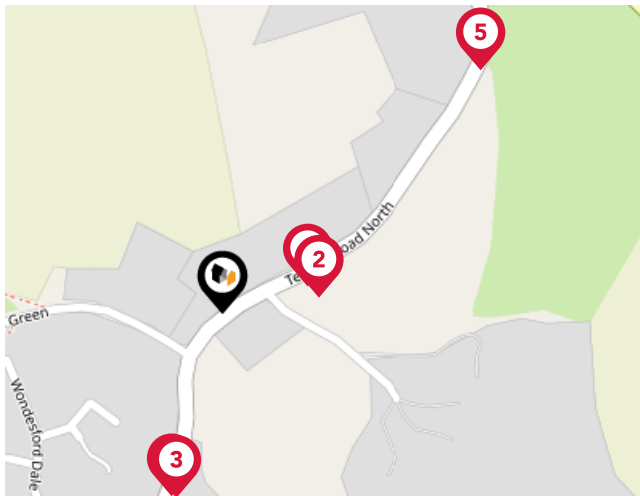

### Bus Stops/Stations

Pin	Name	Distance
1	Terrace Road North H & R 3	0.05 miles
2	Terrace Road North H & R 3	0.06 miles
3	Terrace Road North H & R 2	0.11 miles
4	Terrace Road North H & R 2	0.11 miles
5	Terrace Road North H & R 4	0.21 miles

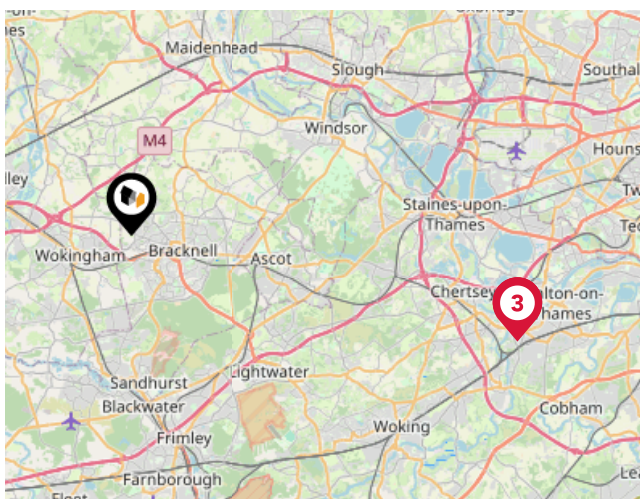

### Ferry Terminals

Pin	Name	Distance
1	Shepperton Ferry Landing	14.78 miles
2	Shepperton Ferry Landing	14.78 miles
3	Weybridge Ferry Landing	14.81 miles

# Market

## House Price Statistics



10 Year History of Average House Prices by Property Type in RG42

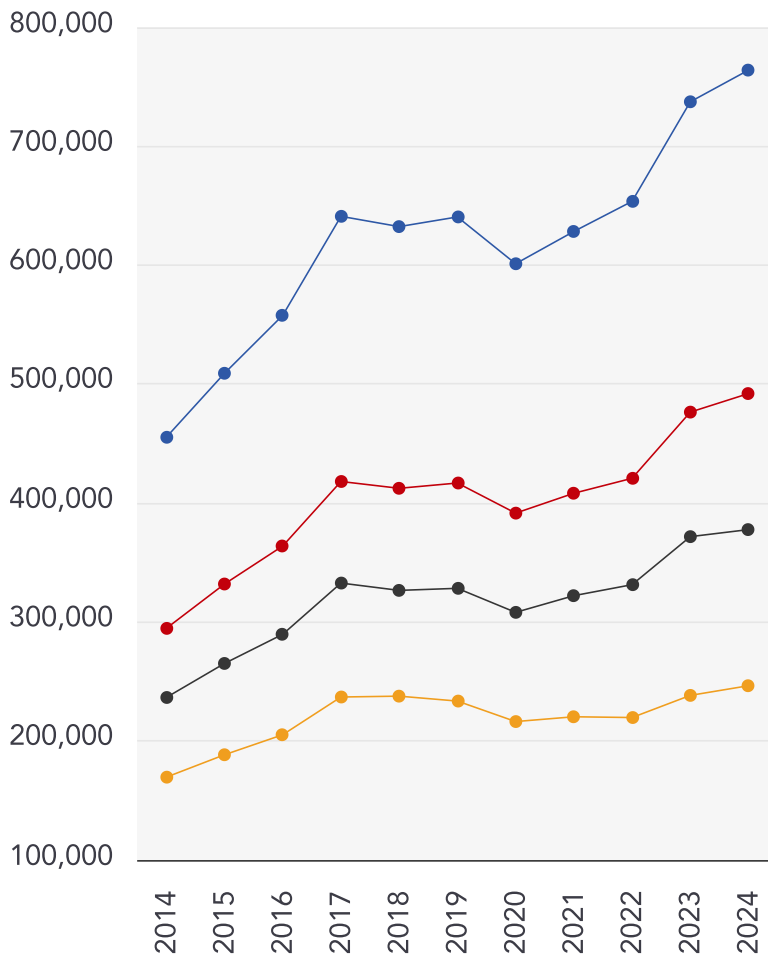

Detached

**+67.78%**

Semi-Detached

**+66.97%**

Terraced

**+59.63%**

Flat

**+45.31%**

# Avocado Property

## About Us



### Avocado Property

---

We are proud to be different, we want to create a legacy as the business that positively disrupted the industry and challenged the estate agent status quo.

Our clients all get direct access to business partners who live locally and are part of their local community. We work with local businesses to help promote their companies free of charge and we give back to teachers, nurses and armed forces servicemen/women.

We are passionate about changing the industry, passionate about helping people move on to the next chapter in their lives and passionate about property.

# Avocado Property

## Data Quality

We are committed to comprehensive property data being made available upfront to make the home buying and selling process quicker, easier and cheaper. This is why we have partnered with Sprift, the UK's leading supplier of property-specific data.



### Contains public sector information licensed under the Open Government License v3.0

The information contained within this report is for general information purposes only and to act as a guide to the best way to market your property for the asking price.

Sprift Technologies Ltd aggregate this data from a wide variety of sources and while we endeavour to keep the information up to date and correct, we make no representations or warranties of any kind, express or implied, about the completeness, accuracy, reliability, of the information or related graphics contained within this report for any purpose.

Any reliance you place on such information is therefore strictly at your own risk. In no event will we be liable for any loss or damage including without limitation, indirect or consequential loss or damage, or any loss or damage whatsoever arising from loss of data or profits arising out of, or in connection with, the use of this report.



### Avocado Property

07519 024 359

[matt.m@avocadopropertyagents.co.uk](mailto:matt.m@avocadopropertyagents.co.uk)

[www.avocadopropertyagents.co.uk](http://www.avocadopropertyagents.co.uk)

