

The  
Bottle  
Factory

12 Ossory Road  
SE1 5AN

**Fabrix**

51.517947 - 0.134859





# A new creative campus for SE1

A variety of spaces available from 126 sq ft





makers **fashionistas** distillers  
**designers** filmmakers **djs** brewers  
**producers** branders **mixers**  
fixers **artists** advertisers **roasters**  
creators **directors** manufacturers  
photographers **coders**  
movers **shakers**

It's your turn  
to make it





# 32,200 sq ft workplace set within a 126-year-old bottle factory



Originally built in 1895 and occupied by the famous J Mills & Sons company, The Bottle Factory is a unique and historic working environment with architectural prowess connected to its industrial past.

A private gated campus with voluminous floors, the building is an ideal headquarters for occupiers with production and workplace requirements with plenty of outdoor space.



Overflowing  
with  
character

Ground  
Current  
layout





A sympathetic restoration has conceived a stunning space that inspires creativity and collaboration.





Original features are in abundance and are highlighted by natural light.

Vast floors and outside space make this a perfect working environment.

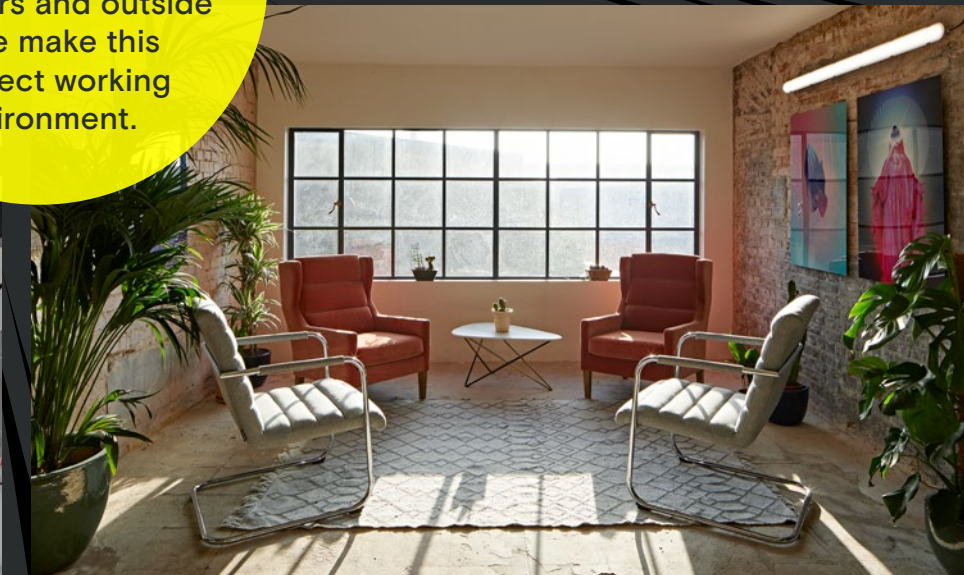
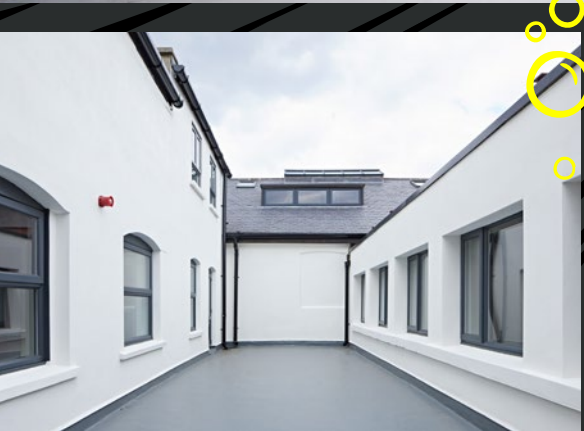

Roof Terrace

The Factory

	sq m	sq ft
First & The Loft	up to 1,161	12,501
Ground	up to 1,499	16,141
<b>Total</b>	<b>2,660</b>	<b>28,642</b>

The Bottle House

	sq m	sq ft
<b>Total</b>	<b>333</b>	<b>3,592</b>

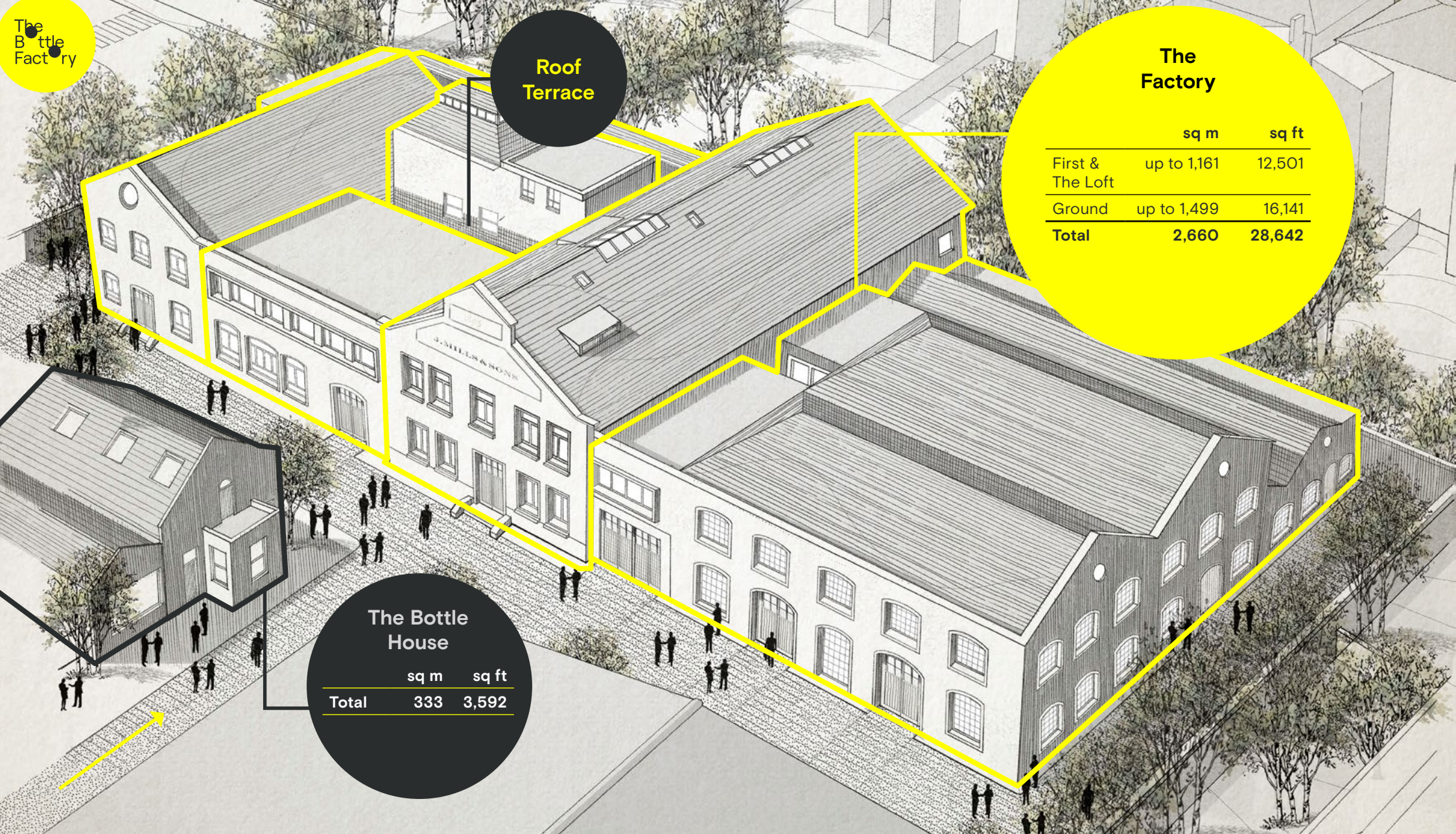





# Ground

Current  
layout





# Ground

Indicative open plan  
office fit-out



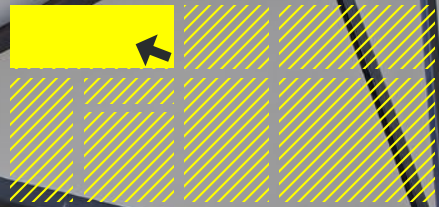

# Ground

Current  
layout





# Ground

Indicative  
e-commerce  
fit-out



# The Factory Ground

	sq m	sq ft
Unit 1	279	3,003
Unit 2	208	2,238
Unit 3	322	3,465
Unit 4	320	3,444
Unit 5	214	2,303
<b>Total available</b>	<b>1,343</b>	<b>14,453</b>

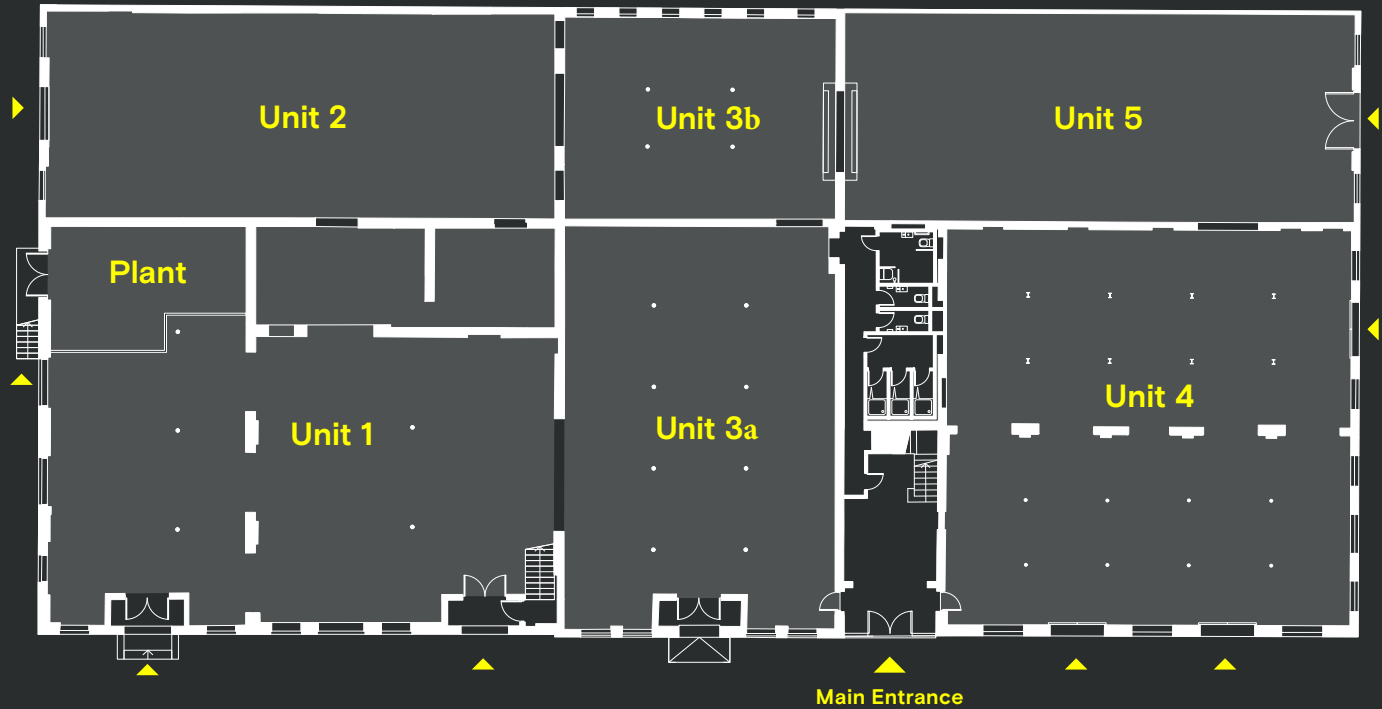

- Exposed brickwork
- Ceiling heights up to 5m
- 10 external doors for access and loading
- Original steel support beams
- Direct access to communal courtyard
- Openable windows
- Roller shutter security
- 3 phase power





**First**  
Current  
layout





POP

**First**  
Indicative fashion  
workshop fit-out



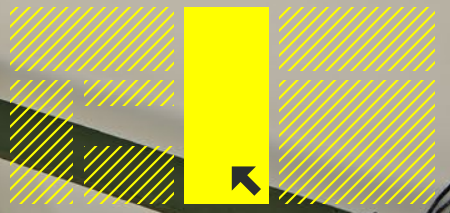

**First**  
Current  
layout







**First**  
Indicative open plan  
office fit-out



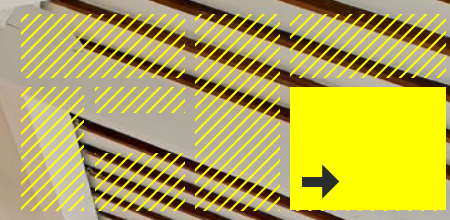

**First**  
Current  
layout





**First**  
Indicative open plan  
office fit-out



# The Factory First & The Loft

	sq m	sq ft
Studio 1	18	193
Studio 2	15	161
Studio 3	14	150
Studio 4	13	139
Studio 5	18	193
Studio 6	39	419
Studio 7	31	333
Studio 8	31	333
Studio 9	22	236
Unit 8	337	3,627
Unit 9	161	1,732
Unit 10	146	1,571
<b>Total available</b>	<b>845</b>	<b>9,095</b>

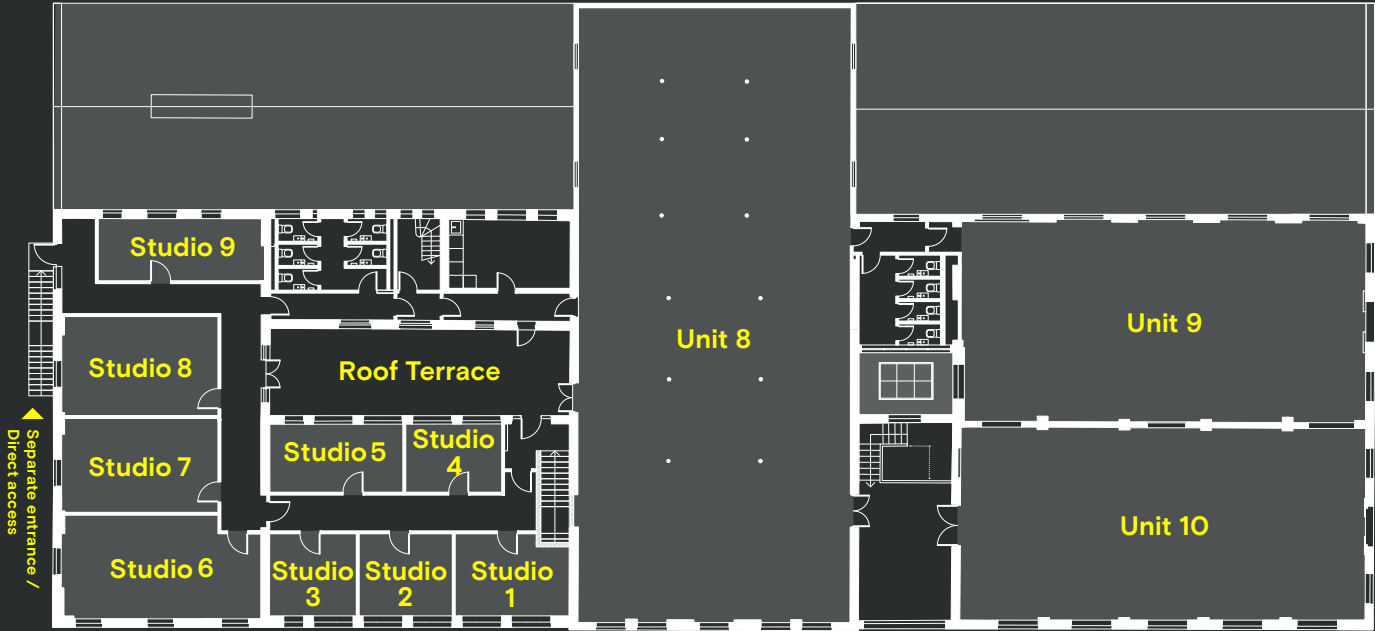

Natural daylight throughout

Ceiling heights up to 5m

Private roof terrace

Openable windows

Options for mezzanine





# The Bottle House Ground & First

	sq m	sq ft
The Bottle House	333	3,592
<b>Total available</b>	<b>333</b>	<b>3,592</b>



Exposed brickwork throughout



Openable windows



Direct access to communal courtyard



Natural daylight throughout

## Ground floor

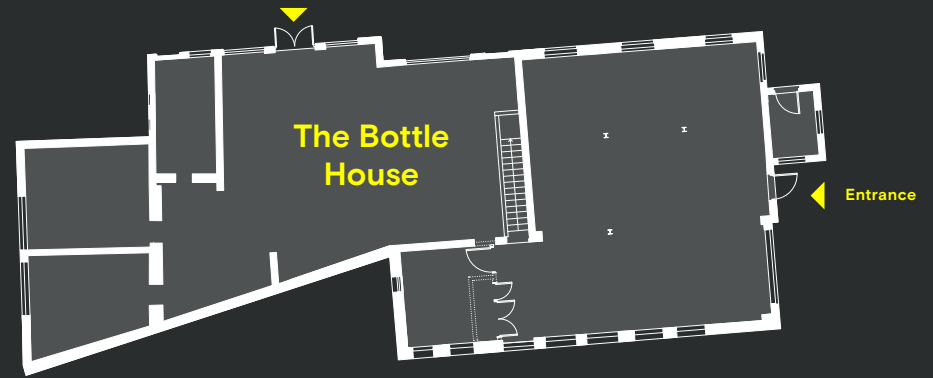

## First floor

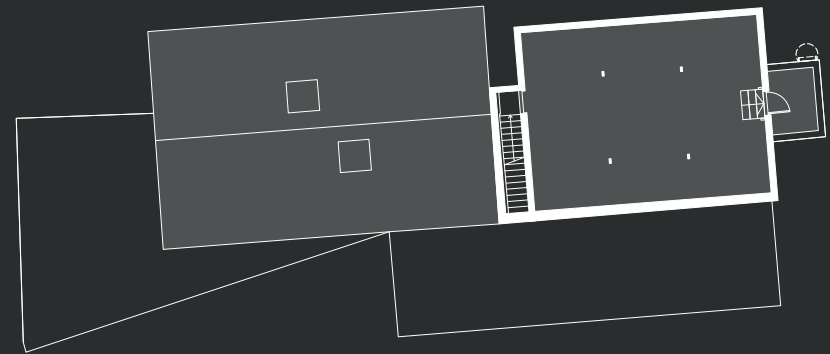

**SE1**  
has grown into one of London's most creative neighbourhoods

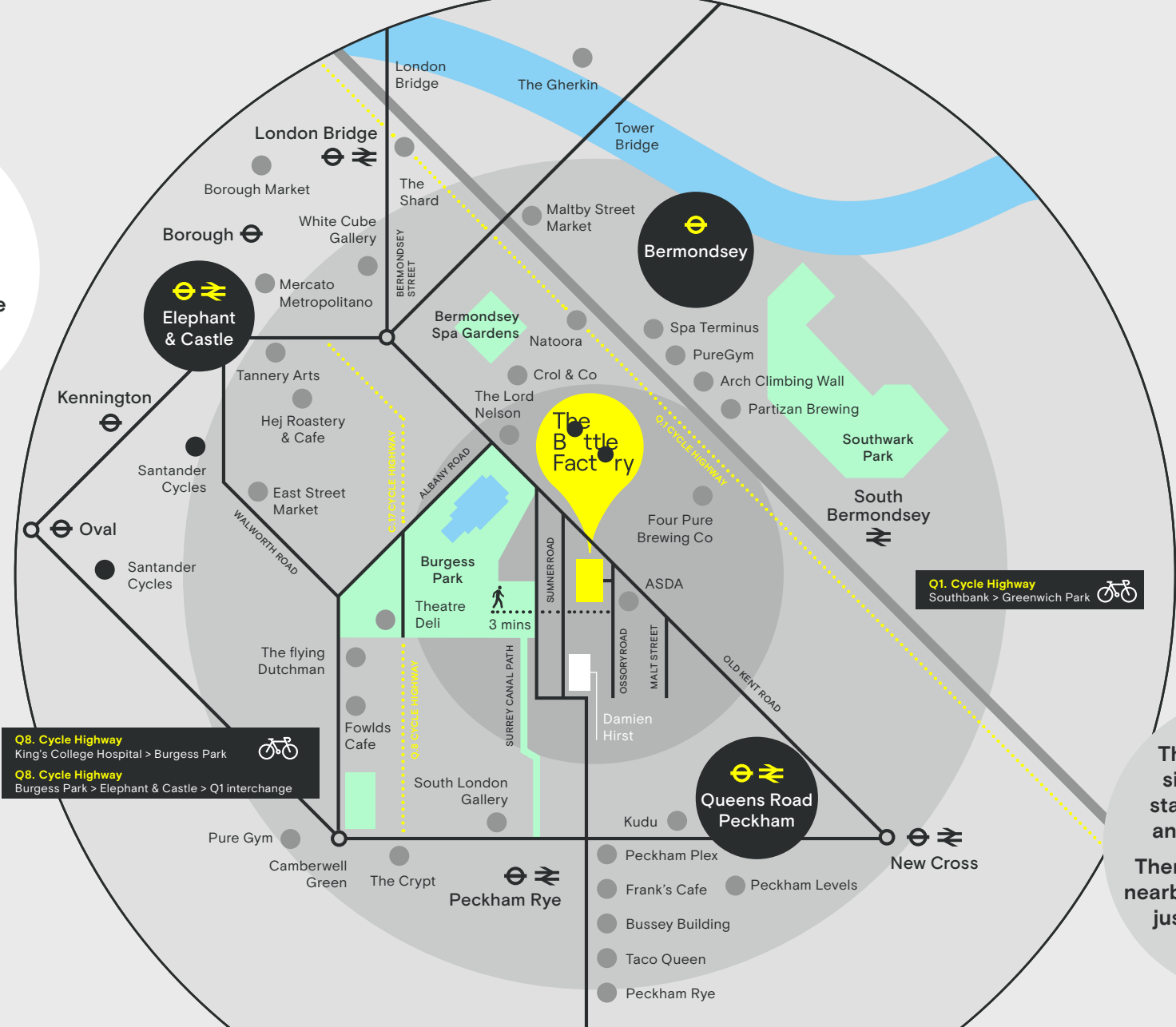

**Q8. Cycle Highway**  
King's College Hospital > Burgess Park

**Q8. Cycle Highway**  
Burgess Park > Elephant & Castle > Q1 interchange

**Q1. Cycle Highway**  
Southbank > Greenwich Park

The Bottle Factory sits amongst tube stations, rail stations and cycle highways.

There are green spaces nearby with Burgess Park just a 3 minute walk

The Bottle Factory

Peckham Rye

Queens Road Peckham

Bermondsey

Elephant & Castle

# Bubbling with energy

Maltby Street Market ▼



Peckham Levels ▲



Bussey Building Rooftop ▼



Frank's Café ▼

Burgess Park ▲

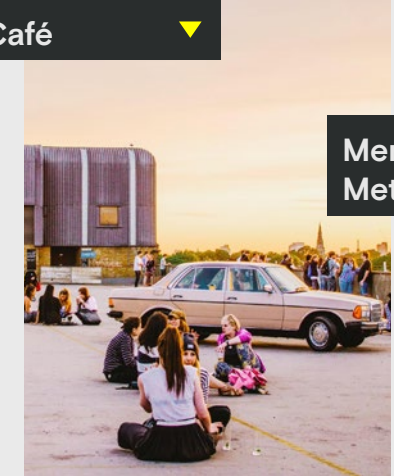

Mercato Metropolitano ▲





# Connected

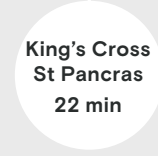
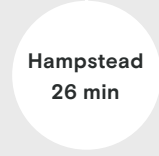
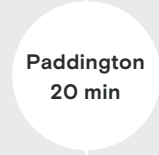
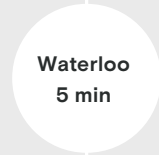
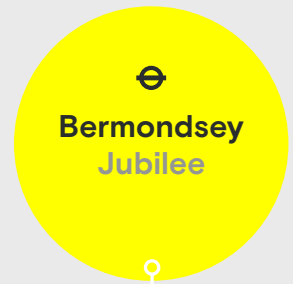
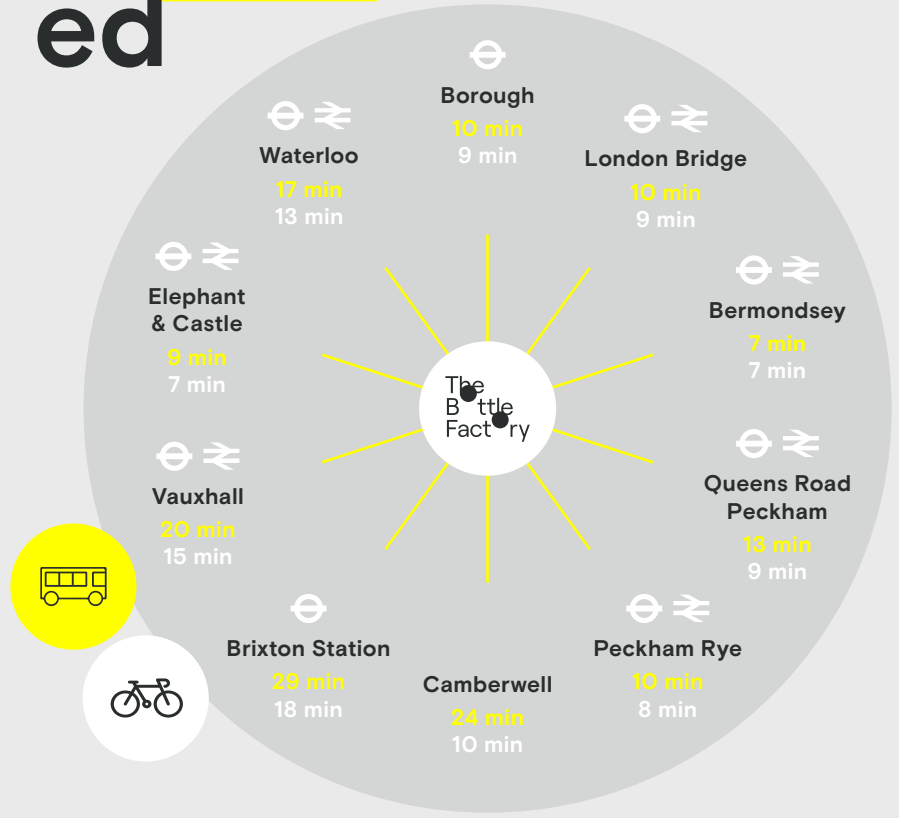





The Bottle Factory is packed with features that make this a truly unique work environment

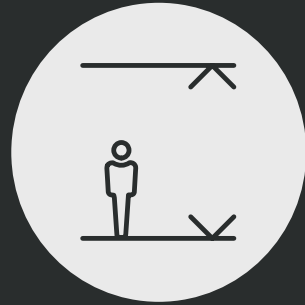

Up to 5m high ceilings

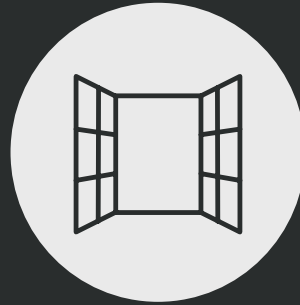

Openable windows

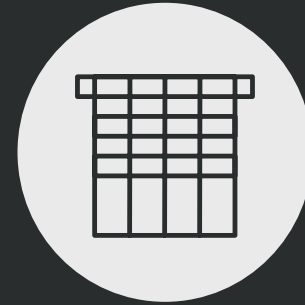

Gated campus entrance



Private roof terrace



Onsite parking



3 phase power

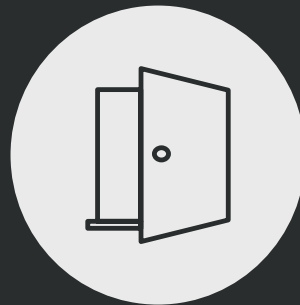

10 external doors for access and loading

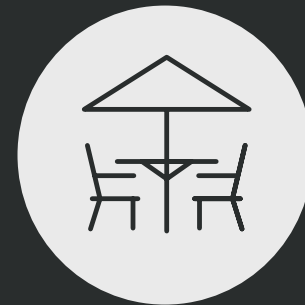

Access to communal courtyard

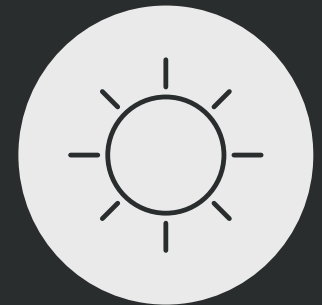

Natural daylight throughout

# It all started with a fizz

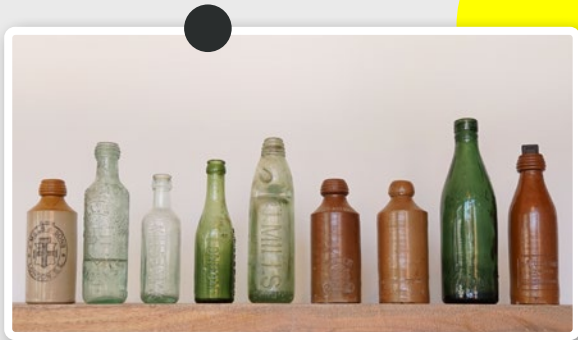
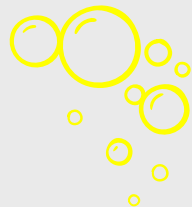

2020  
Fabrix trademarks  
J.Mills & Sons, relaunching  
a 126-year-old brand

1895  
Construction is completed  
on the original footprint of  
the building

1903  
Patent applied for the  
famous Beehive bottle cap

1964–2019  
During this time the property  
fell into various hands, laying  
vacant for a number of years  
and falling into disrepair



It's your turn  
to make it



## Fabrix

2019  
Fabrix acquires the site, saving  
the buildings from demolition



1890  
J. Mills applies for  
the trademark of the  
Spechàla brand name



1897  
Production of  
sparkling water begins  
at 12 Ossory Road

1903  
Work is completed on  
the new warehousing either  
side of the original grand  
'shop front' façade  
  
The stables are removed and  
new ancillary space added



1964  
The gates close for the last  
time at J.Mills & Sons



1890

1897

1903

1964

2019



#### Simon Higgins

T. +44 (0)20 7747 0130  
M. +44 (0)7976 266 608  
E. [simon.higgins@levyrealestate.co.uk](mailto:simon.higgins@levyrealestate.co.uk)

#### Vincent Cheung

T. +44 (0)20 3757 8571  
M. +44 (0)7736 880 310  
E. [vc@unionstreetpartners.co.uk](mailto:vc@unionstreetpartners.co.uk)

#### Rob Watts

T. +44 (0)20 7747 0152  
M. +44 (0)7506 441 644  
E. [rob.watts@levyrealestate.co.uk](mailto:rob.watts@levyrealestate.co.uk)

#### Luke Austerberry

T. +44 (0)20 3757 8579  
M. +44 (0)7921 406 291  
E. [la@unionstreetpartners.co.uk](mailto:la@unionstreetpartners.co.uk)

#### Meg Carr

T. +44 (0)20 7747 0143  
M. +44 (0)7896 899 798  
E. [megan.carr@levyrealestate.co.uk](mailto:megan.carr@levyrealestate.co.uk)

#### Alex Jackson

T. +44 (0)20 3757 8564  
M. +44 (0)7562 649 126  
E. [aj@unionstreetpartners.co.uk](mailto:aj@unionstreetpartners.co.uk)

Subject to contract. Levy Real Estate and Union Street Partners for themselves and the vendor of this property give notice that these particulars do not form, or form part of, any offer or contract. They are intended to give fair description of the property and whilst every effort has been made to ensure their accuracy this cannot be guaranteed. Any intending purchaser must therefore satisfy themselves by inspection or otherwise, Levy Real Estate and Union Street Partners, nor any of its employees, has any authority to make or give any further representations or warranty whatsoever in relation to this property. November 2023. SO13016.

Siren | 020 7478 8300 | [sirendesign.co.uk](http://sirendesign.co.uk)

For more information visit

 [thebottlefactory](https://www.instagram.com/thebottlefactory)

[thebottlefactory.london](https://www.thebottlefactory.london)

**Fabrix**

51.517947 - 0.134859