



The
**Property
Selling**
company™

Tel 0800 111 4118

Email hello@thepropertysellingcompany.co.uk

Web www.thepropertysellingcompany.co.uk

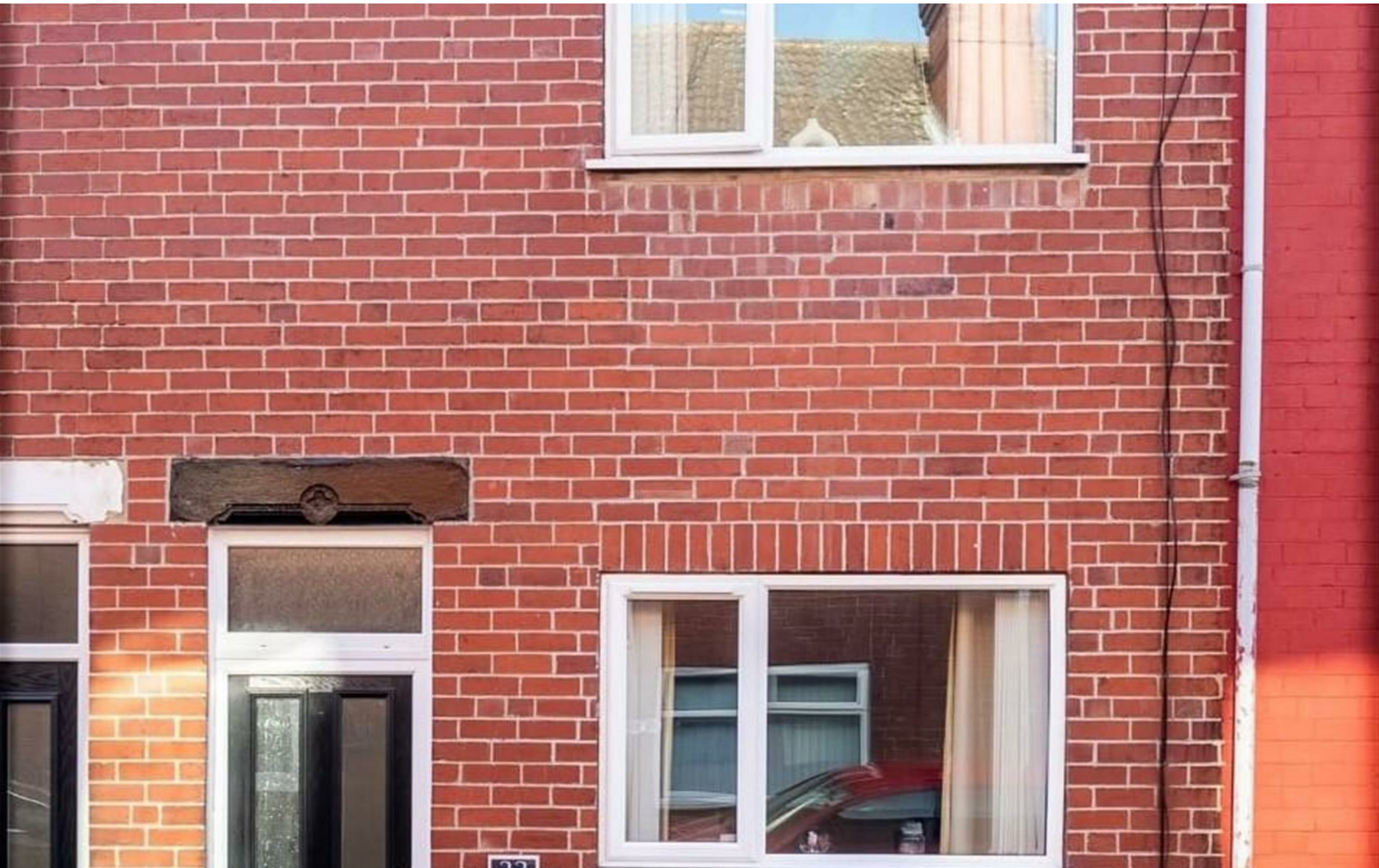

33 Regent Street, Hemsworth, WF9 4QJ **Offers over £112,500**

Welcome to this charming mid-terrace house located on the prestigious Regent Street in Hemsworth. This delightful property boasts a cosy reception room, perfect for relaxing or entertaining guests. With two comfortable bedrooms, there is ample space for a small family or guests to stay over. The property also features a well-maintained bathroom, adding convenience to your daily routine.

Built in 1900, this house exudes character and history, offering a unique living experience. Spanning across 764 sq ft, there is plenty of room to make this house your own and create a warm and inviting atmosphere. The location on Regent Street provides a sense of community and is within easy reach of local amenities, making it a convenient place to call home.

Don't miss out on the opportunity to own this lovely property in the heart of Hemsworth. Whether you're looking for a cozy home for yourself or an investment opportunity, this mid-terrace house has the potential to become your perfect abode. Contact us today to arrange a viewing and take the first step towards making this house your new home.



GROUND FLOOR
379 sq.ft. (35.2 sq.m.) approx.

1ST FLOOR
355 sq.ft. (33.0 sq.m.) approx.

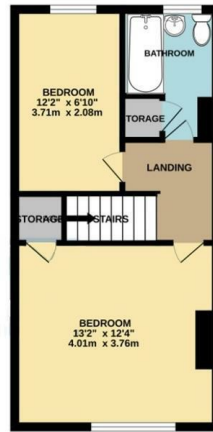
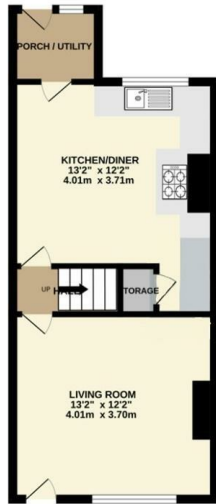

TWO BEDROOM MID TERRACE HOUSE
TOTAL FLOOR AREA: 734 sq.ft. (68.2 sq.m.) approx.
While every attempt has been made to ensure the accuracy of the floorplan contained herein, measurements of floors, walls, etc., cannot be taken and are approximate and are responsibility is solely for any error involved in the floorplans. The plan is for information purposes only. The intended use should be for the prospective purchaser. The fixtures, systems and appliances shown herein have not been listed and are provided only for the prospective purchaser's reference.
Made with floorplan 12024

