

The
**Property
Selling**
company™

Tel 0800 111 4118

Email hello@thepropertysellingcompany.co.uk

Web www.thepropertysellingcompany.co.uk



32 Doveridge Road, Burton-On-Trent, DE15 9GB **Offers over £319,999**

Welcome to this charming detached house located on Doveridge Road in Burton-On-Trent. This delightful property boasts two reception rooms, perfect for entertaining guests or simply relaxing with your loved ones. With four bedrooms and two bathrooms, there is ample space for the whole family to enjoy.

Built in 2000, this well-maintained house offers a generous 1,378 sq ft of living space, providing a comfortable and spacious environment for you to call home. The large garden is a wonderful feature, ideal for outdoor activities, gardening enthusiasts, or simply enjoying a cup of tea in the fresh air.

Situated in the picturesque town of Burton-On-Trent, this property offers a peaceful and serene setting while still being conveniently located near local amenities and transport links. Don't miss out on the opportunity to make this lovely house your new home in this charming British town.



Approx Gross Internal Area
121 sq m / 1303 sq ft

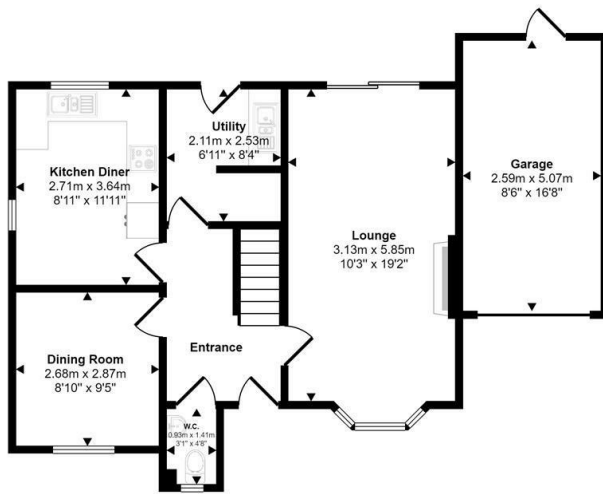

Ground Floor
Approx 66 sq m / 713 sq ft

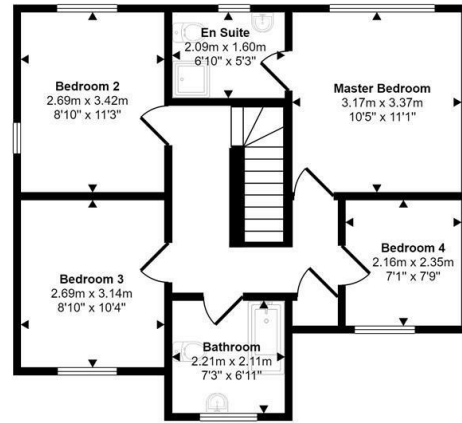

First Floor
Approx 55 sq m / 590 sq ft

Whilst every attempt has been made to ensure the accuracy of the floor plan contained here, measurements of doors, windows, rooms and any other items are approximate and no responsibility is taken for any error, omission, or mis-statement. The measurements should not be relied upon for valuation, transaction and/or funding purposes. This plan is for illustrative purposes only and should be used as such by any prospective purchaser or tenant.

- Beautiful detached property
- Solar panels are owned outright
- Four bedrooms
- Fantastic location - close to all local amenities and transport links
- Large garden
- Council tax - D

