



## 38 St. Michaels Walk

| Chelmsford | CM2 8SG

Offers over £179,999

Welcome to St. Michaels Walk, Chelmsford - a charming location that could be the perfect setting for your new home! This delightful apartment boasts a cosy reception room, ideal for relaxing or entertaining guests. With two bedrooms, there's plenty of space for a small family, guests, or even a home office. The property features a well-maintained bathroom, ensuring your comfort and convenience.

Situated in a building dating back to 1960, this apartment exudes character and history. Spanning 732 sq ft, there's ample room to make this space your own. Whether you're looking for a peaceful retreat or a vibrant city pad, this property offers a versatile canvas to create the home of your dreams.

Don't miss the opportunity to own a piece of Chelmsford's history in this lovely apartment on St. Michaels Walk. Book a viewing today and envision the endless possibilities this property holds for you!

Energy Efficiency Rating		Current	Potential
Very energy efficient - lower running costs			
(92 plus) A			
(81-91) B			
(69-80) C			
(55-68) D		65	77
(39-54) E			
(21-38) F			
(1-20) G			
Not energy efficient - higher running costs			
England & Wales		EU Directive 2002/91/EC	



# 38 St. Michaels Walk

## | Chelmsford | CM2 8SG

Offers over £179,999

### Sitting/Dining Room

15'8" x 11'3"

The well-spaced sitting/dining room features a side aspect window and laminated flooring.

### Kitchen

11'3" x 8'9"

The kitchen is fitted with storage cupboards and built-in utilities, including an oven, hob and extractor fan. The room is tiled throughout and also has a window allowing good natural light to fill the room.

### Bedroom 1

11'3" x 10'5"

This small double bedroom features attractive wall finishes, a window, carpeted flooring and built in storage space.

### Bedroom 2

9'7" x 7'4"

This single bedroom features a window, carpeted flooring and built in storage space.

### Bathroom

5'10" x 5'10"

The bathroom is equipped with toilet, wash hand basin and bath facilities. It has a window and the walls are tiled.

### Garden

The front door to the flat leads from the communal entrance lobby. The property shares a communal garden that is mostly covered in lawn and the entire area is enclosed with fencing, mature trees and shrubbery.

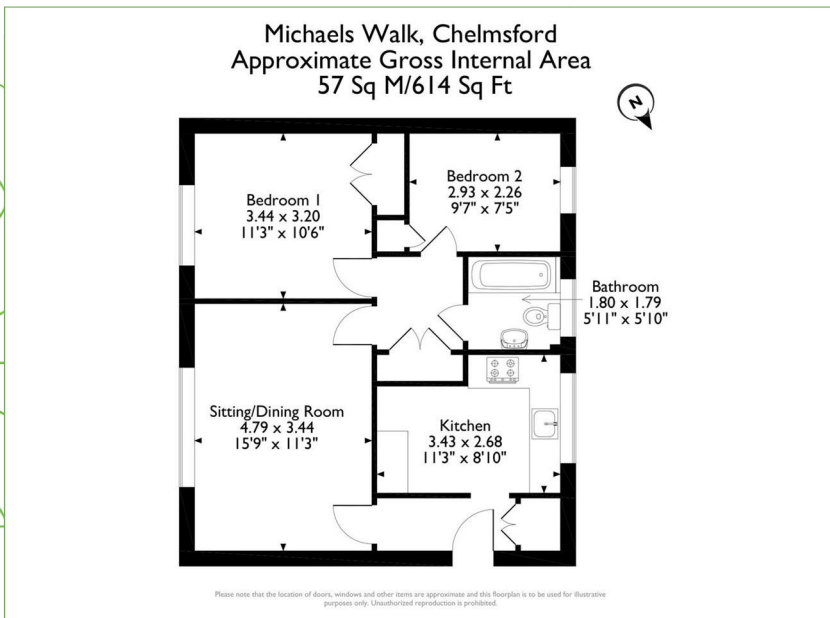

4 Deighton Cl, Wetherby LS22 7GZ  
t. 0800 111 4118  
e. hello@thepropertysellingcompany.co.uk  
w. www.thepropertysellingcompany.co.uk

