



29 Goldsmith Road

, London, SE15 5TF

£4,500 Per month

29 Goldsmith Road



Description

This furnished five double bedroom property is equally suited to sharers and students alike. Goldsmith Road is ideally situated for Queens Road and Peckham Rye overground stations with direct access to London Bridge, Victoria, Shoreditch and Clapham Junction and is a perfect location for students of Goldsmiths College, Camberwell School of Arts and Southbank University. There are several supermarkets close by including Morrisons, Asda, Sainsburys and Tesco. The house itself is in excellent condition and has five spacious bedrooms, open plan kitchen/living space and a shower room on the ground floor as well as a bathroom on the first floor. The outside space is great for relaxing or entertaining alike.

Excellent bus routes to Camberwell and New Cross are nearby and there is much to do locally with a plethora of independent bars, restaurants and delis close by.

This property comes furnished and is available from the 1st September 2025

- Two bathrooms
- Excellent transport links
- Abundance of local amenities
- Ideal for sharers, students or families
- Available from 1st September 2025
- Private Garden
- Furnished
- Communal living space
- Valid HMO License





Floor Plan

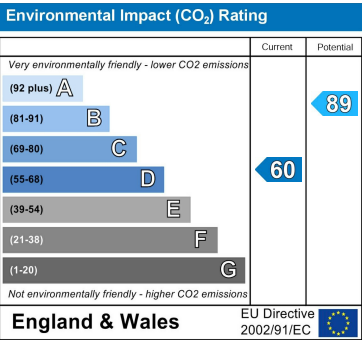
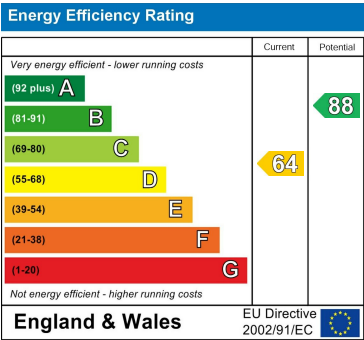
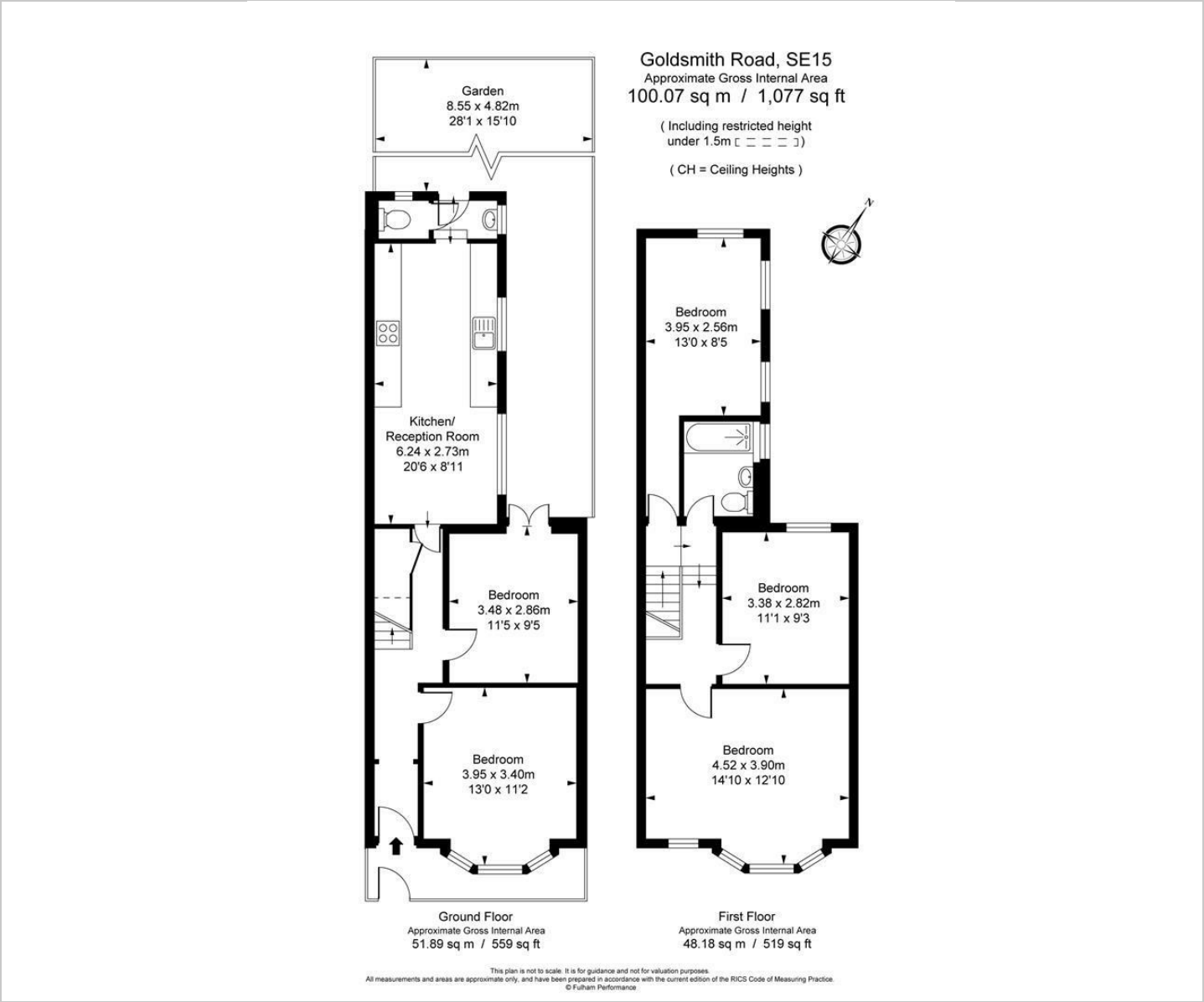

Viewing

Please contact our Head Office Office on 03333444385 if you wish to arrange a viewing appointment for this property or require further information.

These particulars, whilst believed to be accurate are set out as a general outline only for guidance and do not constitute any part of an offer or contract. Intending purchasers should not rely on them as statements of representation of fact, but must satisfy themselves by inspection or otherwise as to their accuracy. No person in this firms employment has the authority to make or give any representation or warranty in respect of the property.

