

2 Bedroom Detached Bungalow for Sale - Offers in Excess of £167,500

Boyces Road, Wisbech, Cambs, PE13 2JT



KEY FEATURES

- No upward chain!
- Extended detached bungalow
- Popular location
- 2 Bedrooms
- 25 ft bay fronted lounge
- Conservatory
- Gas central heating
- Multiple off road parking
- Low maintenance garden
- Garage + shed

Description

LIFE ON ONE LEVEL! Situated within walking distance of the bus stop & amenities, you will find this detached bungalow that has plenty to offer!

The extended accommodation provides plenty of space including the 25 Ft bay fronted lounge. There is also a conservatory, kitchen, bathroom & 2 bedrooms that both benefit from having fitted wardrobes. The property has gas central heating and is on mains drainage. The flat roof has been updated recently (2019).

Outside has a gated entrance to the property that leads to multiple off road parking. There is a low maintenance rear garden that includes the 15 FT garage (with electric), garden shed and a pond that has a water feature. A nice garden to potter about in!

This bungalow is being sold with the benefit of **NO UPWARD CHAIN** for that hassle free move. Contact us **TODAY** to arrange a viewing!

Ground Floor

Hall -

Lounge - 25' 3" x 13' 3" (7.72m x 4.06m)

Kitchen - 10' 9" x 9' 10" (3.3m x 3.02m)

Conservatory - 14' 11" x 6' 5" (4.57m x 1.98m)

Bedroom 1 - 12' 0" x 10' 5" (3.66m x 3.18m)

Bedroom 2 - 10' 11" x 9' 10" (3.33m x 3.02m)

Bathroom - 10' 5" x 6' 5" (3.18m x 1.96m)

Exterior

Garage - 15' 9" x 11' 9" (4.82m x 3.6m)





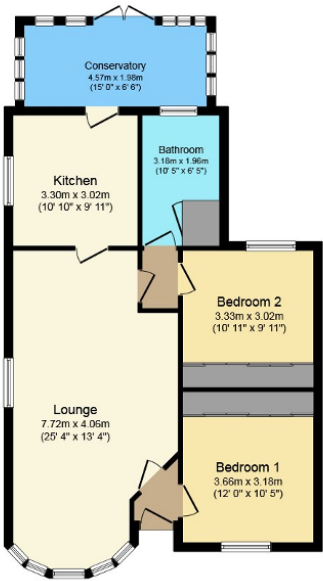

Floor Plan

Floor area 78.0 sq. m. (840 sq. ft.)
approx

Total floor area 78.0 sq. m. (840 sq. ft.) approx

This Floor Plan is for illustration purposes only and may not be representative of the property. The position and size of doors, windows and other features are approximate. Unauthorized reproduction prohibited. © PropertyBOX

Energy Efficiency

