

Moving You



Grasmere Gardens, BS30 5XW
03334041188 option 3

Offers in excess of £425,000
guy.rolfe@moving-you.co.uk

Freehold
www.moving-you.co.uk









Grasmere Gardens, Bridgegate, Bristol, BS30 5XW

This charming three bedroom detached home is available for sale and is nestled within a tranquil location, surrounded by a harmonious blend of lush green spaces, walking and cycling routes. It is the ideal retreat for families seeking a home in the sought-after location of Bridgegate.

Inside, the house boasts a downstairs W.C, two reception rooms, providing ample space for family gatherings and entertaining guests. The first reception room is a cosy living room with direct access to the side garden, allowing for seamless indoor-outdoor living. The second reception, the conservatory/dining, captures the beauty of the garden view and also provides access to the garden, perfect for those summer barbecues or a peaceful morning coffee.

The heart of the home is the family kitchen, featuring a stylish kitchen island, perfect for hosting casual meals or prepping your favourite dishes.

Moving upstairs, the master bedroom offers a sanctuary for rest and relaxation. The second bedroom can comfortably accommodate a double bed, and the third bedroom, although smaller, is still a really good size.

There is a modern style bathroom, enhancing the overall comfort of the house. Outside, the property benefits from a garden, a true oasis of tranquillity surrounded by trees and wildlife. The private side garden has a raised Koi pond and pedestrian access to a superb extended detached garage, providing additional storage or workspace and driveway for vehicles.

Additional benefits to this lovely home include gas central heating, double glazing and owned solar panels providing cost effective energy for the owners.

All in all, this house is a beautiful fusion of charm, comfort and convenience. Don't miss the opportunity to make this your new family home.

Council Tax Band B







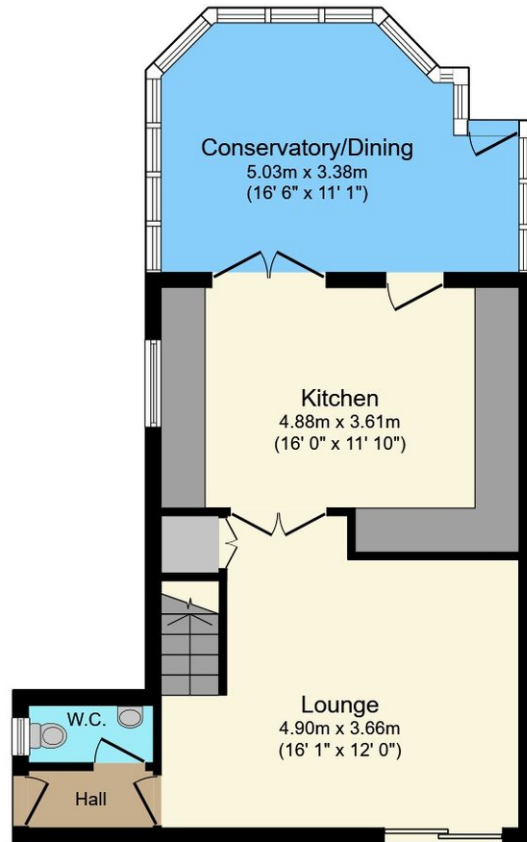

Ground Floor

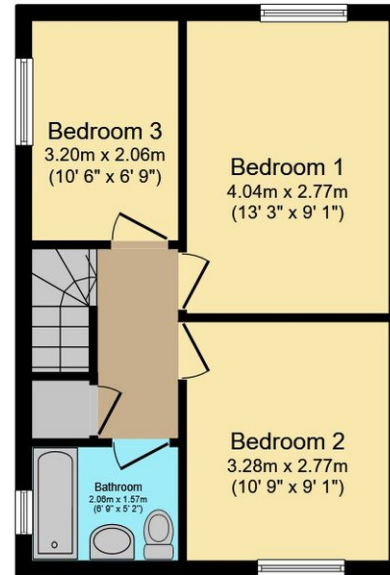

First Floor

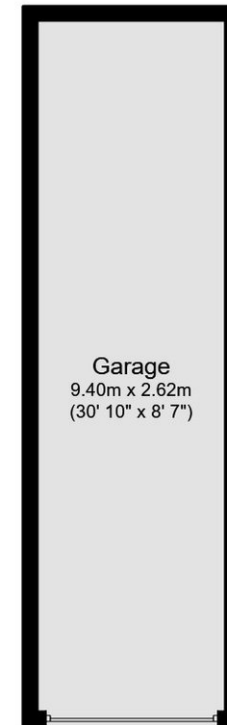

Garage

This floor plan is for illustrative purposes only. It is not drawn to scale. Any measurements, floor areas (including any total floor area), openings and orientations are approximate. No details are guaranteed, they cannot be relied upon for any purpose and do not form any part of any agreement. No liability is taken for any error, omission or misstatement. A party must rely upon its own inspection(s). Powered by www.Propertybox.io

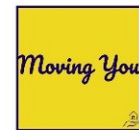

Guy Rolfe Moving You

03334041188 option 3

guy.rolfe@moving-you.co.uk

PROPERTY MISDESCRIPTIONS ACT 1991: The Agents has not tested any apparatus, equipment, fixtures and fittings, or services, so cannot verify that they are in working order or fit for the purpose. The buyer is advised to obtain verification from his or her Professional Buyer, References to the Tenure of the property are based on information supplied by the Vendor. The agents have not had sight of the title documents. The buyer is advised to obtain verification from their Solicitor. You are advised to check the availability of any property before travelling any distance to view.

www.moving-you.co.uk