

Moving You



Kingsleigh Park, Kingswood, BS15 9PJ
03334041188 option 3

Asking Price £290,000
guy.rolfe@moving-you.co.uk

Freehold
www.moving-you.co.uk









Kingsleigh Park, Bristol, BS15 9PJ

This immaculate 3-bedroom terraced house over three floors, located in a peaceful cul-de-sac near schools and parks, offers a perfect blend of tranquillity and convenience for first-time buyers or families, it features an open-plan kitchen/dining room, cosy living room, a garden room, a single garage and allocated parking space.

Welcome to this immaculate 3-bedroom terraced family house, a perfect starting point for first-time buyers or a haven for young families looking for their forever home at a reasonable price. Nestled in a peaceful cul-de-sac, this property is conveniently located near Courtney Primary School and Kingswood park, offering a great blend of tranquillity and convenience.

As you step inside, you'll be greeted by a warm and inviting open plan kitchen/dining room, perfect for entertaining or enjoying quality family time. The lovely living room room offers direct access to a tranquil garden, perfect for those soothing summer evenings.

The property boasts three bedrooms over two floors, including the master bedroom that promises to be a serene retreat after a long day. The other two bedrooms are single rooms, offering cosy space for children or guests.

A unique feature of this property is the garden room, a good space for those working from home. If you have a car, you'll be pleased to know there's a single garage on the property, adding to its practicality with an allocated parking spot.

This home, is in immaculate condition and offers a fantastic location, and it gives the perfect buyer the opportunity to acquire a warm and welcoming home. Don't miss out on this gem.

Council Tax Band B







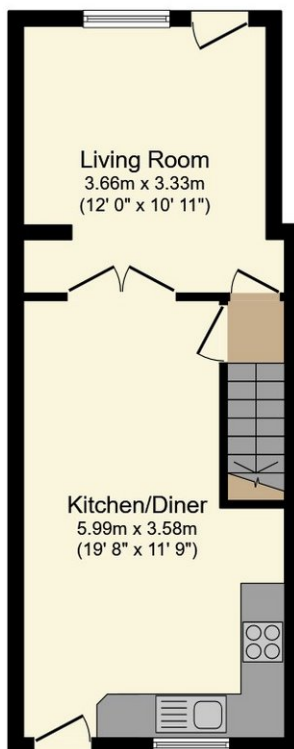

Ground Floor

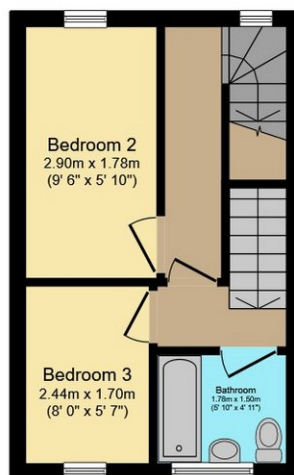

First Floor

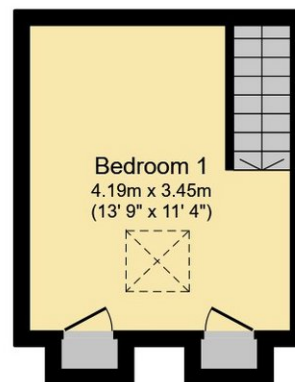

Second Floor

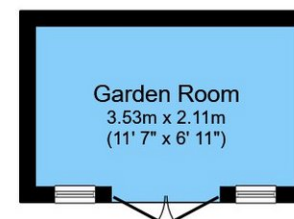

Outbuilding

This floor plan is for illustrative purposes only. It is not drawn to scale. Any measurements, floor areas (including any total floor area), openings and orientations are approximate. No details are guaranteed, they cannot be relied upon for any purpose and do not form any part of any agreement. No liability is taken for any error, omission or misstatement. A party must rely upon its own inspection(s). Powered by www.Propertybox.io



Guy Rolfe Moving You

03334041188 option 3

guy.rolfe@moving-you.co.uk

PROPERTY MISDESCRIPTIONS ACT 1991: The Agents has not tested any apparatus, equipment, fixtures and fittings, or services, so cannot verify that they are in working order or fit for the purpose. The buyer is advised to obtain verification from his or her Professional Buyer, References to the Tenure of the property are based on information supplied by the Vendor. The agents have not had sight of the title documents. The buyer is advised to obtain verification from their Solicitor. You are advised to check the availability of any property before travelling any distance to view.

www.moving-you.co.uk