



MANOR
OXFORD



Rose Cottage is located within the highly favourable Kidlington location known as The Moors | Once served as the village bakery | A very unique one-off opportunity | A charming grade II listed detached cottage situated within a private lane.

3



2



2





The property is situated on a generous plot. Allowing for a private setting and benefiting from a wrap around garden along with a gated driveway.

Inside, you will find ample living space on the ground floor. There are two reception rooms that service the ground floor. Both rooms offer character features such as exposed beams and feature fireplaces. There is a high-spec fitted kitchen, and a stable door complements this space allowing easy access to the private garden.

The master bedroom suite is a private and spacious option. Benefiting from en suite facilities and garden views. Two further double bedrooms are to be found on the first floor.

Rose Cottage surrounds itself with mature gardens. The positioning of neighbouring properties allows for your very own oasis. Gated off-street parking for several vehicles is available.





- Grade II listed
- Detached Cottage
- Private Setting
- Mature Gardens
- Two Reception Rooms
- Ample Parking
- Character Features
- Amenities Nearby
- Fantastic Transport Links
- Highly Favourable Location

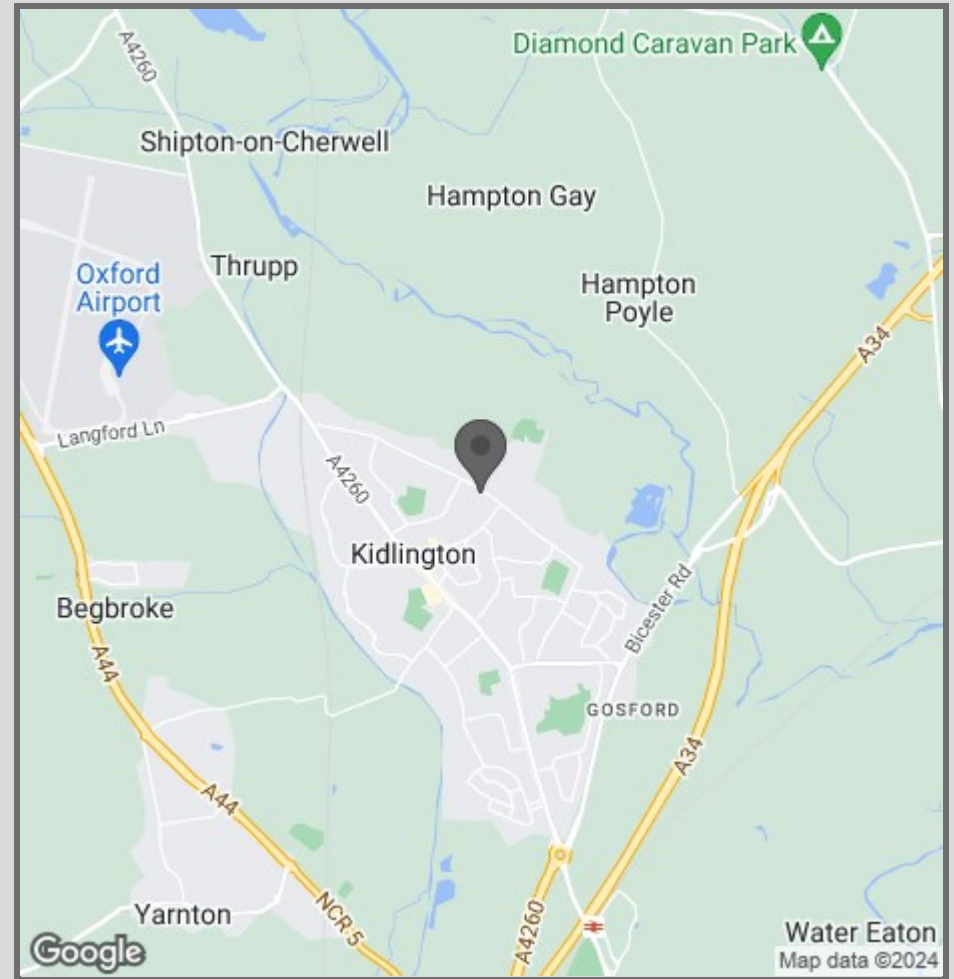

57 Victoria Road
Oxford
OX2 7QF

01865 955500

hello@manoroxford.com

www.manoroxford.com



The Moors, OX5

Approximate Gross Internal Area = 120.8 sq m / 1301 sq ft

For identification only - Not to scale

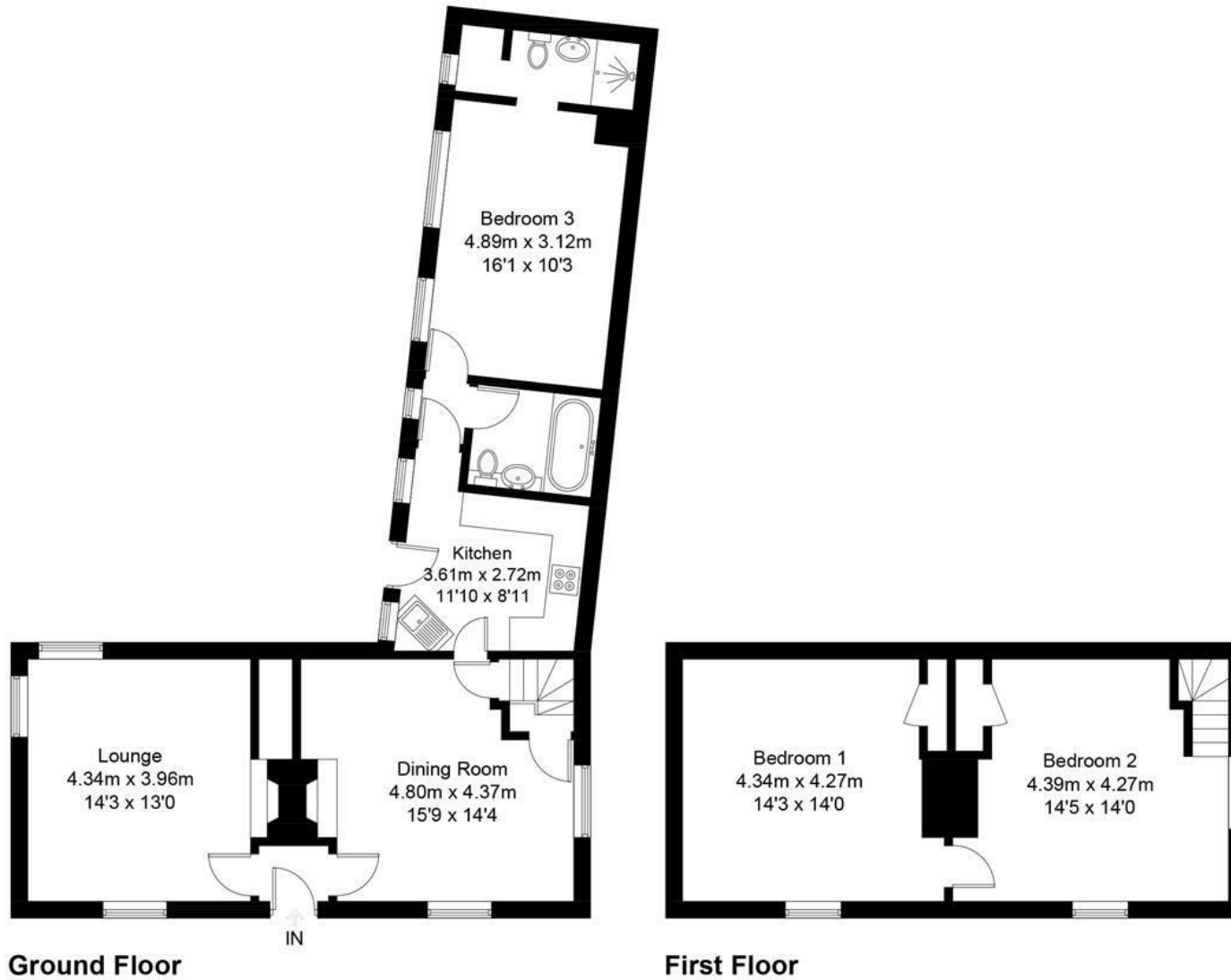



MANOR
OXFORD