





## Ground Floor

### Entrance Porch

Enter via a timber/partly glazed front door and having uPVC/double glazed windows to each side aspect, vinyl flooring and a door opening to the lounge/dining room.

### Lounge/Dining Room

**23' 0" x 13' 4" (7.015m x 4.069m)**

Having three uPVC/double glazed windows, one to the front aspect, one to the side aspect and one to the rear aspect, a coved ceiling with two ceiling light points, wall lighting, two central heating radiators, a gas fire with a fireplace surround, carpeted flooring, decorative dado railing and a door opening to the kitchen.

### Kitchen

**9' 3" x 7' 11" (2.812m x 2.401m)**

Being fitted with a range of wall, base and drawer units with laminate worksurface over and having a uPVC/double glazed window to the side aspect, a ceiling light point, a central heating radiator, a sink with a mixer tap fitted and a drainer unit, tiled splashbacks, a built-under electric oven with an electric hob over, plumbing for both a washing machine and a dishwasher, an integrated, under-counter fridge, laminate flooring and a door opening to the conservatory.

### Conservatory

**13' 3" x 5' 1" (4.030m x 1.537m)**

Being constructed from a low-level brick wall base and uPVC/double glazed windows to the side and rear aspects and having tiled flooring, a door opening to the guest WC and a uPVC/double glazed door to the side aspect opening to the rear garden.

### Downstairs WC

Having a WC, a ceiling light point and laminate flooring.



## First Floor

### Landing

Having a window to the front aspect, a ceiling light point, a central heating radiator, access to the loft space and doors opening to both bedrooms and the family bathroom.

### Bedroom One

**11' 4" x 9' 4" (3.462m x 2.847m)**

Having a uPVC/double glazed window to the front aspect, a coved ceiling with a ceiling light point, a central heating radiator, carpeted flooring and a fitted bedroom suite which includes: wardrobes, floor and wall storage cupboards, shelving and a dressing table with drawer cabinets.

### Bedroom Two

**11' 3" x 10' 3" (3.436m x 3.128m)**

Having a uPVC/double glazed window to the rear aspect, a coved ceiling with a ceiling light point, a central heating radiator, carpeted flooring, a fitted wardrobe with sliding mirror doors and a fitted storage cupboard and dressing table.

### Bathroom

**8' 2" x 8' 1" (2.477m x 2.461m)**

Having a uPVC/double glazed window to the side aspect, a ceiling light point, a central heating radiator, a WC, a wash hand basin, a bath, a separate shower cubicle with an electric shower installed, a storage cupboard and decorative dado railing.

## Outside

### Front

Having a driveway leading to low-level, wrought iron gates opening to the rear garden and the double garage, a lawn retained by a low-level brick wall and a planted, decorative gravel area.

### Double Garage

**17' 6" x 18' 5" (5.345m x 5.620m)**

Having power, lighting, two up and over doors to the front aspect, two windows to the side aspects and a door to the rear aspect.

### Rear

A huge and private rear garden which has a driveway suitable for parking multiple vehicles, a lawn, a summerhouse, a brick-built outbuilding, a wooden shed, planted borders, various, mature trees, shrubs and bushes, access to the double garage and access to the front of the property via low-level, wrought iron gates.







\* A spacious family home which has a huge rear garden and is situated in a very desirable location \*

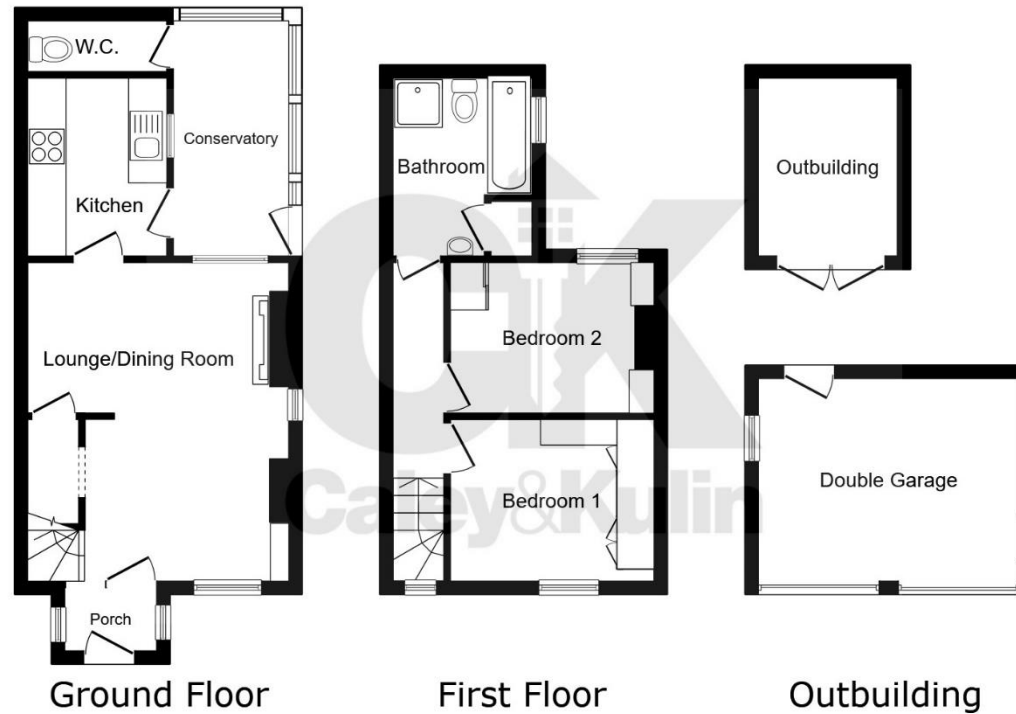

This floor plan is for illustrative purposes only. It is not drawn to scale. Any measurements, floor areas (including any total floor area), openings and orientations are approximate. No details are guaranteed, they cannot be relied upon for any purpose and do not form any part of any agreement. No liability is taken for any error, omission or misstatement. A party must rely upon its own inspection(s). Powered by [www.Propertybox.io](http://www.Propertybox.io)

To view this property please contact Caley & Kulin on:

**Cannock:** 01543 396880 **Stafford:** 01785 559880

**Wolverhampton:** 01902 953923

**E-mail:** [info@candk.co.uk](mailto:info@candk.co.uk)

Staffordshire House, Clay Street, Penkridge, Stafford, ST19 5AF

**View this property online [candk.co.uk](http://candk.co.uk)**

**Council Tax Band:** C

**EPC Rating:** EPC Awaited

**Tenure:** Freehold

**Version:** CK2052/001



Find us on facebook

[facebook.com/candk.co.uk](https://facebook.com/candk.co.uk)



These particulars are not to form part of a Sale Contract owing to the possibility of errors and/or omissions. Prospective purchasers should therefore satisfy themselves by inspection or otherwise as to their correctness. All fixtures, fittings, chattels and other items not mentioned are specifically excluded unless otherwise agreed within the Sale Contract documentaries or left in situ and gratis upon completion. The property is also sold subject to rights of way, public footpaths, easements, wayleaves, covenants and any other matters which may affect the legal title. The Agent has not formally verified the property's structural integrity, ownership, tenure, acreages, estimated square footage, planning/building regulations status or the availability/operation of services and/or appliances. Therefore prospective purchasers are advised to seek validation of all the above matters prior to expressing any formal intent to purchase.

See all our properties at [www.candk.co.uk](http://www.candk.co.uk) | [www.rightmove.co.uk](http://www.rightmove.co.uk)

