





Ground Floor

Entrance Hallway

Enter the property via a uPVC/partly double-glazed front door with two full-height, obscured windows each side and having a coved ceiling with two ceiling light points, a central heating radiator, a carpeted, spindle stairway to the first floor, laminate flooring and doors opening to the lounge, the kitchen/breakfast room and the guest WC.

Lounge

17' 4" x 11' 3" (5.28m x 3.43m)

Having a uPVC/double glazed walk-in bay window to the front aspect, a coved ceiling with a ceiling light point, a central heating radiator, double, partly glazed doors opening to the dining room, carpeted flooring and a feature media wall which has a television aerial point and an electric, living flame fire installed.

Dining Room

10' 6" x 11' 3" (3.20m x 3.43m)

Having uPVC/double glazed French doors to the rear aspect opening to the garden, a coved ceiling with a ceiling light point, a central heating radiator, tiled flooring and a door opening to the kitchen/breakfast room.

Kitchen/Breakfast Room

11' 8" x 14' 8" (3.55m x 4.47m)

Being fitted with a range of wall, base and drawer units with laminate worksurface over and having two uPVC/double glazed windows to the rear aspect, ceiling spotlights, a central heating radiator, a composite, one and a half bowl sink with a mixer tap fitted and a drainer unit, a Belling, aga style oven/hob with a stainless steel, chimney style extraction unit over, an integrated dishwasher, an integrated, under-counter fridge, a breakfast bar seating area, tiled flooring and doors opening to the utility and a storage cupboard.

Utility

5' 2" x 8' 2" (1.57m x 2.49m)

Having a fitted base unit with laminate worksurface over, a ceiling light point, a central heating radiator, plumbing for a washing machine, space for a tumble dryer, tiled flooring, an extraction unit and a uPVC/double glazed door to the side aspect opening to the rear garden.

Downstairs WC

Having a WC, a wash-hand basin with a tiled splashback, a ceiling light point, a central heating radiator, an extraction unit and tiled flooring.

First Floor

Landing

Having a coved ceiling with a ceiling light point, access to the loft space, carpeted flooring, an airing cupboard and doors opening to the four bedrooms and the family bathroom.

Bedroom One

12' 6" x 11' 4" (3.81m x 3.45m)

Having two uPVC/double glazed windows to the front aspect, a ceiling light point, a central heating radiator, carpeted flooring, two, double door, built-in wardrobes, a feature, decorative panelled wall and a door opening to the en-suite shower room.

En-suite Shower Room

Having an obscured window to the front aspect, ceiling spotlights, a central heating radiator, a WC, a wash hand basin with a mixer tap fitted and under-sink storage, tiled flooring, partly tiled walls, an extraction unit and a shower cubicle with a thermostatic shower installed.

Bedroom Two

11' 8" x 10' 5" (3.55m x 3.17m)

Having a uPVC/double glazed window to the front aspect, a ceiling light point, a central heating radiator, a double door, built-in wardrobe and carpeted flooring.

Bedroom Three

14' 11" x 8' 4" (4.54m x 2.54m)

Having a uPVC/double glazed window to the rear aspect, a ceiling light point, a central heating radiator and carpeted flooring.

Bedroom Four

11' 6" x 8' 5" (3.50m x 2.56m)

Having a uPVC/double glazed window to the rear aspect, a ceiling light point, a central heating radiator and carpeted flooring.

Family Bathroom

Having an obscured window to the rear aspect, ceiling spotlights, a chrome-finished central heating towel rail, a WC, a wash hand basin with a mixer tap fitted, tiled flooring, partly tiled walls, an extraction unit, a bath with a mixer tap fitted and a separate shower cubicle with a thermostatic shower installed.

Outside

Front

Having a large block-paved driveway suitable for parking multiple vehicles, a decorative gravel area, a low-level brick wall with decorative, wrought iron railings, a low-level hedge, courtesy lighting, access to the garage and access to the rear of the property via a wrought iron side gate.

Garage

14' 5" x 8' 2" (4.40m x 2.50m)

Being a detached garage, which has power, lighting and an up and over door.

Rear

A beautifully landscaped garden which has a lawn, a raised, decked seating area with a pergola over, decorative, slate-chipped borders, various plants, shrubs and bushes and access to the front of the property via a wrought iron side gate.









* An immaculately presented, detached family home situated in a very desirable location *

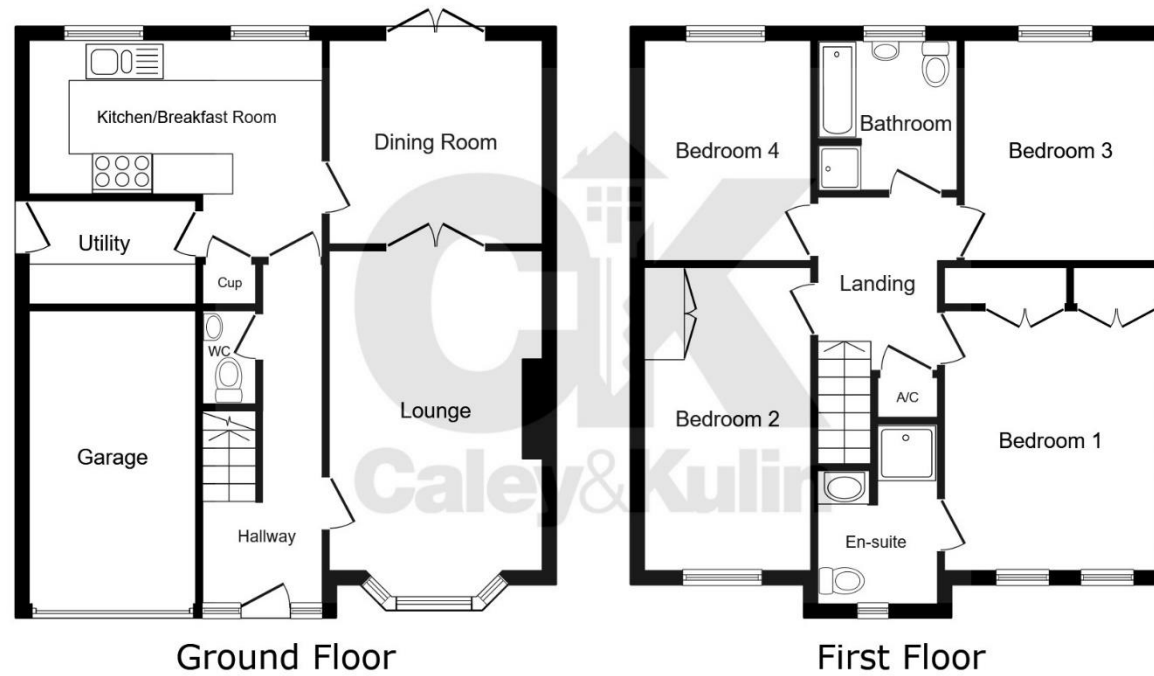

This floor plan is for illustrative purposes only. It is not drawn to scale. Any measurements, floor areas (including any total floor area), openings and orientations are approximate. No details are guaranteed, they cannot be relied upon for any purpose and do not form any part of any agreement. No liability is taken for any error, omission or misstatement. A party must rely upon its own inspection(s). Powered by www.Propertybox.io

To view this property please contact Caley & Kulin on:

Cannock: 01543 396880 **Stafford:** 01785 559880

Wolverhampton: 01902 953923

E-mail: info@candk.co.uk

Staffordshire House, Clay Street, Penkridge, Stafford, ST19 5AF

View this property online candk.co.uk

Council Tax Band: E

EPC Rating: C

Tenure: Freehold

Version: CK1834/001



Find us on facebook

facebook.com/candk.co.uk



These particulars are not to form part of a Sale Contract owing to the possibility of errors and/or omissions. Prospective purchasers should therefore satisfy themselves by inspection or otherwise as to their correctness. All fixtures, fittings, chattels and other items not mentioned are specifically excluded unless otherwise agreed within the Sale Contract documentaries or left in situ and gratis upon completion. The property is also sold subject to rights of way, public footpaths, easements, wayleaves, covenants and any other matters which may affect the legal title. The Agent has not formally verified the property's structural integrity, ownership, tenure, acreages, estimated square footage, planning/building regulations status or the availability/operation of services and/or appliances. Therefore prospective purchasers are advised to seek validation of all the above matters prior to expressing any formal intent to purchase.

See all our properties at www.candk.co.uk | www.rightmove.co.uk

