





Ground Floor

Entrance Hallway

Enter the property via a timber / partly double glazed front door and having a coved ceiling with a ceiling light point, a central heating radiator, Karndean flooring, carpeted stairs leading to the first floor and doors to the kitchen / diner / family room, the lounge and a downstairs WC.

Downstairs WC

Having a WC, a wash hand basin with a mixer tap fitted, a tiled splashback, Karndean flooring, a ceiling light point, an extraction fan and a central heating radiator.

Lounge

20' 6" x 12' 1" (6.24m x 3.68m)

Having a uPVC / double glazed window to the front aspect, a coved ceiling with a ceiling light point, a central heating radiator, a gas fire with a fireplace surround, carpeted flooring and glazed doors leading to the conservatory.

Conservatory

9' 0" x 11' 9" (2.74m x 3.58m)

Being constructed from a low-level brick wall and uPVC / double glazed windows. Also having wall lighting, Karndean flooring and French doors to the side aspect opening to the rear garden.

Kitchen/ Diner/ Family Room

Kitchen/Diner

33' 6" x 12' 10" (10.20m x 3.91m)

Being fitted with a range of wall, base and drawer cabinets with quartz work surface over and matching upstands. Also having a uPVC / double glazed window to the front aspect, two central heating radiators, laminate flooring, an under mounted sink with drainer grooves inset into the quartz worktop and a mixer tap fitted, integrated appliances which include; an electric double oven, a microwave and a dishwasher, a five burner gas hob with a chimney style extraction hood over, a space for an upright American style fridge freezer, a coved ceiling with ceiling spotlights, under cabinet accent lighting and a door leading to the utility room.

Family Area

Open plan from the kitchen / diner area and having three uPVC / double glazed windows one to the rear aspect and two to the side aspect all fitted with Roman blinds, ceiling spotlights and an open fireplace with a log burner fitted.

Utility room

Having a uPVC / double glazed door to the rear aspect allowing access to the garden and being fitted to match the kitchen / diner wall and base cabinets with quartz work surface over as well as matching upstand, an under mounted sink with a mixer tap fitted, laminate flooring, plumbing for a washing machine, a ceiling light point and a central heating radiator.

First Floor

Landing

Having two uPVC / double glazed windows one to the front aspect and one to the rear both fitted with horizontal blinds, two ceiling light points, carpeted flooring, a central heating radiator, access to the loft space and doors leading to the four bedrooms and the family bathroom.

Bedroom One

12' 8" x 11' 0" (3.86m x 3.35m)

Having a uPVC / double glazed window to the front aspect fitted with horizontal blinds, a central heating radiator, a ceiling light point, built-in wardrobes, carpeted flooring and a door leading to the en-suite shower room.

En-suite Shower Room

Having an obscure uPVC / double glazed window to the side aspect, a chrome finished central heating towel rail, ceiling spotlights, a WC, a wash hand basin with a mixer tap fitted, tiled walls and flooring, an extraction fan and a shower cubicle with a thermostatic shower installed.

Bedroom Two

10' 1" x 12' 3" (3.07m x 3.73m)

Having a uPVC / double glazed window to the rear aspect, a central heating radiator, a ceiling light point, carpeted flooring and built-in wardrobes.

Bedroom Three

10' 1" x 10' 8" (3.07m x 3.25m)

Having a uPVC / double glazed window to the rear aspect, a central heating radiator, a ceiling light point and carpeted flooring.

Bedroom Four

8' 9" x 12' 4" (2.66m x 3.76m)

Having a uPVC / double glazed window to the front aspect fitted with a horizontal blind, a central heating radiator, a ceiling light point, carpeted flooring and a built-in wardrobe.

Family Bathroom

Having an obscure uPVC / double glazed window to the side aspect, ceiling spotlights, a WC, a wash hand basin with a mixer tap fitted, fully tiled walls and flooring, a chrome finished central heating towel rail, an extraction fan, a bath with a mixer tap fitted and a shower cubicle with a thermostatic shower installed.

Outside

Garage

Having power, lighting, a uPVC / double glazed door to the rear aspect opening to the garden, a uPVC / double glazed window also to the rear aspect and a remote operated electric roller shutter door to the front aspect opening to the driveway.

Front

Having a large private block paved driveway which is suitable for parking multiple vehicles, a lawn, a storm porch above the front entrance, access to the garage and access to the rear of the property via a wooden side gate.

Rear

Being mainly lawn with a patio dining area, outdoor courtesy lighting, access to the garage, a summerhouse and access to the front of the property via a wooden side gate.

Agents Notes

Tenure – Freehold
Council Tax Band - E











* An immaculately presented four bedroom home in a very desirable area *

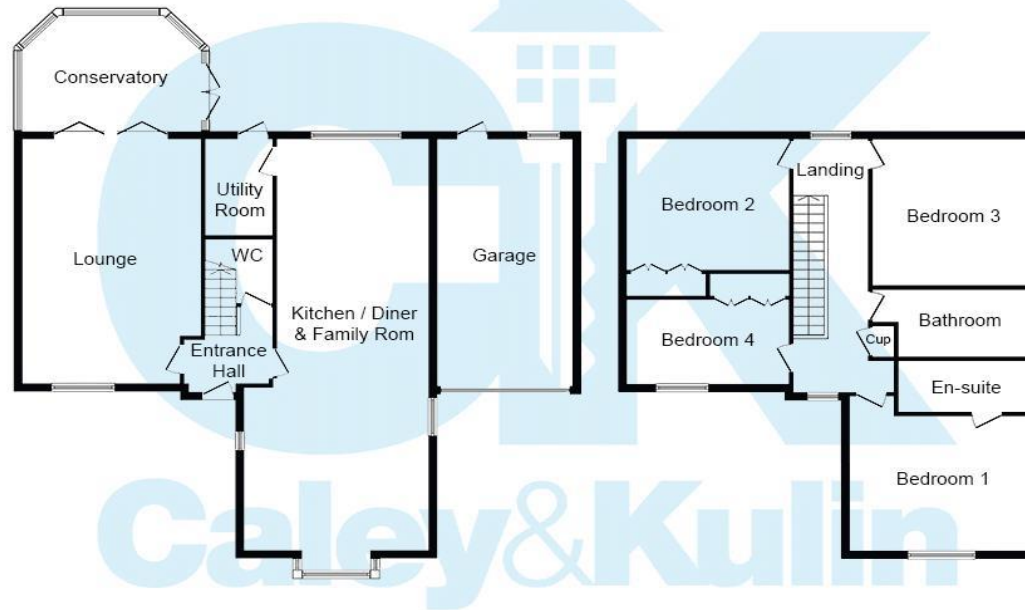

Please note; this floorplan is for illustration purposes only and may not be a true reflection of the property's layout nor is this plan drawn to scale.

To view this property please contact Caley & Kulin on:
Cannock: 01543 396880 **Stafford:** 01785 559880
E-mail: info@candk.co.uk

Staffordshire House, Clay Street, Penkridge, Stafford, ST19 5AF

View this property online candk.co.uk

Council Tax Band: E
EPC Rating: Awaiting EPC
Tenure: Freehold
Version: CK640/001



Find us on facebook
facebook.com/candk.co.uk



These particulars are not to form part of a Sale Contract owing to the possibility of errors and/or omissions. Prospective purchasers should therefore satisfy themselves by inspection or otherwise as to their correctness. All fixtures, fittings, chattels and other items not mentioned are specifically excluded unless otherwise agreed within the Sale Contract documentaries or left in situ and gratis upon completion. The property is also sold subject to rights of way, public footpaths, easements, wayleaves, covenants and any other matters which may affect the legal title. The Agent has not formally verified the property's structural integrity, ownership, tenure, acreages, estimated square footage, planning/building regulations status or the availability/operation of services and/or appliances. Therefore prospective purchasers are advised to seek validation of all the above matters prior to expressing any formal intent to purchase.

See all our properties at www.candk.co.uk | www.rightmove.co.uk

