



HODSONS

PCM

£1,450 PCM

Twentyman Walk

Middleton, LS10 4FG



PROPERTY SUMMARY

A four bedroom family house, having en-suite to two double bedrooms, breakfast kitchen, Separate Dining Room and Utility Room. The property is situated on the Leeds New Forest Village, close to Leeds City Centre, Wakefield and Dewsbury. The regions motorway network is also easily accessed. Comprising: Lounge, Family Room, Dining Room, Four Bedroom with en-suite to Master and Guest Bedrooms. Family Bathroom, Study. Garage and Gardens.

4



3



3





LOCAL AUTHORITY

Leeds City Council

TENURE

COUNCIL TAX BAND

D

VIEWINGS

By prior appointment only

| Energy Efficiency Rating | | |
|--|----------------------------|-----------|
| | Current | Potential |
| <i>Very energy efficient - lower running costs</i> | | |
| (92 plus) A | | |
| (81-91) B | | |
| (69-80) C | | |
| (55-68) D | | |
| (39-54) E | | |
| (21-38) F | | |
| (1-20) G | | |
| <i>Not energy efficient - higher running costs</i> | | |
| England & Wales | EU Directive 2002/91/EC | |

Agents Note: Whilst every care has been taken to prepare these particulars, they are for guidance purposes only. All measurements are approximate and are for general guidance purposes only and whilst every care has been taken to ensure their accuracy, they should not be relied upon and potential buyers/tenants are advised to recheck the measurements

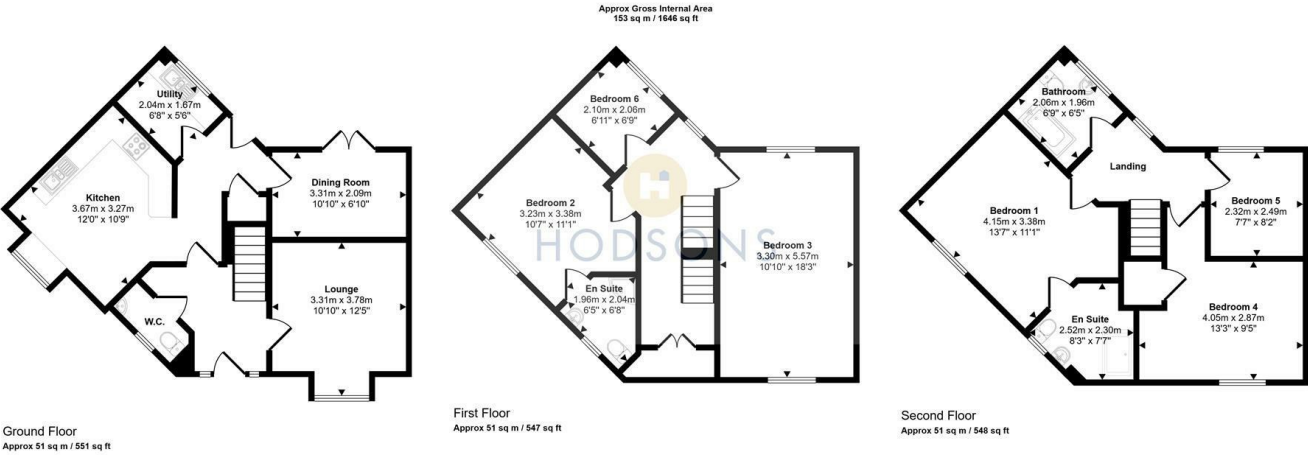

This floorplan is only for illustrative purposes and is not to scale. Measurements of rooms, doors, windows, and any items are approximate and no responsibility is taken for any error, omission or mis-statement. Icons of items such as bathroom suites are representations only and may not look like the real items. Made with Made Snappy 360.



| | |
|---|--|
| <p>OFFICE ADDRESS 37-39 George Street Wakefield West Yorkshire WF1 1LX</p> | <p>OFFICE DETAILS 01924 200544 wakefield@hodsonsproperty.co.uk www.hodsonsproperty.co.uk</p> |
|---|--|