



HODSONS

PCM

£1,300 PCM

Cherry Drive

Pontefract, WF8 2FH

PROPERTY SUMMARY

A superb four-bedroom detached family home situated on a highly sought-after development in Pontefract. Enjoying an open outlook, this spacious property offers well-proportioned accommodation ideal for modern family living. The ground floor boasts a large lounge, a separate family room, an impressive open-plan kitchen with dining area, a useful utility room, and a guest WC. Upstairs, the master bedroom benefits from a stylish en-suite, accompanied by three further well-sized bedrooms and a family bathroom.

Outside, the property features well-maintained gardens, a double garage, and ample driveway parking. Ideally located close to a range of local amenities in Pontefract, as well as excellent transport links including nearby road and rail connections for commuters.

4



2



2





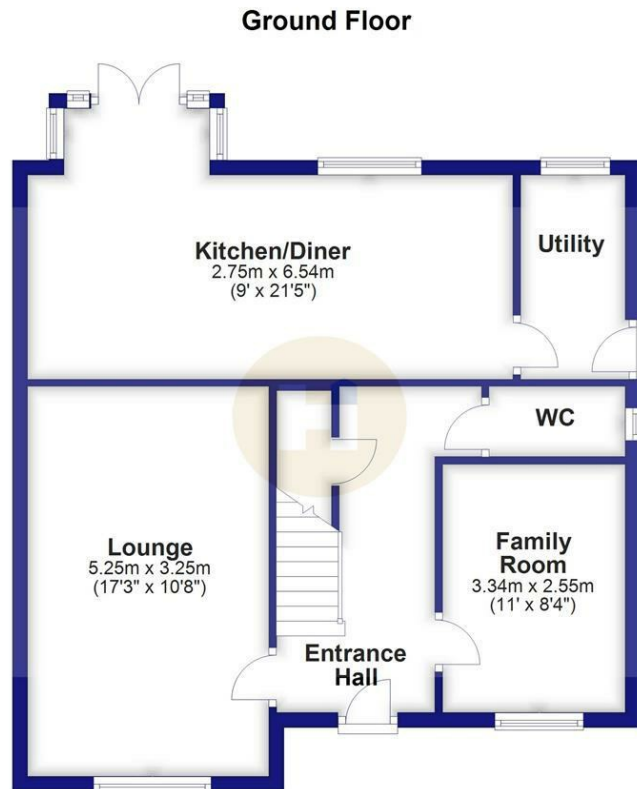

LOCAL AUTHORITY
 Wakefield Metropolitan District council

TENURE

COUNCIL TAX BAND
 E

VIEWINGS
 By prior appointment only

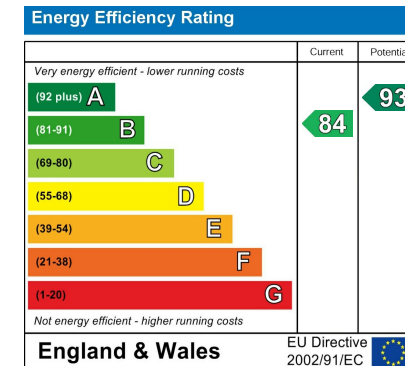

Agents Note: Whilst every care has been taken to prepare these particulars, they are for guidance purposes only. All measurements are approximate and are for general guidance purposes only and whilst every care has been taken to ensure their accuracy, they should not be relied upon and potential buyers/tenants are advised to recheck the measurements