



HODSONS



PER MONTH

£1,095 Per Month

Willow Road

Alverthorpe, WF2 9TB



PROPERTY SUMMARY

This is a modern semi detached home located in the sought-after area of Alverthorpe offering a perfect blend of comfort and style.

A viewing is recommended and will reveal a spacious reception room, perfect for entertaining guests or relaxing with your family. The property boasts three lovely bedrooms, providing ample space for a growing family or those in need of a home office. One of the highlights of this property is the fitted dining kitchen.

To the rear is an enclosed garden with a patio area whilst to the front is a drive providing off road parking. Additionally, the recent re-carpeting and redecoration throughout the house add a fresh and inviting touch to the space.

Don't miss the opportunity to make this house your home and enjoy the comfort and convenience it has to offer. Contact us today to arrange a viewing and take the first step towards living in this wonderful property on Willow Road.

3



1



1





Approx Gross Internal Area
63 sq m / 673 sq ft

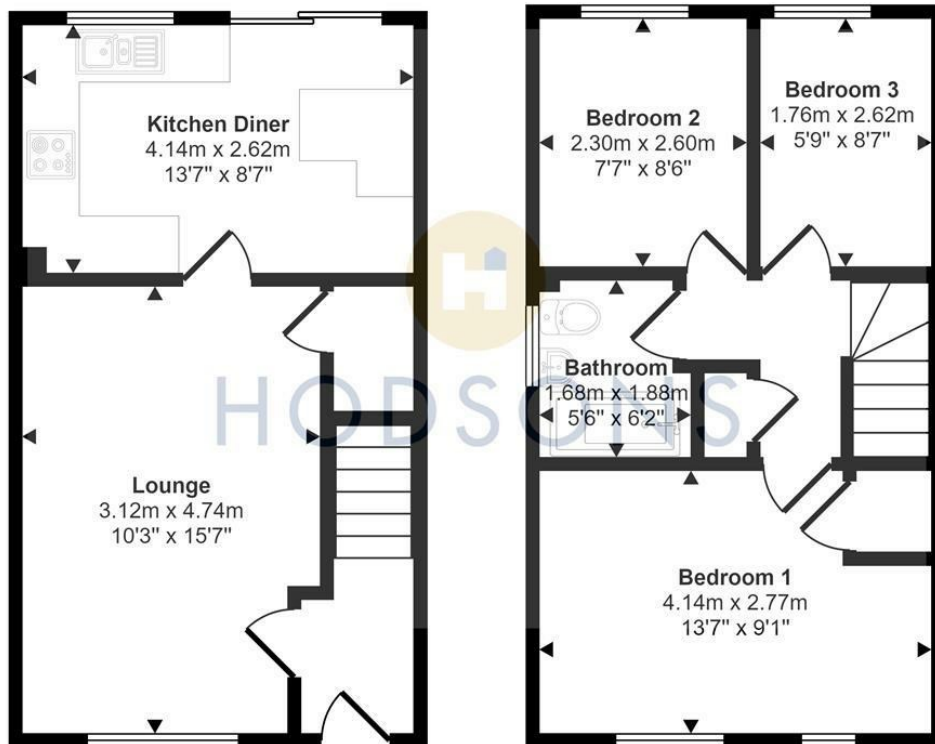

Ground Floor
Approx 31 sq m / 334 sq ft

First Floor
Approx 32 sq m / 340 sq ft

This floorplan is only for illustrative purposes and is not to scale. Measurements of rooms, doors, windows, and any items are approximate and no responsibility is taken for any error, omission or mis-statement. Icons of items such as bathroom suites are representations only and may not look like the real items. Made with Made Snappy 360.

LOCAL AUTHORITY
Wakefield Council

TENURE

COUNCIL TAX BAND
B

VIEWINGS
By prior appointment only

Energy Efficiency Rating		Current	Potential
Very energy efficient - lower running costs			
(92 plus) A			83
(81-91) B			
(69-80) C			
(55-68) D		66	
(39-54) E			
(21-38) F			
(1-20) G			
Not energy efficient - higher running costs			
England & Wales		EU Directive 2002/91/EC	

Agents Note: Whilst every care has been taken to prepare these particulars, they are for guidance purposes only. All measurements are approximate and are for general guidance purposes only and whilst every care has been taken to ensure their accuracy, they should not be relied upon and potential buyers/tenants are advised to recheck the measurements



OFFICE ADDRESS
37-39 George Street
Wakefield
West Yorkshire
WF1 1LX

OFFICE DETAILS
01924 200544
wakefield@hodsonsproperty.co.uk
www.hodsonsproperty.co.uk