



9 Greenfield Avenue

, Lutterworth, LE17 4FX

**Offers over £475,000**

# 9 Greenfield Avenue



## Description

PRICE ADJUSTMENT - STUNNING - SHOWHOME PRESENTATION - LARGE CORNER PLOT WITH DOUBLE GARAGE & ROOM FOR 4 CARS - If you are looking for an EXECUTIVE DETACHED home with LUXURY FEATURES, then this is the HOME FOR YOU. The current owners have had MANY EXTRAS installed from new, giving you the LUXURY OF A NEW BUILD but not have to have the bother of putting BLINDS UP or FITTING CARPETS and FLOORING ETC. The FABULOUS KITCHEN is OPEN PLAN giving you a GREAT ENTERTAINING AREA, with the ADDED BONUS of a LARGE CENTRE ISLAND to be able to SIT AND CHAT whilst PREPARING MEALS or have a LOVELY COSY NIGHT IN with FRIENDS. The 2 PRINCIPAL BEDROOMS HAVE DOUBLE SHOWER ENSUITES and the FAMILY BATHROOM ALSO has a SHOWER CUBICLE and is YET TO BE USED. The LARGE DOUBLE DETACHED GARAGE is big enough for 2 CARS with ADDITIONAL SPACE for storage LARGE PRIVATE DRIVE. TUCKED AWAY in WALKING DISTANCE to the COUNTRY PARK with NOBODY OVERLOOKING the FRONT of the house. For your chance to BUY this AMAZING HOME, contact us today.

- LARGE EXECUTIVE DETACHED HOME
- 2 PRINCIPAL ENSUITES
- LARGE OPEN PLAN KITCHEN SNUG
- LANDSCAPED REAR GARDEN
- COUNCIL TAX - F / EPC - B
- 4 DOUBLE BEDROOMS
- DOUBLE GARAGE + DRIVEWAY
- FAMILY BATHROOM WITH ADDITIONAL SHOWER
- PARKING FOR 4 CARS
- FREEHOLD / SERVICE CHARGE - £150 + VAT PA





## Floor Plan

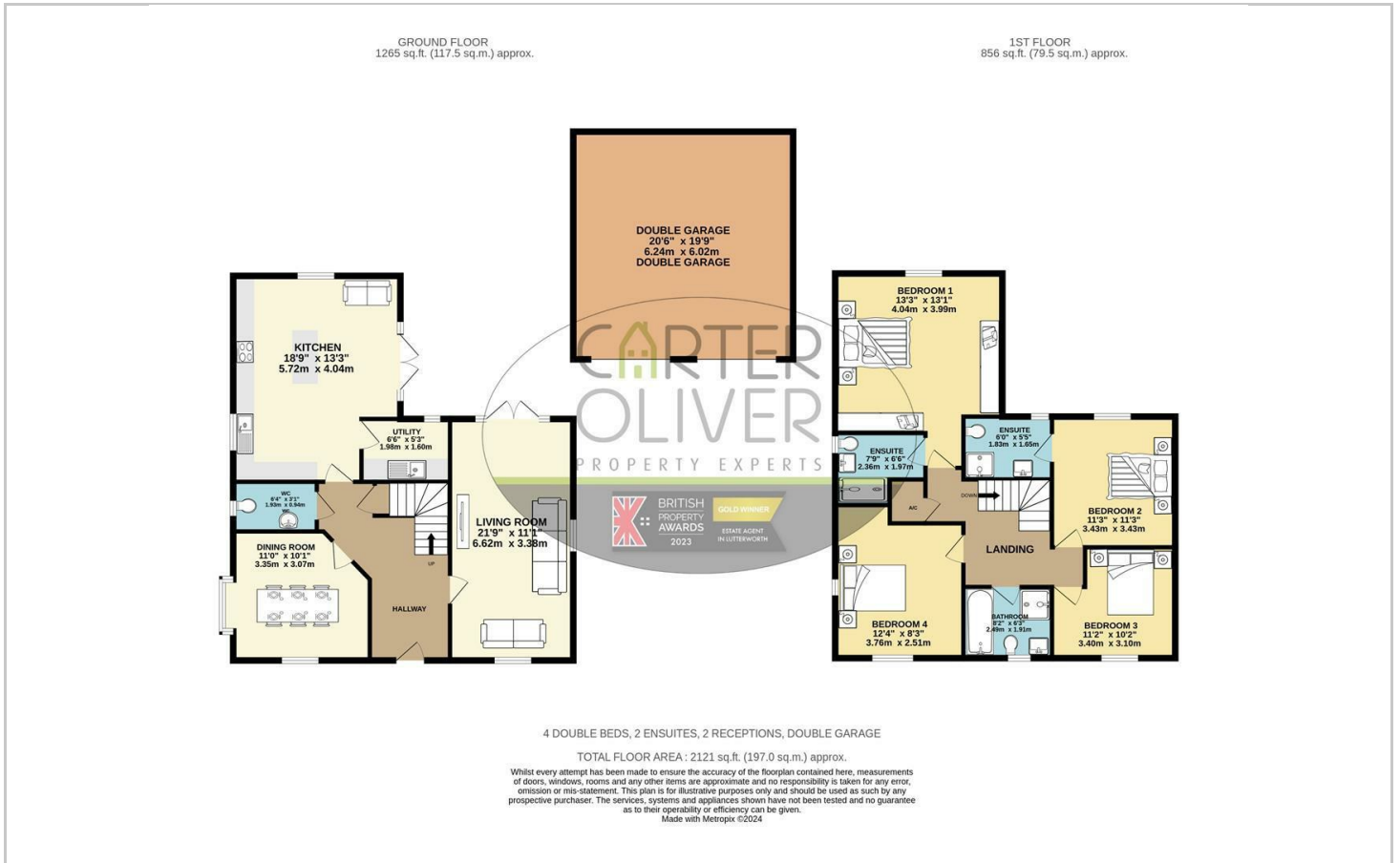

## Area Map

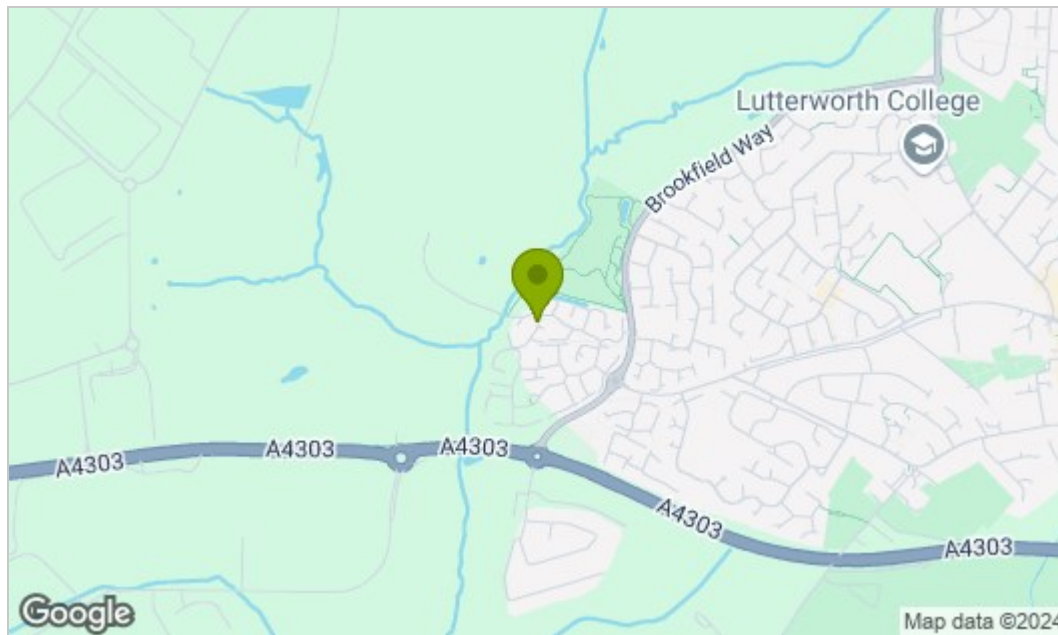

## Energy Efficiency Graph

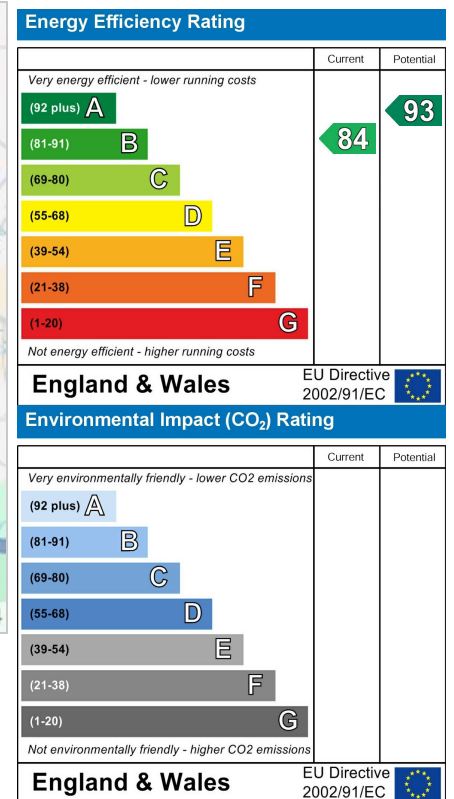

## Viewing

Please contact our LUTTERWORTH Office on 01455 248033 if you wish to arrange a viewing appointment for this property or require further information.

These particulars, whilst believed to be accurate are set out as a general outline only for guidance and do not constitute any part of an offer or contract. Intending purchasers should not rely on them as statements of representation of fact, but must satisfy themselves by inspection or otherwise as to their accuracy. No person in this firm's employment has the authority to make or give any representation or warranty in respect of the property.