



West View Road
Bere Alston, Yelverton

Price Guide £340,000



2



1



2



2

West View Road

Bere Alston, Yelverton

Found in the sought after village of Bere Alston is this well presented, two bedroom bungalow. Set in a large plot with beautiful front and rear gardens, the property offers amazing outdoor space for entertaining and Al Fresco dining. As well as the large amount of front and rear gardens the property also benefits from two outbuildings and a detached single garage. The property is located on the fringe of the village and benefits from easy access to the main road providing a link to the Stannary town of Tavistock.

Inside the property are two generous living spaces. One hosting a character fireplace ideal for those cosy winter evenings and the other a garden room at the front of the property, which enjoys the afternoon sun. The kitchen/dining room benefits from direct access out to the rear garden as well as two side aspect windows inviting in the natural light. At the rear of the property is a porch and utility space ideal for a washing machine and tumble dryer. There are two double bedrooms - the master bedroom is rear aspect and enjoys gorgeous views over the mature and well stocked garden.

The outbuildings to the side and rear of the property provide the perfect space for a home office, or potting shed. There could also be potential for conversion into a small annex or summer house (STP).

Located at the front of the property is a suitable driveway for one/two vehicles. There is also a mature hedge at the front of the property providing privacy. The rear garden also benefits from being secluded and private as well with glimpses of Kit Hill in the distance.





Garden Room
14'09 x 8'11 (4.50m x 2.72m)

Living Room
12'11 x 10'05 (3.94m x 3.18m)

Dining Room
10'07 x 6'10 (3.23m x 2.08m)

Kitchen
9'06 x 7'05 (2.90m x 2.26m)

Utility
4'09 x 3'11 (1.45m x 1.19m)

Bedroom 1
12'11 x 8'08 (3.94m x 2.64m)

Bedroom 2
10'09 x 8'11 (3.28m x 2.72m)

Bathroom
6'07 x 6'04 (2.01m x 1.93m)

Garage
15'41 x 8'46 (4.57m x 2.44m)

Outbuilding 1
11'10 x 11'02 (3.61m x 3.40m)

Outbuilding 2
8'08 x 8'07 (2.64m x 2.62m)

Tenure
Freehold

Services
Mains gas, electricity water and drainage.

Council Tax Band
C

EPC
D/67

Situation
Bere Alston is a village in West Devon which has a regular bus service to Tavistock and also boasts many amenities including a primary school, post office butchers, Co-Op, public house, doctor's surgery and a train station which links the village to Plymouth. The Bere Peninsula is located between the Ocean City of Plymouth and the Ancient Stannary Town of Tavistock.

Directions
Enter Bere Alston on the B3257 (Bedford Street). Then turn right onto Whitehall Drive. At the end of the road turn left onto Broad Park Road then take the next left onto West View and the property will be located immediately on your left.

Floor Plan

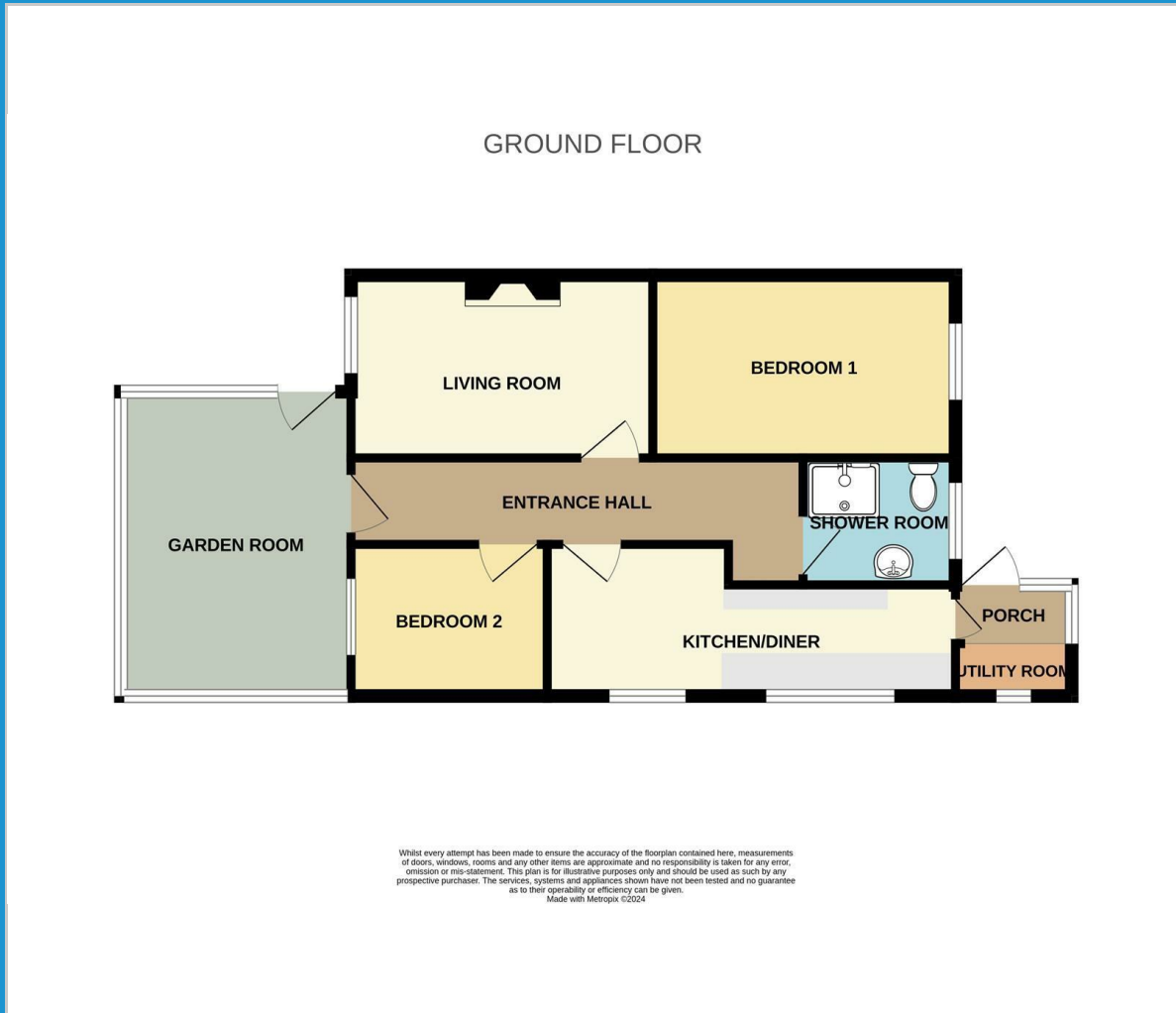

Viewing

Please contact our View Property Tavistock Office on 01822 614614 if you wish to arrange a viewing appointment for this property or require further information.

These particulars, whilst believed to be accurate are set out as a general outline only for guidance and do not constitute any part of an offer or contract. Intending purchasers should not rely on them as statements of representation of fact, but must satisfy themselves by inspection or otherwise as to their accuracy. No person in this firm's employment has the authority to make or give any representation or warranty in respect of the property.

Unit 1, The Old Dairy Paddons Row, Tavistock, Devon, PL19 0HF
Tel: 01822 614614 Email: Tavy@viewproperty.org.uk www.viewproperty.org.uk

Area Map



Energy Efficiency Graph

