



76 Clover Grove

, Leek, ST13 7AS

£695 Per month



CALL US TO ARRANGE A VIEWING 9AM UNTIL 9PM 7 DAYS A WEEK!

Located on a lovely and well-kept estate in Leekbrook, this modern top floor apartment offers stylish living in a convenient location.

The property features a bright open-plan kitchen and living area, ideal for both relaxing and entertaining. There are two bedrooms – one spacious double and one single – making it perfect for couples, small families, or professionals. The modern bathroom includes an electric overhead shower, and there's also a handy storage cupboard for added practicality.

With its contemporary finish and desirable setting, this apartment is a fantastic opportunity for anyone seeking comfortable, modern living in a sought-after area.



Denise White Estate Agent Comments

Available TO LET and the perfect place to call home is this modern two bedroom apartment, tucked away on a lovely modern estate in Leekbrook, on the edge of the market town of Leek in Staffordshire.

Inside, you'll find a bright and welcoming open-plan kitchen and living area. There are two bedrooms: a comfortable double, plus a spacious single that could also work well as a home office or guest room. The bathroom comes with an electric overhead shower, and there's a useful storage cupboard to help keep everything neat and tidy.

With its modern finish and peaceful setting, this apartment offers easy, comfortable living in a friendly neighbourhood – ideal for anyone looking for a fresh start in a great location.

Location

Situated in a most popular residential area within easy travelling distance to Cheshire and Stoke On Trent and within comfortable travelling distance to Manchester. The location of the property offers the advantage of semi-rural living situated within some beautiful surrounding countryside yet being close to the historic market town of Leek.

Open Plan Living Area 14'8" x 12'9" (4.49 x 3.90)

Living area: Carpet floor covering, radiator, uPVC window, light fitting
Kitchen area: Vinyl floor covering, above and below units, stainless steel sink and drainer with mixer tap, integrated electric oven, hob and extractor with stainless steel splash back, uPVC window, light fitting

Bathroom 5'1" x 6'2" (1.56 x 1.90)

Carpet floor covering, WC, Wash hand basin, bath with electric over head shower and glass screen, towel rail and on wall cabinet

Bedroom One 8'5" x 10'10" (2.59 x 3.31)

Carpet floor covering, radiator, uPVC window, light fitting

Bedroom Two 8'11" x 6'4" (2.73 x 1.94)

Carpet floor covering, radiator, uPVC window, light fitting

Security Deposit

Is typically equal to five weeks' rent but may vary. This will be held by a registered deposit scheme (Deposit Protection Service DPS) and shall be returned at the end of the tenancy (subject to any deductions if applicable). Please note no interest is paid on the deposit. In this case the deposit would be £801.00

Holding Deposit

Once your application has been accepted by the landlord, 1 weeks rent holding deposit is required to reserve this property which is deducted off your rent when the tenancy starts. For this property this equates to £160.00

About Your Agent

Denise is the director of Denise White Estate agents and has worked in the local area since 1999. Denise and all the team can help and advise with any information on the local property market and the local area.

Denise White Estate Agents deal with all aspects of property including residential sales and lettings.

Please do get in touch with us if you need any help or advice.

We Won!!

Local Estate Agent Wins Prestigious British Gold Award for Customer Service

Denise White Bespoke Estate Agents has been honoured with the esteemed Gold Award 2025 from the British Property Awards for their exceptional customer service and extensive local marketing knowledge in Leek and its surrounding areas.

The British Property Awards, renowned for their inclusivity and comprehensive evaluation process, assess estate agents across the United Kingdom based on their customer service levels and understanding of the local market. Denise White Estate Agents demonstrated outstanding performance throughout the rigorous and independent judging period.

As part of the assessment, the British Property Awards mystery shopped 90% of estate agents nationwide, evaluating their telephone etiquette, responsiveness to emails, promptness in returning missed calls, and, crucially, their expertise in the local marketing area.

The Gold Award is a testament to the estate agents who consistently go above and beyond, delivering exceptional levels of customer service, focusing on their commitment and excellence within the local community.

Area Map



Floor Plans

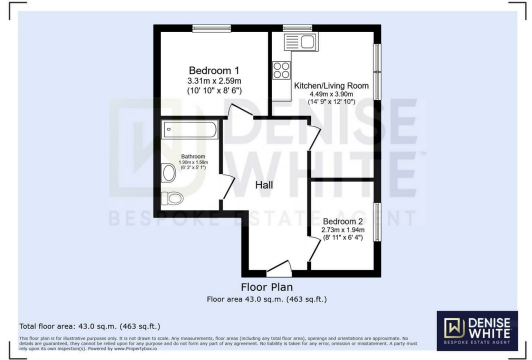

Energy Efficiency Graph

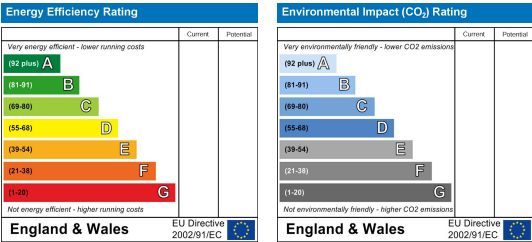

These particulars, whilst believed to be accurate are set out as a general outline only for guidance and do not constitute any part of an offer or contract. Intending purchasers should not rely on them as statements of representation of fact, but must satisfy themselves by inspection or otherwise as to their accuracy. No person in this firms employment has the authority to make or give any representation or warranty in respect of the property.