



48 St. Rualds Close

, Wallingford, OX10 0XE

Guide price £325,000



A very well presented 2 bedroom terraced house situated in a quiet cul de sac with close proximity to town centre



Description

Entry porch opens to the good-sized living room, off the living room is the light kitchen / dining room with built in oven, hob and extractor, ample worktop and storage space and outlook to the rear garden.

Upstairs to landing with storage
Double bedroom to the front of the property with built in storage
Double bedroom to the rear of the property Bathroom with shower over bath, basin and WC

Outside to
Garden
Allocated parking

Wallingford town centre is also within a 0.4 mile walk with its popular marketplace and local shops, café's, bars and restaurants along with Waitrose and nearby Lidl.
Wallingford is located within easy access to the M4, M40 and A34, Harwell campus and mainline stations can be found at nearby Cholsey and Didcot.

Area Map



Floor Plans

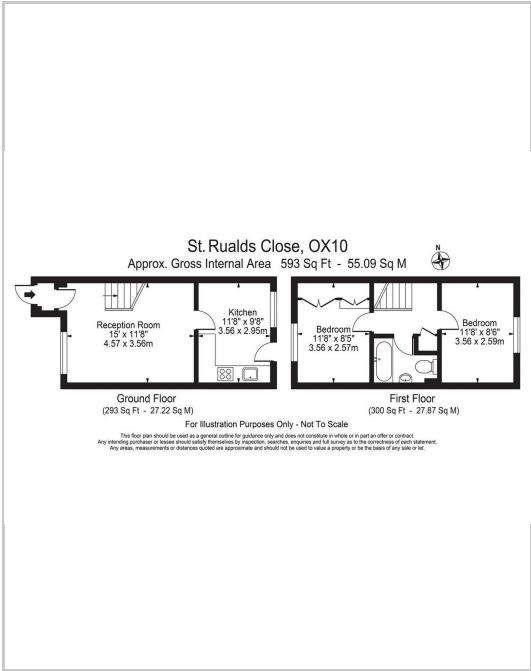

Energy Efficiency Graph

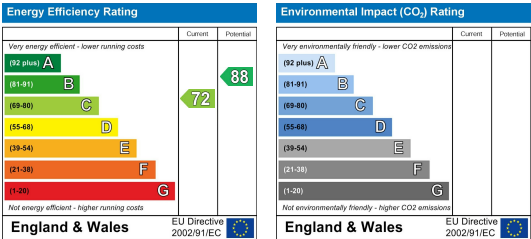

These particulars, whilst believed to be accurate are set out as a general outline only for guidance and do not constitute any part of an offer or contract. Intending purchasers should not rely on them as statements of representation of fact, but must satisfy themselves by inspection or otherwise as to their accuracy. No person in this firms employment has the authority to make or give any representation or warranty in respect of the property.