



22 Walter Bigg Way

, Wallingford, OX10 8FA

Guide price £240,000



A well presented light and spacious 2 bedroom top floor apartment with parking & garage, situated in a sought after location within a short walk to Wallingford Town centre.



Description

A well presented light and spacious 2 bedroom top floor apartment with parking & garage in a sought after location within a short walk to Wallingford Town centre.

Communal entry hall with stairs leading to apartment entrance which opens to the reception hall with storage cupboard with hot water tank.

Off the hall is the light and spacious living / dining room with and outlook over the communal areas, fitted kitchen, electric oven and hob.

Bedroom one 4.2m x 3.3m with built in storage and en suite shower room

Bedroom two 5.1m x 2.9m

Family bathroom with shower over bath, WC and basin

This light and spacious apartment offers a very good amount of space at excellent value with the benefit of being a short walk to town centre

NOTE: Archive photos used for marketing.
Currently tenant in situ £1150pcm

Wallingford town centre is also within a walking distance with its popular market place and local shops, café's, bars and restaurants along with Waitrose and nearby Lidl. Wallingford is located within easy access to the M4, M40 and A34, Harwell campus and mainline stations can be found at nearby Cholsey and Didcot.

Area Map

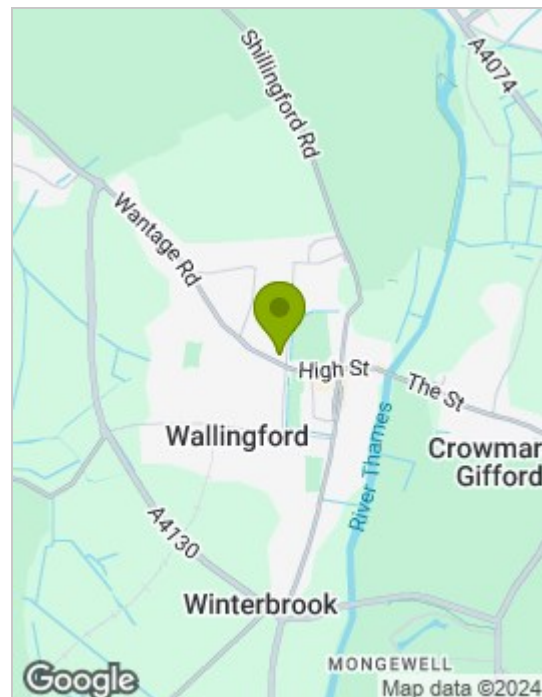

Floor Plans

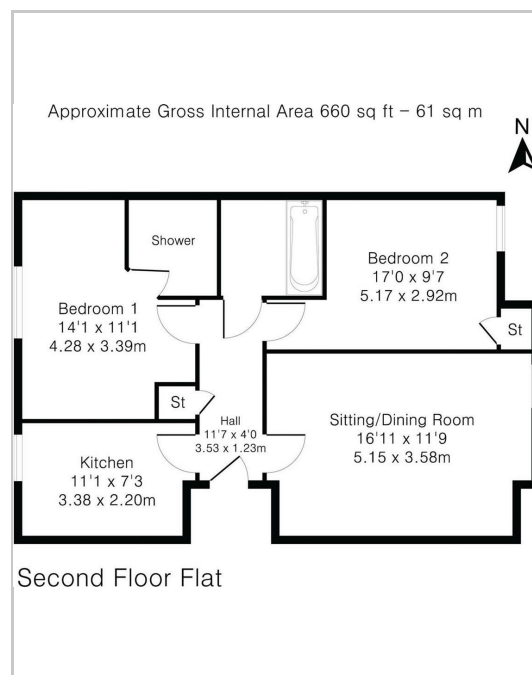

Energy Efficiency Graph

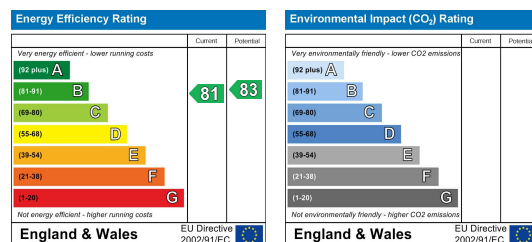

These particulars, whilst believed to be accurate are set out as a general outline only for guidance and do not constitute any part of an offer or contract. Intending purchasers should not rely on them as statements of representation of fact, but must satisfy themselves by inspection or otherwise as to their accuracy. No person in this firm's employment has the authority to make or give any representation or warranty in respect of the property.