



## Foxfields, Stoke-on-Trent

£1,205 PCM

Explore Foxfields, a community of new 2, 3 & 4 bedroom homes on the outskirts of Stoke-on-Trent where there is something for everyone.

Perfect for modern life, the three-bedroom Danbury has a stylish open plan kitchen/dining room with garden access and a spacious front-aspect living room that's ideal for entertaining.

Upstairs there are three bedrooms, with an en-suite to the master, a family-sized bathroom and two handy storage cupboards.

Benefiting from excellent regional access, Stoke-on-Trent train station easily links you to Liverpool, Manchester & Birmingham.

You'll have plenty of supermarkets, retail stores, pubs, restaurants, cafes, parks & leisure activities at your fingertips whilst living at this development.

For family moments, the picturesque Peak District National Park is within reach, whilst the thrill of Alton Towers is less than 10 miles away.

Deposit: £1390  
Tenancy Length: 12 Months  
Council Tax Band: TBC  
Available Now





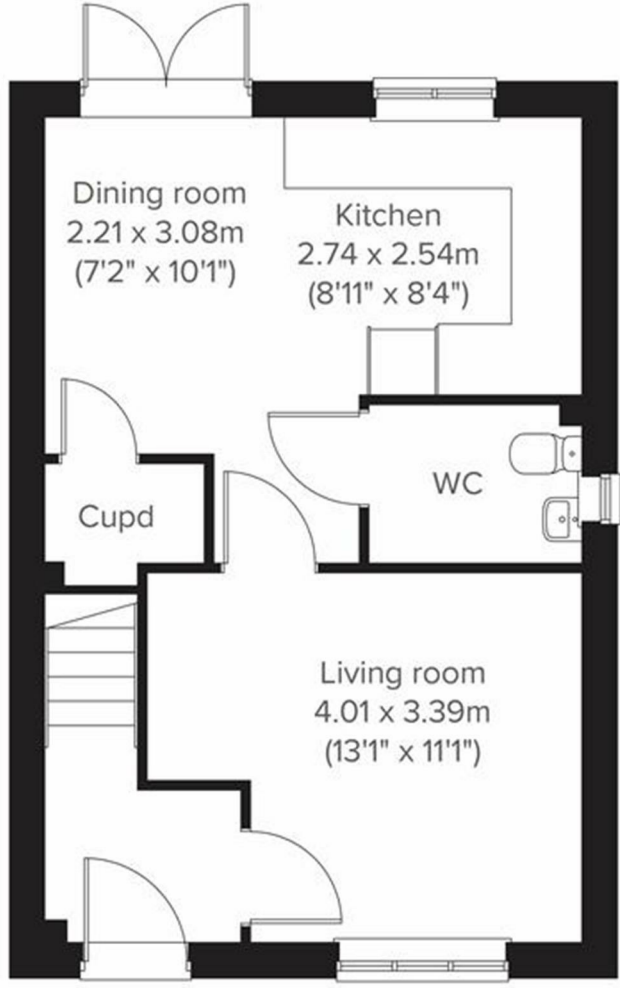

Energy Efficiency Rating		Environmental Impact (CO <sub>2</sub> ) Rating	
Current	Potential	Current	Potential
84	96	B	B
82-83	94-95	C	C
79-81	91-93	D	D
74-78	87-90	E	E
69-73	83-86	F	F
64-68	79-82	G	G