



Foxfields, Stoke-on-Trent

£1,095 PCM

Explore Foxfields – a vibrant new community featuring a collection of 2, 3, and 4-bedroom homes located on the outskirts of Stoke-on-Trent. Offering something for everyone, these homes are perfectly designed for modern living.

The three-bedroom Danbury is ideal for family life, featuring a stylish open-plan kitchen/dining room with garden access, and a spacious front-aspect living room, perfect for hosting guests. Upstairs, you'll find three well-sized bedrooms, including a master with en-suite, a family bathroom, and two practical storage cupboards.

With excellent regional transport links, Stoke-on-Trent train station offers easy connections to major cities such as Liverpool, Manchester, and Birmingham.

Foxfields also puts a variety of conveniences at your fingertips, including supermarkets, retail stores, pubs, restaurants, and cafes, as well as parks and leisure facilities.

For outdoor adventures and family moments, the stunning Peak District National Park is within reach, while Alton Towers, one of the UK's premier theme parks, is less than 10 miles away.

Deposit: £1260

Tenancy Length: 12 Months

Council Tax Band: TBC

Available in September



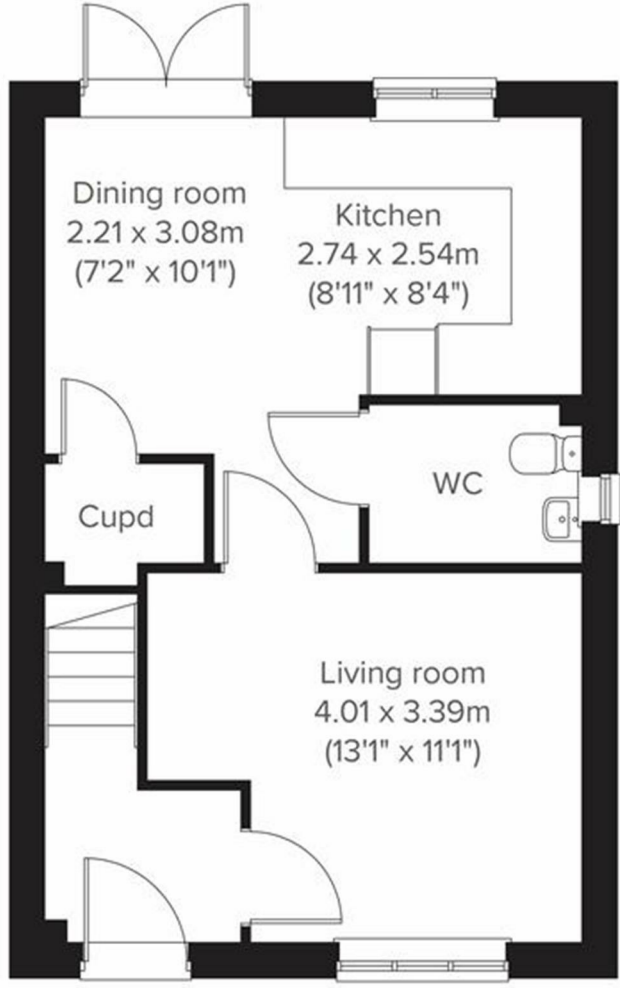

Energy Efficiency Rating		Environmental Impact (CO ₂) Rating	
Current	Potential	Current	Potential
 84	96	 B	C