



Sundowner Grove, Tipton, DY4

£1,425 Per Month

Discover the charm of Coseley New Village, a welcoming community nestled between Wolverhampton, Dudley, and Wednesbury. Positioned within the wider West Midlands metropolitan area, with easy access to Birmingham, this development offers a range of modern houses to rent, catering to growing families, young professionals, and downsizers alike.

The local neighbourhood and close-by big city provide a diverse array of amenities, from convenient nearby supermarkets to a wide selection of high street stores within Birmingham City Centre, as well as dining options and a lively nightlife all within easy reach. Additionally, for those seeking a peaceful retreat, the scenic Shropshire countryside is just a short distance to the west. Embrace the perfect blend of urban and rural living in this delightful community.

The Windermere is a flexible three bedroom home that adapts effortlessly to your lifestyle. For growing families, the second floor offers a master bedroom with a private ensuite bathroom, ensuring comfort and space. Alternatively, for young professionals, you'll appreciate the option to have a guest bedroom and bathroom as well as a home office. Embrace the functionality of this new home that caters to various needs, providing a space that truly works for you.

Deposit £1640
Unfurnished
Council Tax TBA
Available Now



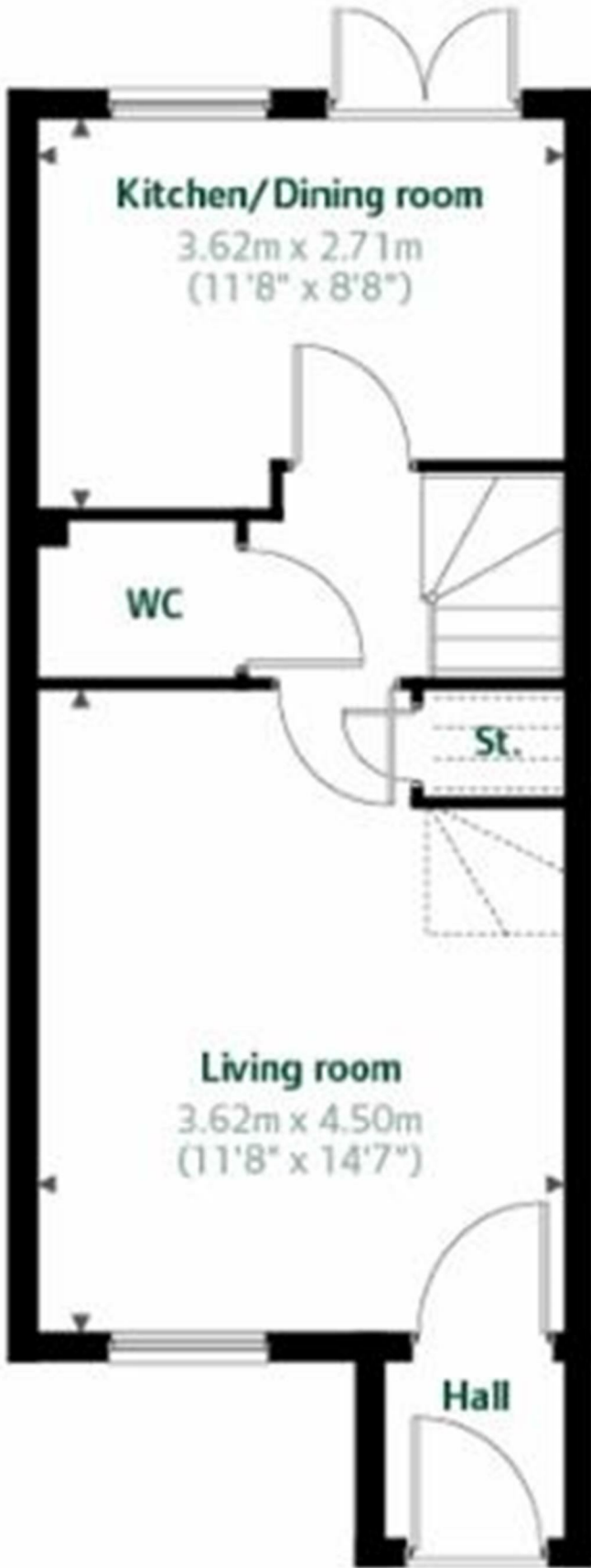

Energy Efficiency Rating		Environmental Impact (CO ₂) Rating	
Current	Potential	Current	Potential
85	97	B	B
92-100 A 85-91 B 79-84 C 73-78 D 67-72 E 61-66 F 55-60 G		100-120 A 80-99 B 60-79 C 40-59 D 20-39 E 10-19 F 0-9 G	
92-100 A 85-91 B 79-84 C 73-78 D 67-72 E 61-66 F 55-60 G		100-120 A 80-99 B 60-79 C 40-59 D 20-39 E 10-19 F 0-9 G	