



Brookfields Place, Coventry

£1,375 PCM

Welcome to Whitmore Place, a development offering homes to rent in the sought-after residential neighbourhood of Holbrooks, just 2.5 miles north of Coventry city centre. Embrace picturesque green open spaces within walking distance, a variety of nearby schools, and an array of shops and facilities within a couple of miles.

Additionally, the proximity to Birmingham, Nuneaton, Rugby, and Royal Leamington Spa, coupled with an excellent road network including the M6, M40, and M42, ensures easy access to surrounding areas - making Whitmore Place an ideal choice to put down roots!

Step into The Glenmore, a captivating detached property where style seamlessly meets practicality. This home boasts an integral garage, a generously sized living room, and a bright open-plan kitchen/dining room—an ideal space for both family life and entertaining. Prioritizing practicality, the residence includes a utility room, downstairs WC, and four storage cupboards.

The allure extends to the upper floor, where the large master bedroom awaits with its en suite bathroom. This space is complemented by a spacious landing leading to two additional bedrooms and the main family bathroom.

This property is located close to building works and has been priced accordingly due to some disruption.

Deposit: £1,580
Tenancy Length: 12 Months
Council Tax Band: TBC
Available 16th July 2024



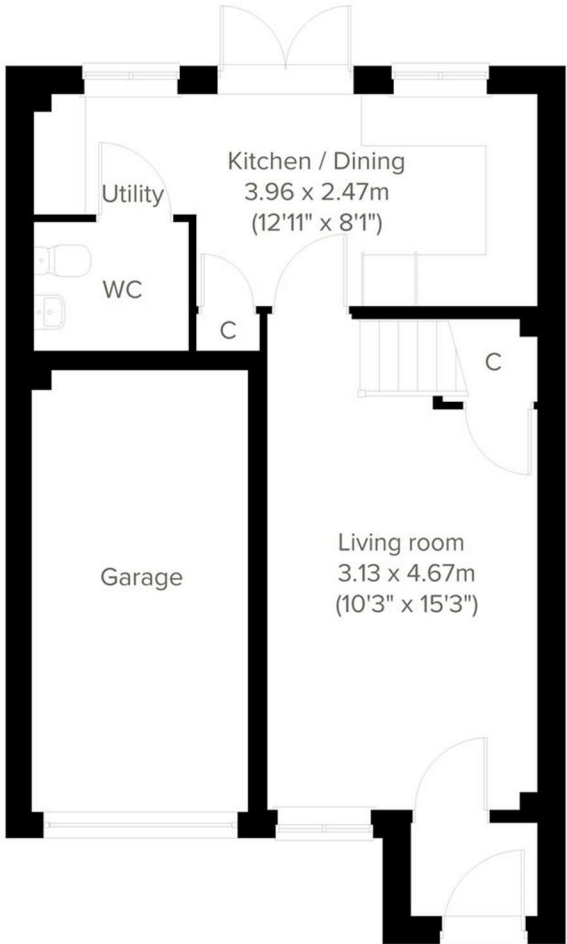

| Energy Efficiency Rating | | Environmental Impact (CO ₂) Rating | |
|--------------------------|-----------|--|-----------|
| Current | Potential | Current | Potential |
| 83 | 95 | B | C |