



Foxfields, Stoke-on-Trent

£1,095 PCM

Bring your family PET to this NEW community and we will welcome your FURRY FRIEND into this specifically selected PET FRIENDLY home.

Are you searching for a house you can be proud to call home?

For family moments, the picturesque Peak District National Park is within reach, whilst the thrill of Alton Towers is less than 10 miles away. You'll have plenty of supermarkets, retail stores, pubs, restaurants, cafes, parks & leisure activities at your fingertips whilst living at this development.

Benefitting from excellent regional access, Stoke-on-Trent train station easily links you to Liverpool, Manchester & Birmingham.

Perfect for modern life, the three-bedroom Danbury has a stylish open plan kitchen/dining room with garden access and a spacious front-aspect living room that's ideal for entertaining.

Upstairs there are three bedrooms, with an en-suite to the master, a family-sized bathroom and two handy storage cupboards.

Benefitting from excellent regional access, Stoke-on-Trent train station easily links you to Liverpool, Manchester & Birmingham.

You'll have plenty of supermarkets, retail stores, pubs, restaurants, cafes, parks & leisure activities at your fingertips whilst living at this development.

For family moments, the picturesque Peak District National Park is within reach, whilst the thrill of Alton Towers is less than 10 miles away.



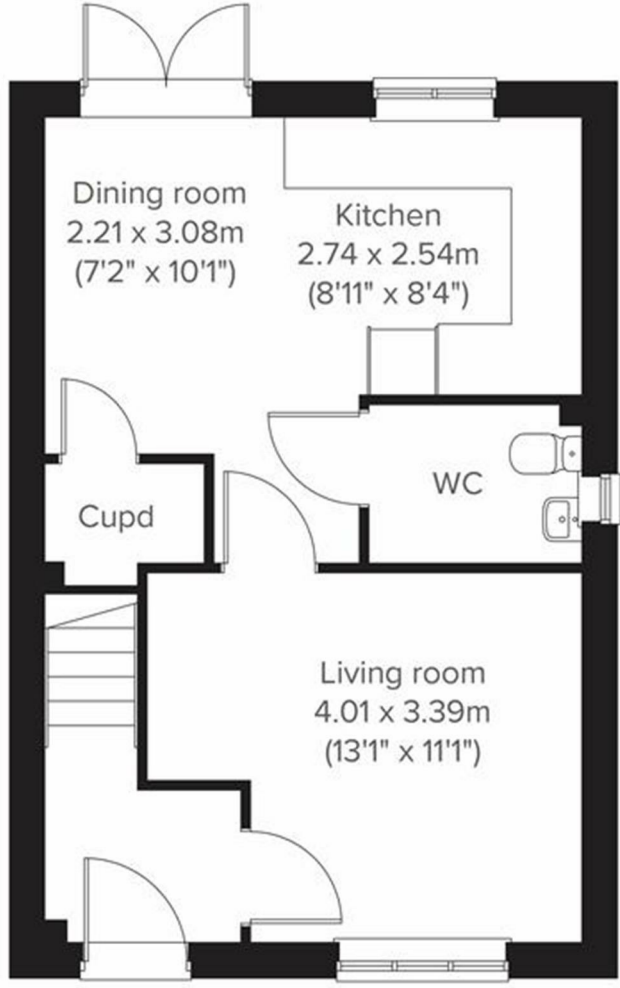

Energy Efficiency Rating		Environmental Impact (CO ₂) Rating	
Current	Potential	Current	Potential
96	96	B	B
84	96	B	B
72	96	C	B
60	96	C	B
48	96	D	B
36	96	D	B
24	96	E	B
12	96	F	B
0	96	F	B