



## Foxfields, Stoke-on-Trent

£1,295 PCM

Bring your family PET to this NEW community and we will welcome your FURRY FRIEND into this specifically selected PET FRIENDLY home.

Are you searching for a house you can be proud to call home?

For family moments, the picturesque Peak District National Park is within reach, whilst the thrill of Alton Towers is less than 10 miles away. You'll have plenty of supermarkets, retail stores, pubs, restaurants, cafes, parks & leisure activities at your fingertips whilst living at this development.

Benefitting from excellent regional access, Stoke-on-Trent train station easily links you to Liverpool, Manchester & Birmingham.

Enjoy the best of modern living in this popular three-bedroom home which benefits from a stylish open-plan kitchen/diner with French doors leading into the garden.

The Hatfield's bright front-aspect living room, separate utility room, handy storage cupboard and downstairs WC complete the ground floor.

Upstairs, bedroom one has an en suite and there's a good-sized family bathroom and further storage.

Deposit £1490  
Unfurnished  
Council Tax TBA  
Available Now

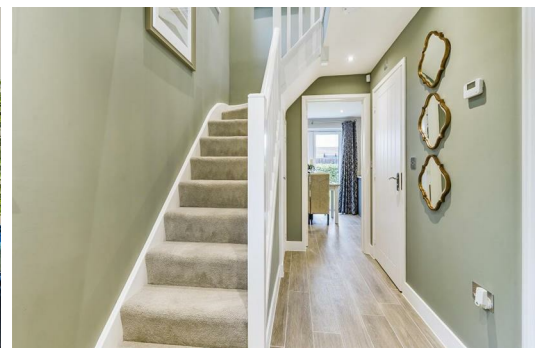

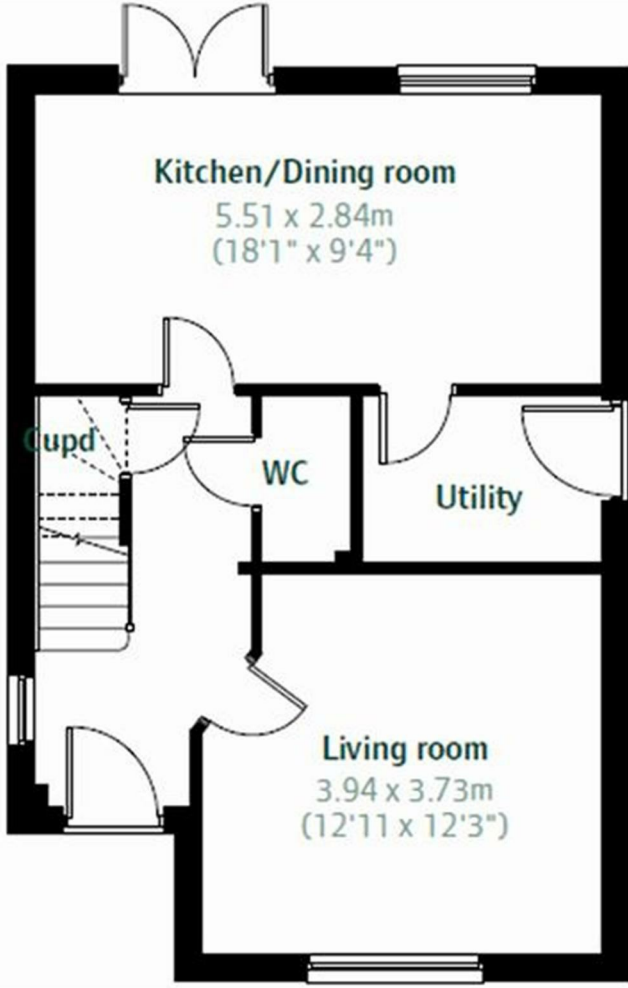

Energy Efficiency Rating		Environmental Impact (CO <sub>2</sub> ) Rating	
Current	Potential	Current	Potential
93 (D)	95 (C)	35 (D)	35 (D)
83 (E)	83 (E)	35 (D)	35 (D)
73 (F)	73 (F)	35 (D)	35 (D)
63 (G)	63 (G)	35 (D)	35 (D)
53 (G)	53 (G)	35 (D)	35 (D)
43 (G)	43 (G)	35 (D)	35 (D)
33 (G)	33 (G)	35 (D)	35 (D)
23 (G)	23 (G)	35 (D)	35 (D)
13 (G)	13 (G)	35 (D)	35 (D)
3 (G)	3 (G)	35 (D)	35 (D)