



Foxfields, Stoke-on-Trent

£1,325 PCM

Bring your family PET to this NEW community and we will welcome your FURRY FRIEND into this specifically selected PET FRIENDLY home.

Are you searching for a house you can be proud to call home?

For family moments, the picturesque Peak District National Park is within reach, whilst the thrill of Alton Towers is less than 10 miles away. You'll have plenty of supermarkets, retail stores, pubs, restaurants, cafes, parks & leisure activities at your fingertips whilst living at this development.

Benefitting from excellent regional access, Stoke-on-Trent train station easily links you to Liverpool, Manchester & Birmingham.

The Clayton is a modern three-storey home ideal for family life, featuring an open plan kitchen/dining room, a bright living room with French doors leading into the garden, a handy utility room, plus under-stairs storage and a WC. Upstairs, there are three bedrooms with an en-suite to the master, as well as a main family bathroom and additional storage cupboard. The property's modern bathroom features elegant fixtures and finishes, providing a spa-like atmosphere and a bath for unwinding after a long day.

Outside, the private garden offers a tranquil escape, ideal for enjoying al fresco dining or simply soaking up the sunshine.

Deposit £1520
Unfurnished
Council Tax TBA
Available 14th June 2024



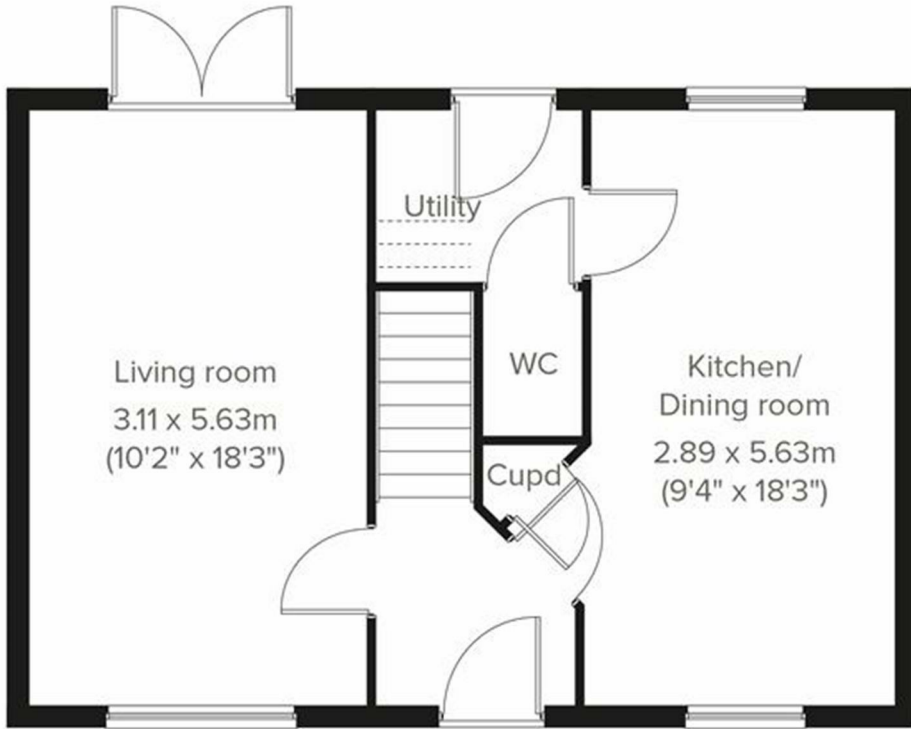

Energy Efficiency Rating		Environmental Impact (CO ₂) Rating	
Current	Potential	Current	Potential
<p>95</p>	<p>84</p>	<p>A</p>	<p>B</p>