



## 17 Clovelly Road, Bexleyheath, DA7 5RG

Guide Price £400,000 - £425,000

Jack Charles are delighted to offer for sale this three bedroom, terraced house situated in a convenient location ideal for schools and close by to Abbey Wood station with access for the Elizabeth Line. It is being offered with NO forward chain. This home is a perfect first time purchase or an ideal investment opportunity as it has been let. Internally there is a hallway, sitting room and a large reception room which opens out into the dining room at the rear which is also open plan with a good sized kitchen. To the first floor there are three bedrooms and a family bathroom. Outside the property has a driveway to front with parking for 2 cars and to the rear is a lawned garden and a large outbuilding formally a garage.

Viewings are recommended.

### Viewing

Please contact our Jack Charles Tonbridge Office on 01732 75 75 80 if you wish to arrange a viewing appointment for this property or require further information.

- Terraced House
- Three Bedrooms
- Large Reception Room
- L Shaped Kitchen / Dining Room
- First Floor Bathroom
- Garden
- Parking
- Large Outbuilding
- Close To Abbey Wood Station

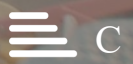

## Floor Plan

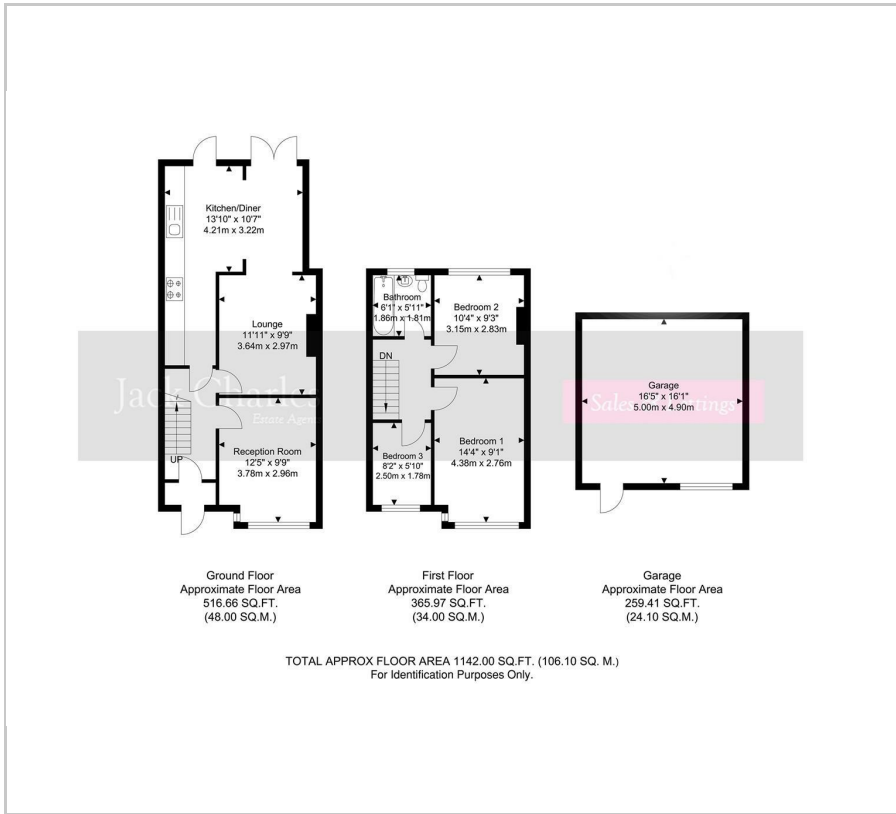

## Area Map

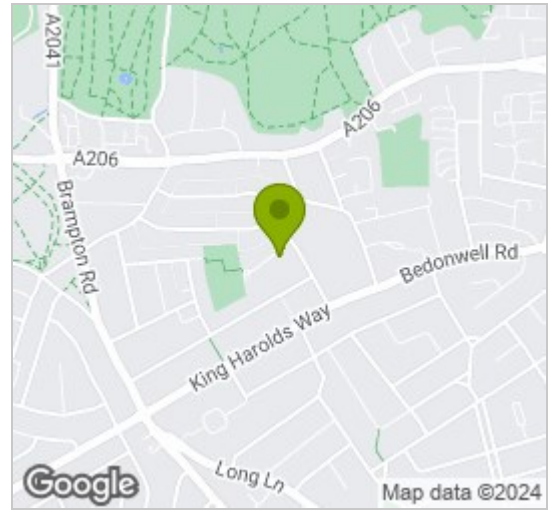

## Energy Efficiency Graph

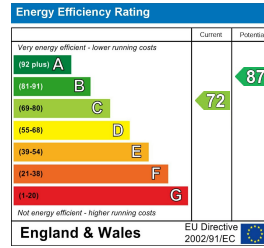

These particulars, whilst believed to be accurate are set out as a general outline only for guidance and do not constitute any part of an offer or contract. Intending purchasers should not rely on them as statements of representation of fact, but must satisfy themselves by inspection or otherwise as to their accuracy. No person in this firm's employment has the authority to make or give any representation or warranty in respect of the property.

t: 01732 75 75 80 | e: tonbridge@jackcharles.co.uk | www.jackcharles.co.uk

Registered in England and Wales Company Number: 12336461 | Registered office: Castle Lodge, Castle Street, Tonbridge, TN9 8BA